

Blue Mounds State Park
 Rock County, MN.
 Gravel Survey T103-R45-S25
 Project 334-7
 Contour Interval = 5Ft.



- BH (MNDOT Bore Hole)
- OC (Outcrop Marker)
- GP (DNR Minerals Giddings Hole)
- Study Area
- Outcrop Areas
- Estimate Boundary
- Park Boundary



State of Minnesota DNR Minerals

Copyright 1999 (draft)

Volumetric Estimate of Gravel Resource

Estimate = 2,884,500 Cubic Yards
 Average depth of deposit = 13.6 ft.

Sieve Size	1in.	3/4	3/8	#4	#10	#40	#200
Deposit Gradation (modeled weighted avg.)	92.5	88.8	77.9	65.5	50.8	19.7	5.3

264000

264000

262000

262000

260000

260000

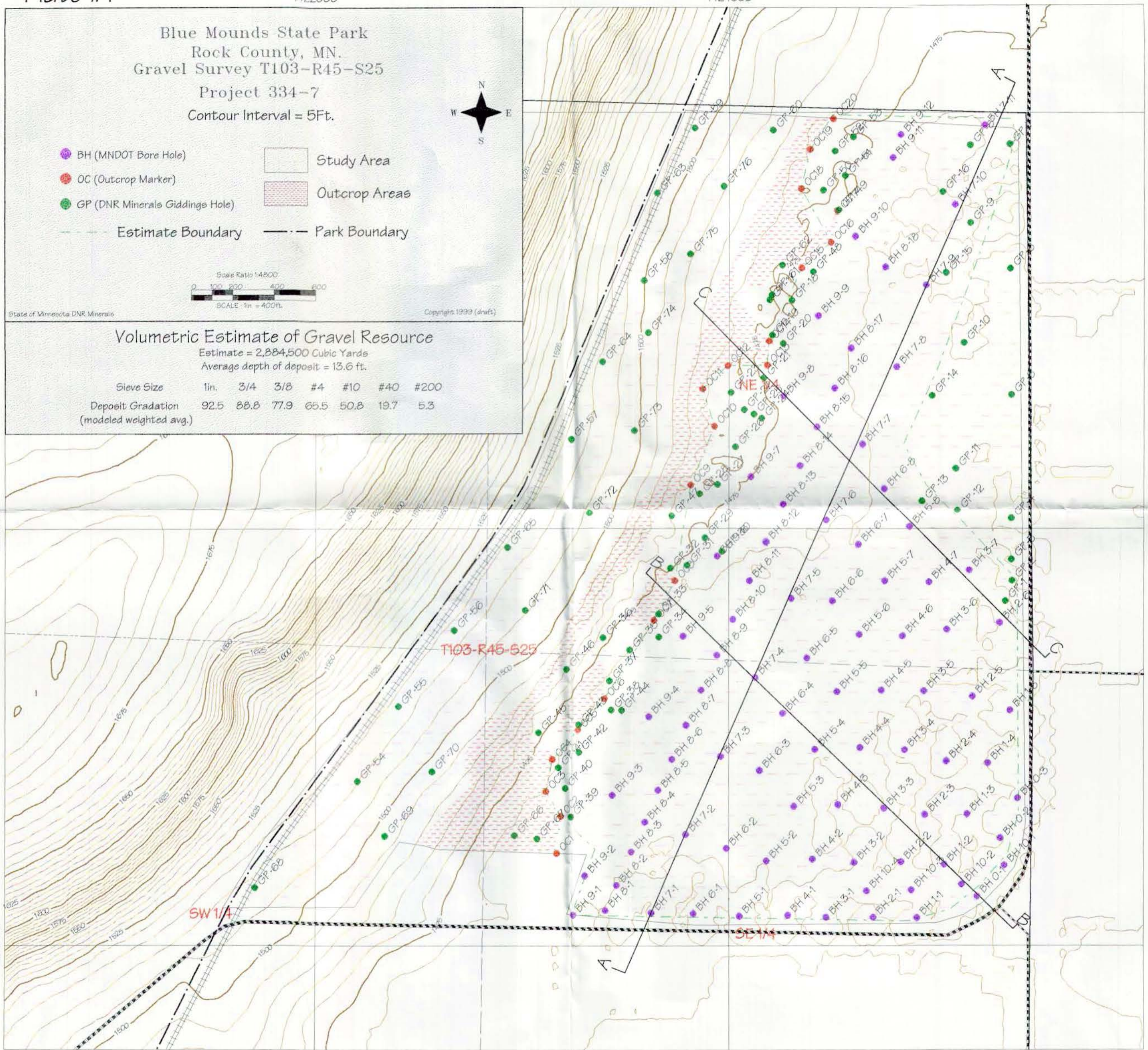

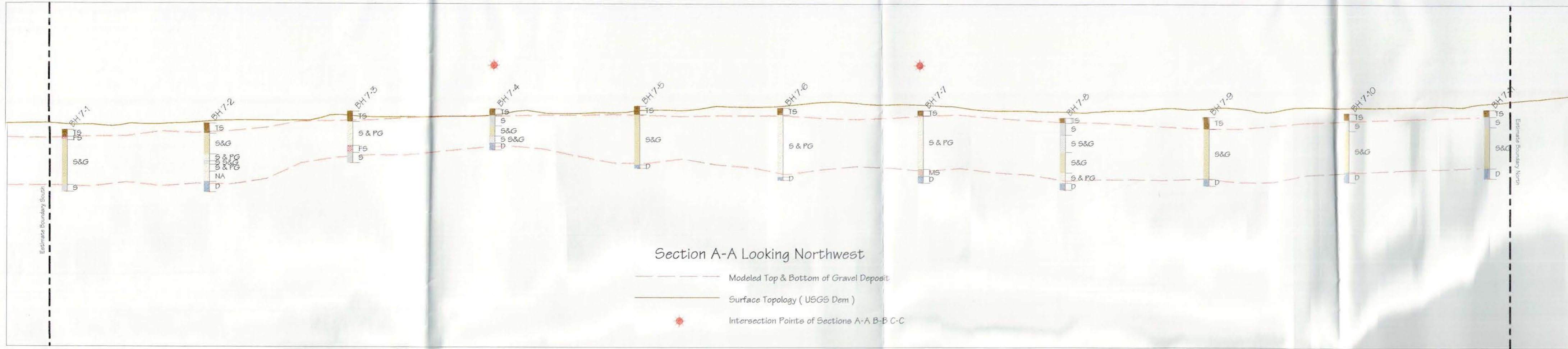

Project 334-7

Bore Hole Legend

- TS = Topsoil
- S = Silt
- S S&G = Silty Sand & Gravel
- S & PG = Sand & Pea Gravel
- S&G = Sand & Gravel
- FS = Fine Sand
- MS = Medium Sand
- D = Diamict

SCALE : Horiz. 1in. = 200ft.
Vert. 1in. = 20ft.

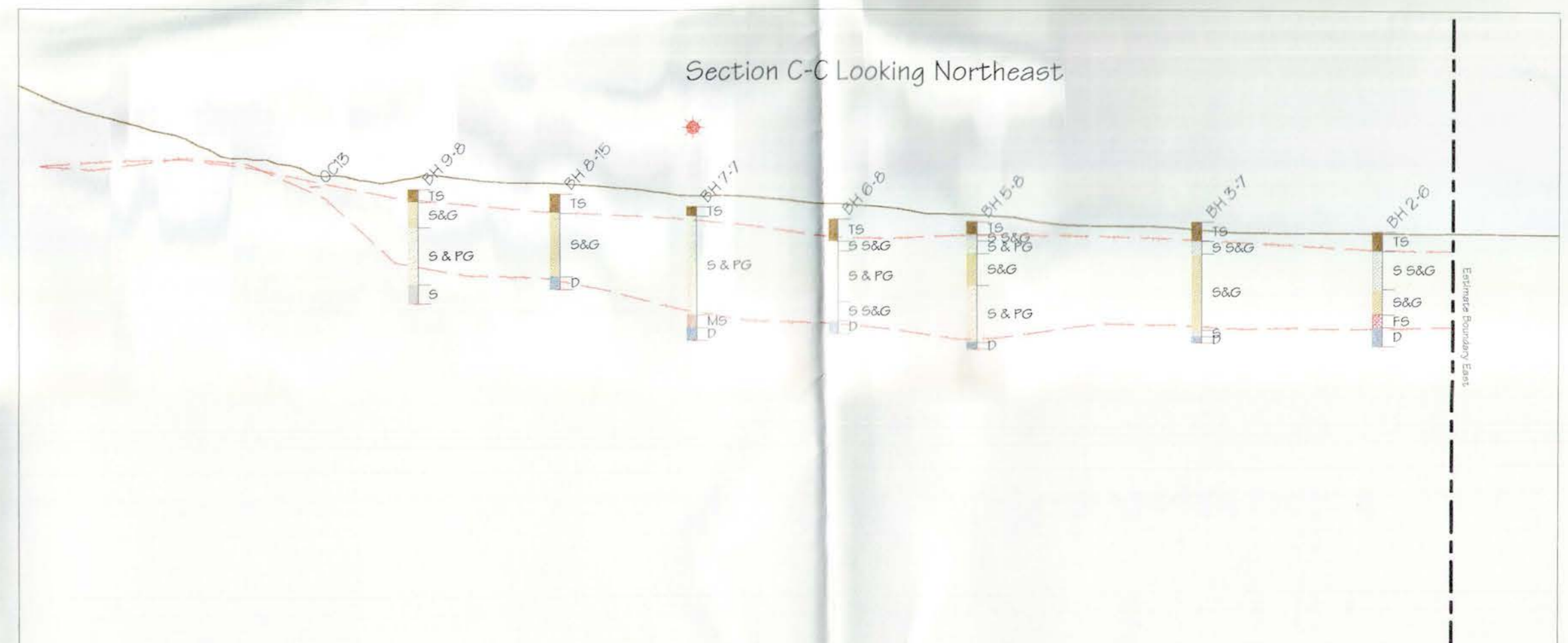
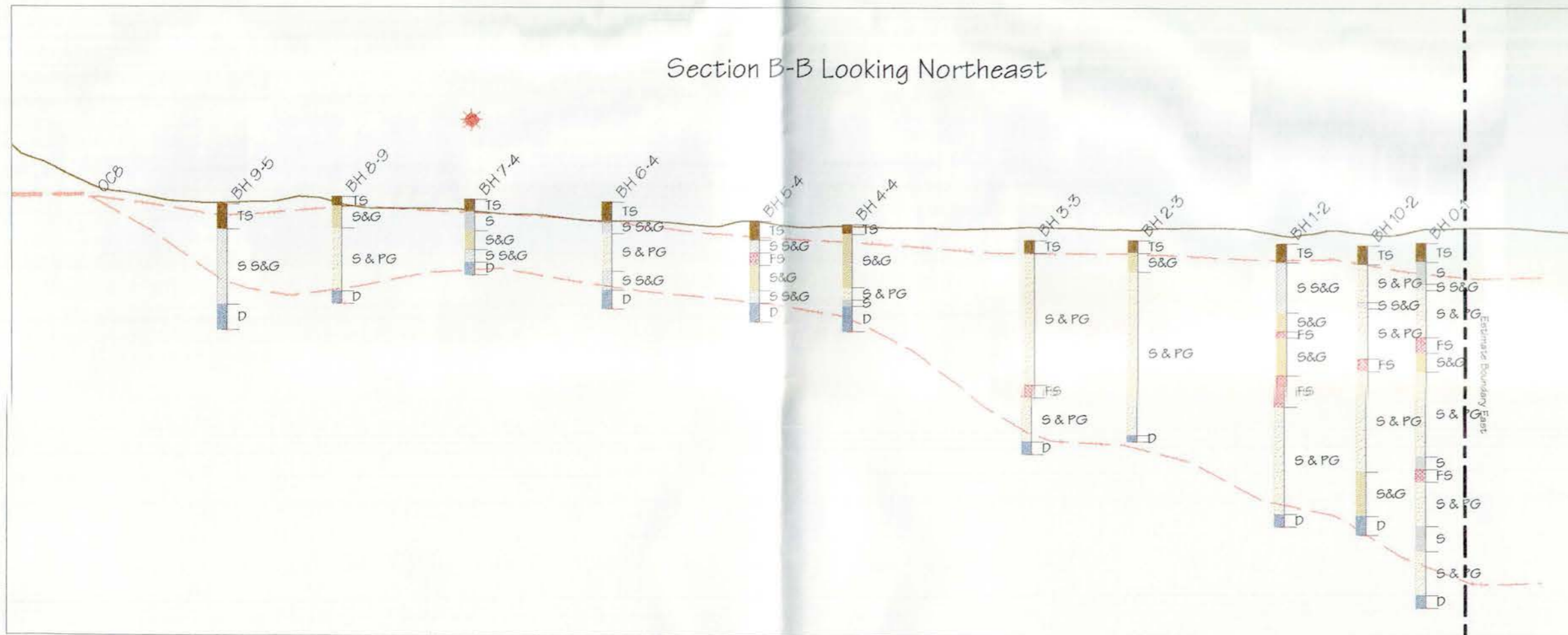

Blue Mounds State Park
 Rock County, MN.
 Gravel Survey T103-R45-S25
 Project 334-7
 Modeled Gravel Deposit

Depth of Gravel in Feet



Study Area Outcrop Areas

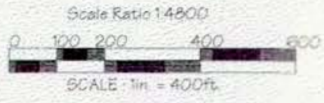

State of Minnesota DNR Minerals

Copyright 1999 (draft)

Volumetric Estimate of Gravel Resource

Estimate = 2,884,500 Cubic Yards
 Average depth of deposit = 13.6 ft.

Sieve Size	1in.	3/4	3/8	#4	#10	#40	#200
Deposit Gradation (modeled weighted avg.)	92.5	88.8	77.9	65.5	50.8	19.7	5.3

264000

264000

262000

262000

260000

260000

