

Borehole	Depth	Elevation	Geological Strata		
N-6	Surface		Surface		
	27	41.77			
	32	34.74			
	37	30.21			
	42	34.12			
	47	39.29			
	52	39.83			
	57		Taconite		
	63	36.65			
	68	33.64			
N-7	Surface		Surface		
	40		Taconite		
	64-6		Broken Taconite		
	53-6		Broken Taconite		
	98-6		Broken Taconite		
	N-8	39		Broken Taconite	
		44	43.31		
		49	34.45		
		54	34.70		
		59	33.89		
64		38.59			
69		27.70			
74			Taconite		
75-6			Taconite		
N-9		Surface		Surface	
	27	41.77			
	32	34.74			
	37	30.21			
	42	34.12			
	47	39.29			
	52	39.83			
	57		Taconite		
	79		Taconite		
	N-10	Surface		Surface	
40			Taconite		
64-6			Broken Taconite		
53-6			Broken Taconite		
98-6			Broken Taconite		
N-11		Surface		Surface	
		80	18.28		
		85	23.36		
		90		Taconite	
		97		Taconite	
	N-12	Surface		Surface	
		62		Taconite	
		91-6		Slate	
		N-15	Surface		Surface
			26		Taconite & Slate
44-6				Taconite & Slate	

N07\_006.TIF

GRANT MINE EXPLORATION  
 S 1/2 & NE-NW 1/4 20-58-19  
 From Interstate Iron Co. B. Print.  
 Scale of Map 1"=300' Holes 1"=40'

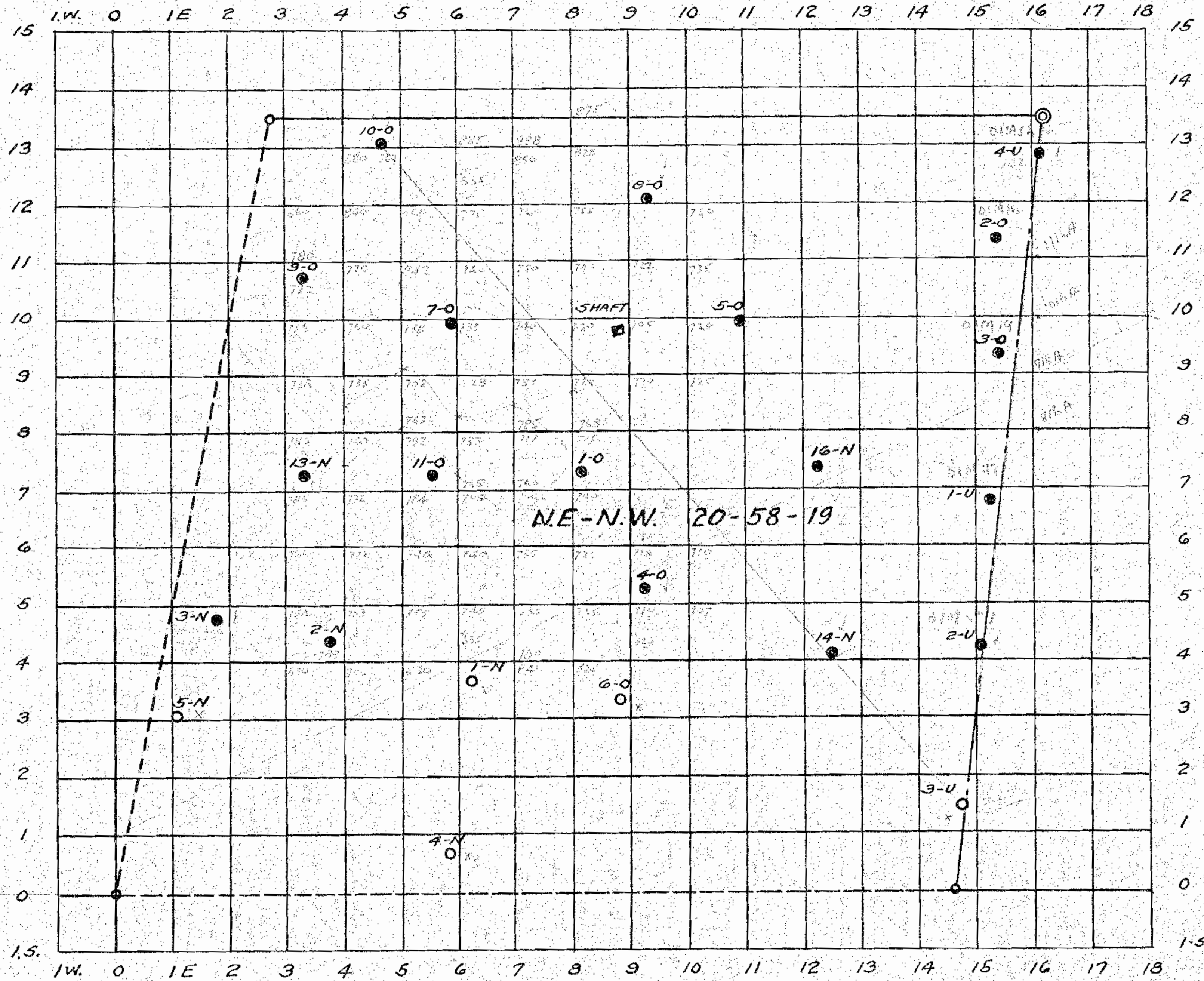

Origin of Coordinates Center 1/16 Corner  
 C 1/16 NW 1/4 0000.00 N 0000.00 E  
 E 1/16 NW 1/4 0000.00 N 1460.47 E  
 N 1/4 Corner 1342.71 N 1619.18 E  
 N 1/16 NW 1/4 1349.80 N 275.87 E  
 Scale of Plat 1" = 200'  
 Scale of Holes 1" = 40'

N07\_007.TIF

Grant Mine  
NE-NW SEC 20-58-19

Drainage Drift Analyses

0				
9	62.30	.093	4.80	.42
18 6"	62.45	.092	5.60	.57
18 3"	60.91	.108	7.80	.88
	60.91	.094	7.72	.68
27 3"	61.83	.132	5.00	.34
31 0"	63.07	.130	5.20	.30
36	62.14	.102	6.20	.76
41	64.30	.093	5.24	.49
46	62.76	.088	5.04	.40
50 7"	63.68	.094	3.90	.53
55 7"	63.53	.103	3.74	.34
60 7"	63.83	.097	2.60	.42
65 7"	65.69	.093	2.62	.34
69 10"	63.68	.101	3.80	.23
74 5"	64.46	.081	3.00	.30
78 5"	64.92	.073	3.06	.38
82 11"	65.38	.068	2.92	.19
88	63.84	.077	5.42	.19
92 6"	64.76	.064	5.02	.13
96 6"	63.84	.069	6.08	.15
100 6"	62.91	.070	7.40	.15
110 6"	62.61	.076	6.40	.11
114 6"	63.07	.065	5.80	.11
119	61.99	.063	7.24	.11
124	62.14	.055	6.78	.15
130	62.61	.053	6.84	.11
136	63.68	.066	6.02	.16
146	59.90	.062	7.54	.27
150	62.81	.061	5.04	.19
154	62.35	.066	5.72	.27
159	61.74	.069	6.34	.23
163	61.74	.077	6.24	.23
167	62.85	.065	6.62	.38
170	61.74	.074	6.10	.34
176	61.74	.082	6.20	.42
180	61.28	.107	5.28	.30
186	61.28	.041	8.00	.34
190	61.43	.083	5.74	.23
196	61.43	.041	8.50	.42
200	60.82	.079	7.50	.54
206	60.97	.067	7.50	.60
210	60.36	.077	7.70	.63
216	61.13	.074	7.16	.60
220	60.06	.066	7.74	.68
226	61.43	.071	5.60	.60
230	61.74	.080	5.90	.42
236	60.82	.080	5.70	.38
240	61.13	.086	6.60	.56
246	59.44	.089	9.74	1.06
250	57.14	.085	11.48	1.06
256	58.98	.084	10.42	.53
260	59.44	.094	10.00	.57
266	45.90	.100	28.74	.53
270	46.82	.097	24.00	1.02
276	44.05	.086	27.38	1.39
280	49.12	.092	23.08	.57
286	46.20	.101	26.42	.49
290	42.97	.083	32.92	.64

DRAINAGE DRIFT DRIVEN SEASON 1920

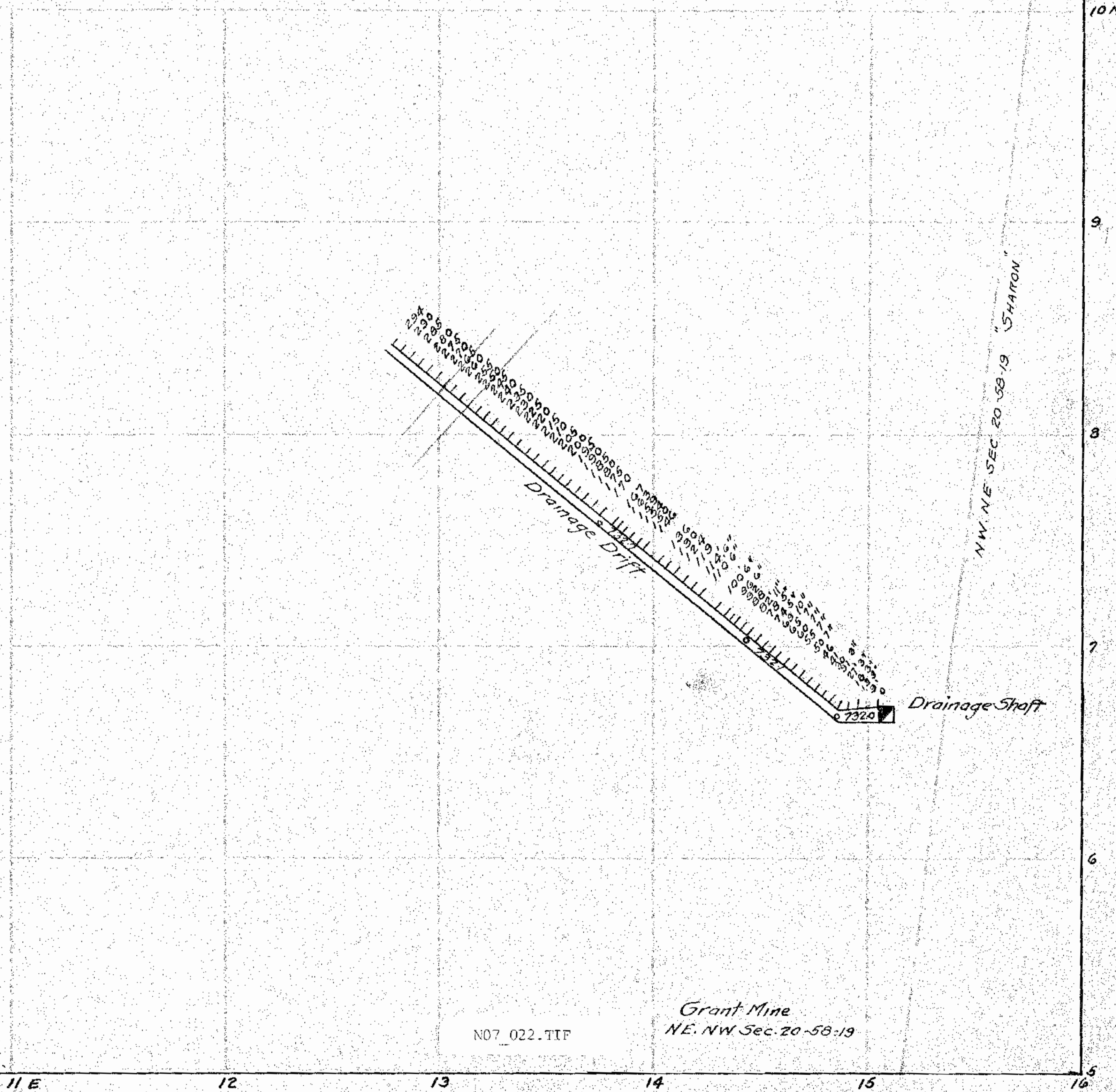

N07\_022.TIF

Grant Mine  
NE. NW. Sec. 20-58-19

GRANT MINE  
NE-NW SEC. - 20-58-19

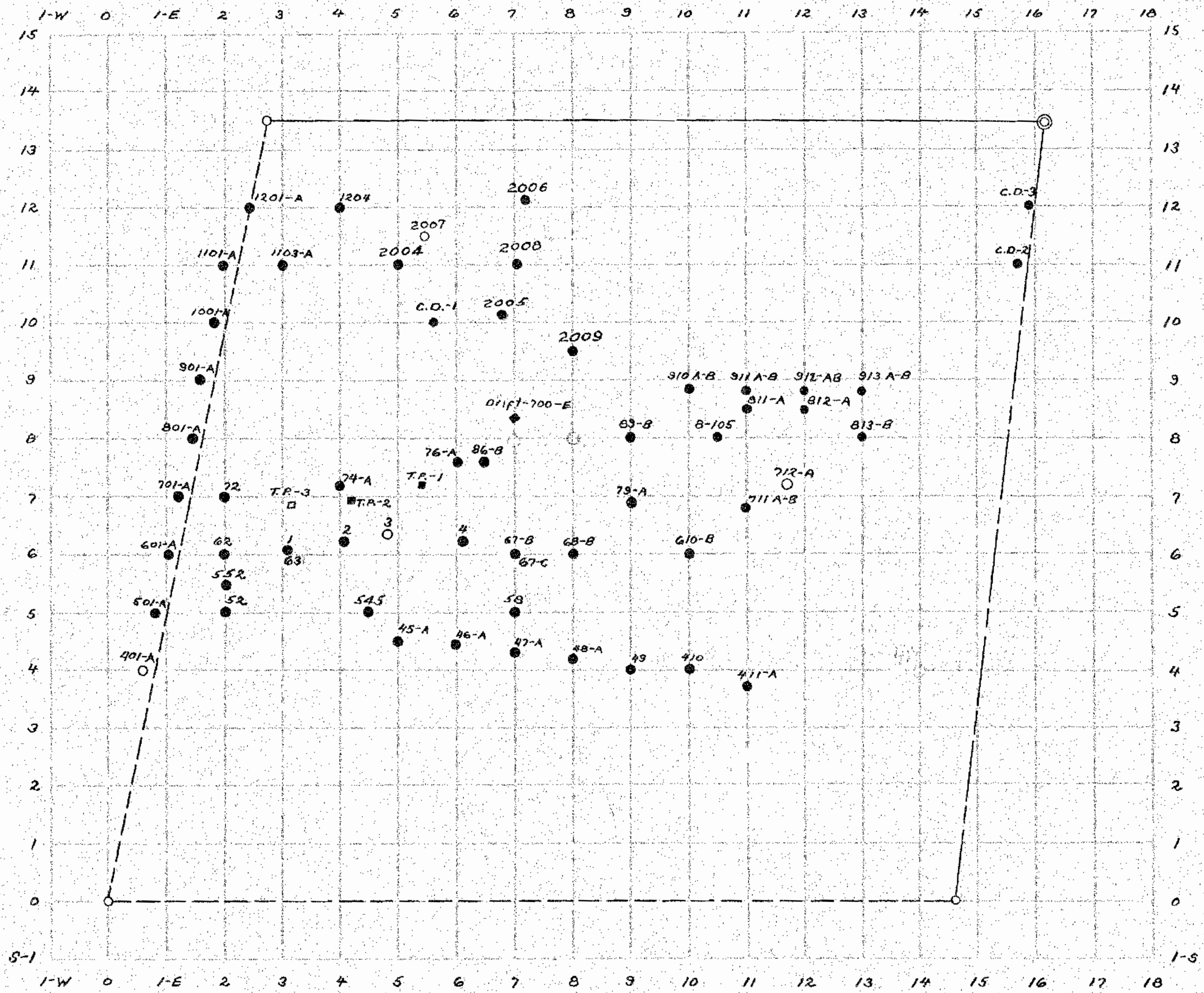

● Holes showing 50.00 iron or more.

N07\_005.TIF

J. Jov. - May 1946

