

L. S. C. I. MINES  
 MAP OF THE  
**DULUTH MINE**  
 BIWABIK, MINN.

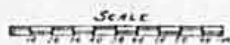

January 1, 1903.

C 53

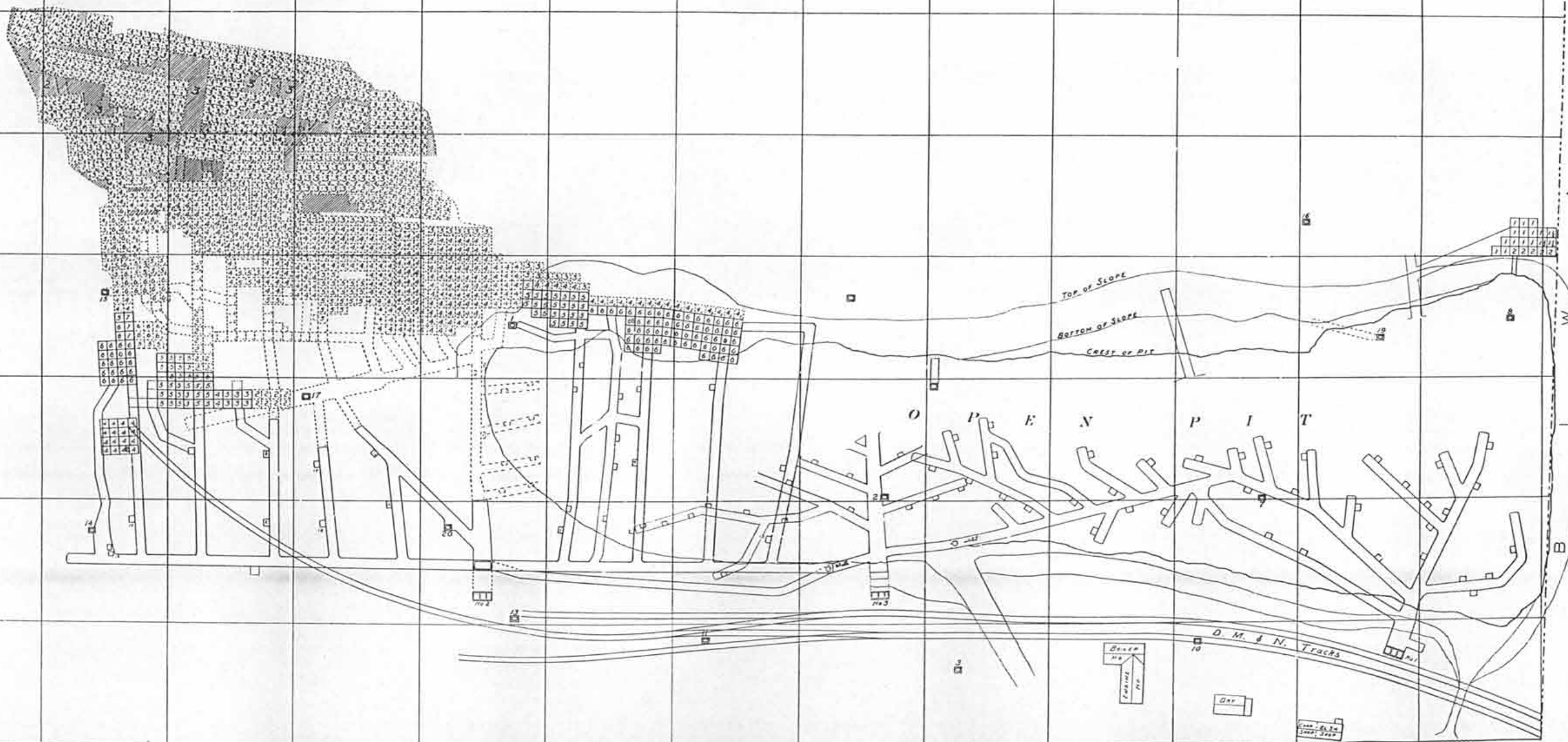

C

A

N

T

O

N

K

B

A

W

I

B

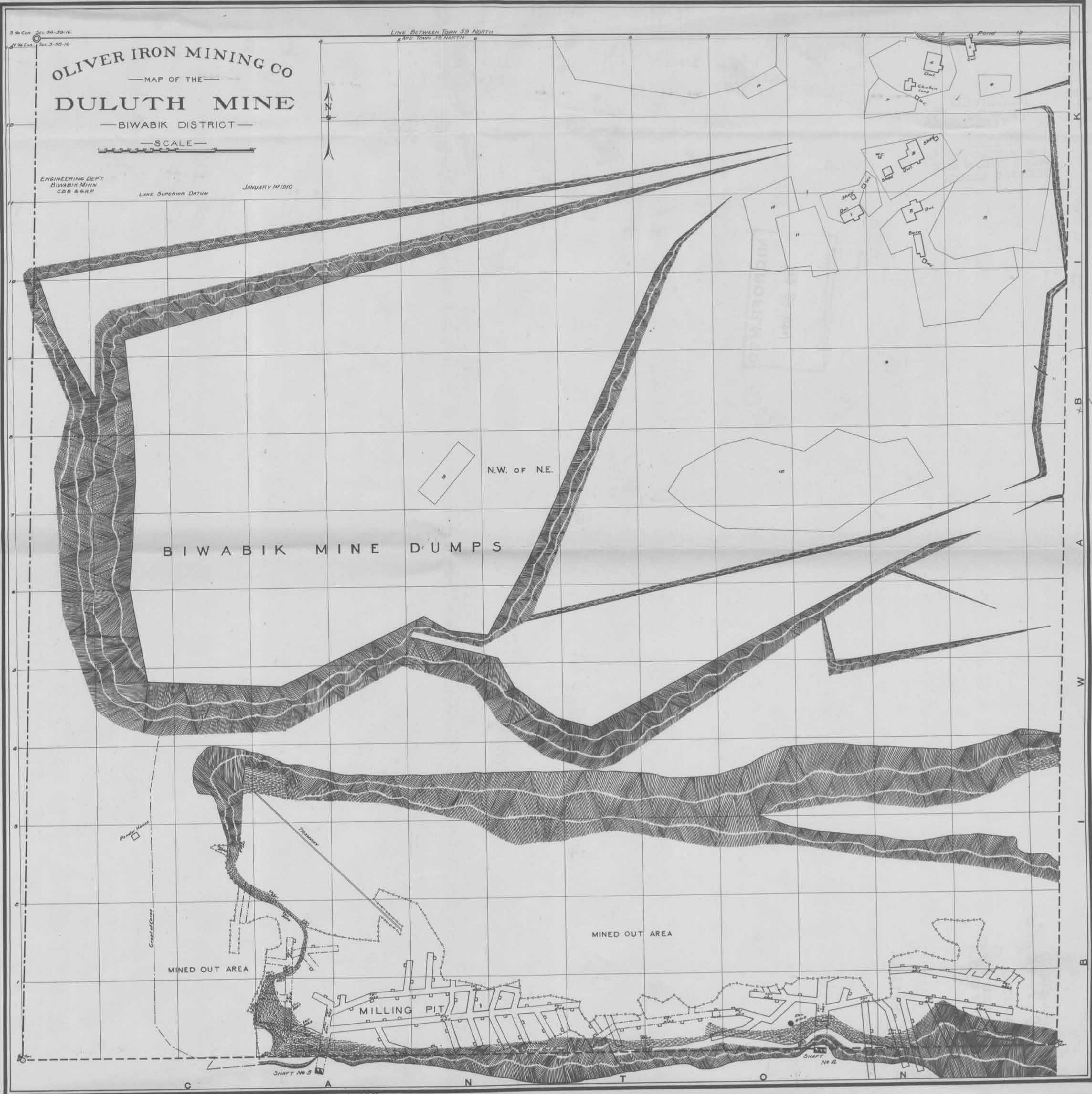

ESTIMATED  
OCT 13 1937  
SCHOOL OF MINES  
UNIVERSITY OF MINN.

*Change to 14 cu ft per foot  
analysis to remain  
unchanged*

ESTIMATED  
OCT 13 1937  
SCHOOL OF MINES  
UNIVERSITY OF MINN.

89 1531 1910 1-1-10 DULUTH MINE A-32 978-08

DULODIRVICOL

# OLIVER IRON MINING CO

—MAP OF THE—

## DULUTH MINE

—BIWABIK DISTRICT—

—SCALE—

ENGINEERING DEPT  
DULUTH MINN  
C.B. BRAD

JAN. 1, 1915  
JANUARY 1910

LAKE SUPERIOR DETON

LINE BETWEEN TOWN 59 NORTH  
AND TOWN 58 NORTH

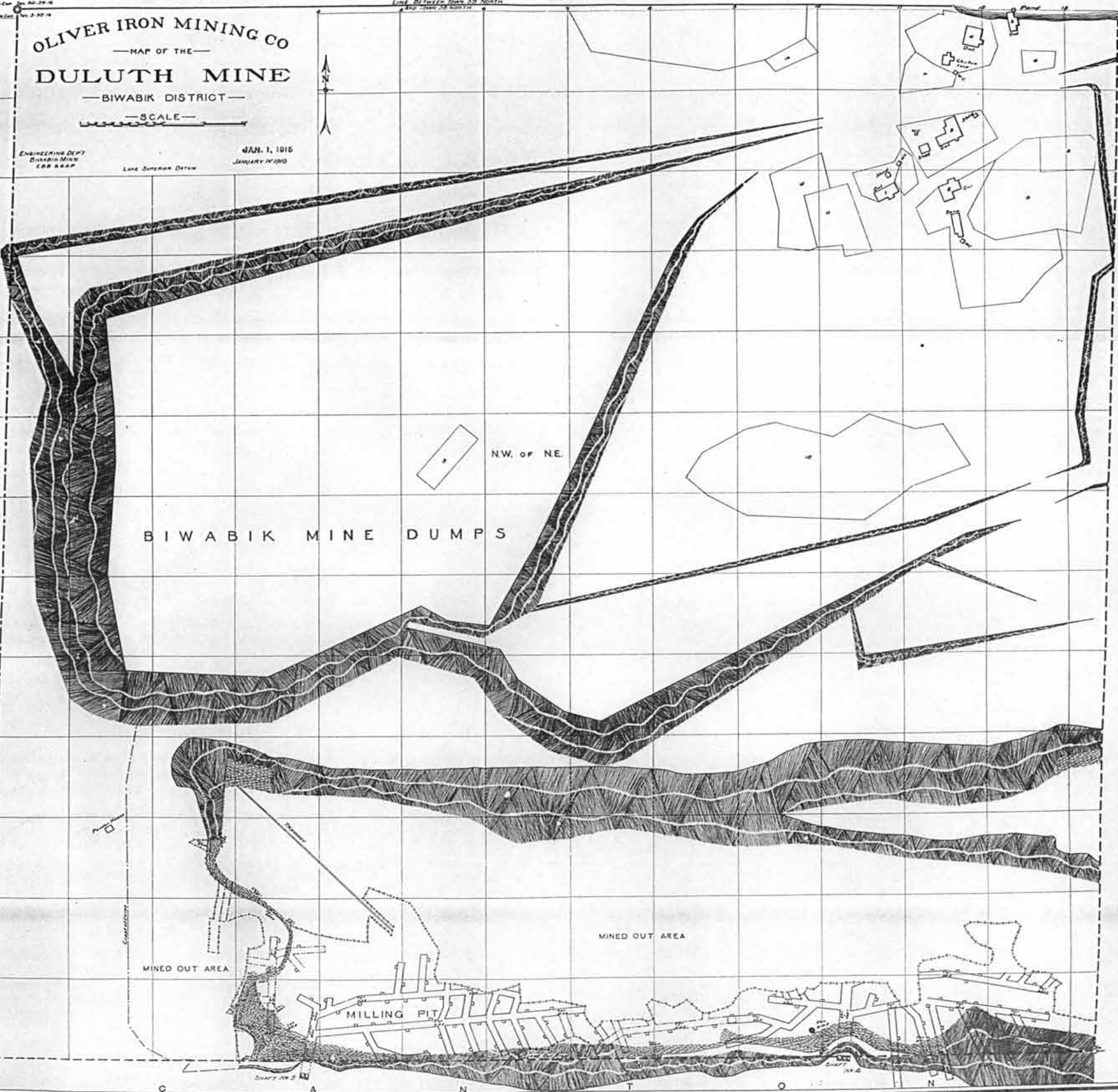

MAP OF THE

# DULUTH MINE

N.W. 1/4 of N.E. 1/4 of Sec. 3, Town 58, Range 16

Scale of Plat: 100' = 1"

Scale of Pits: 20' = 1"

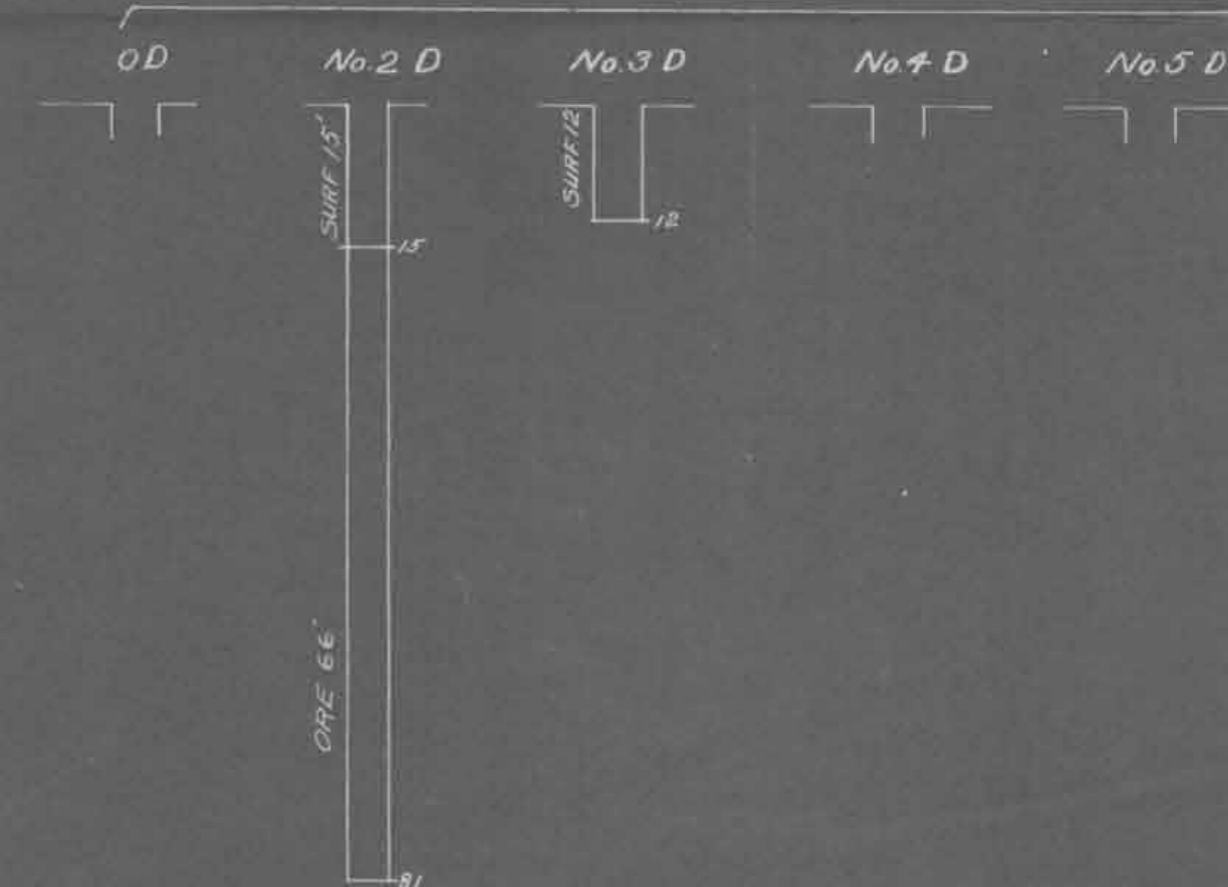
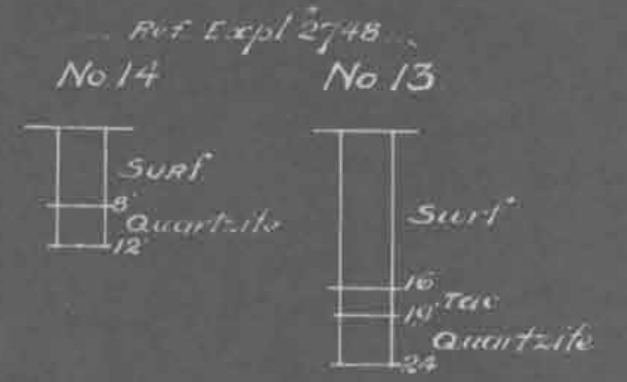
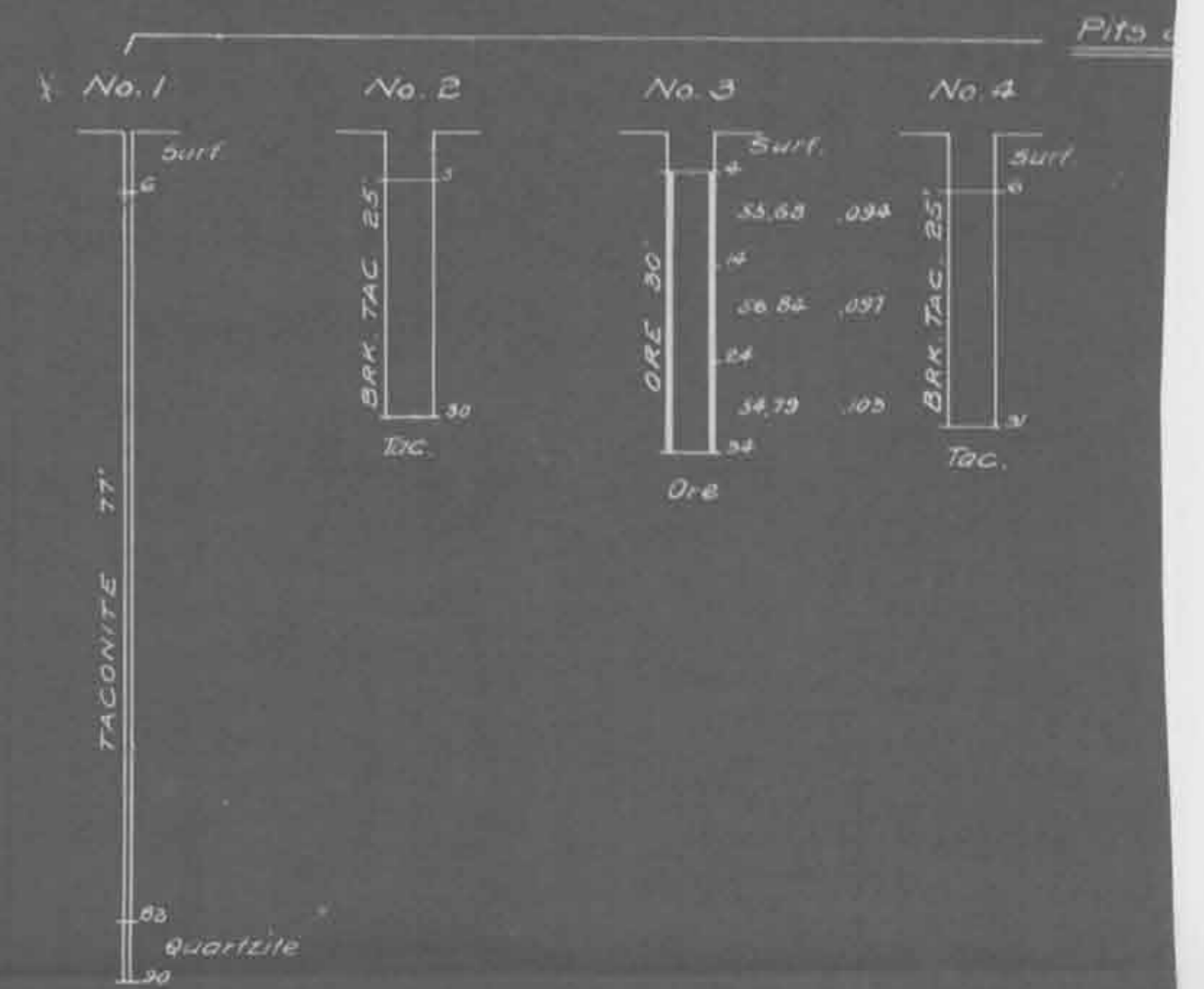

+ Proposed holes to be put down before dumping of stripping by Biwabik Mining Company is begun

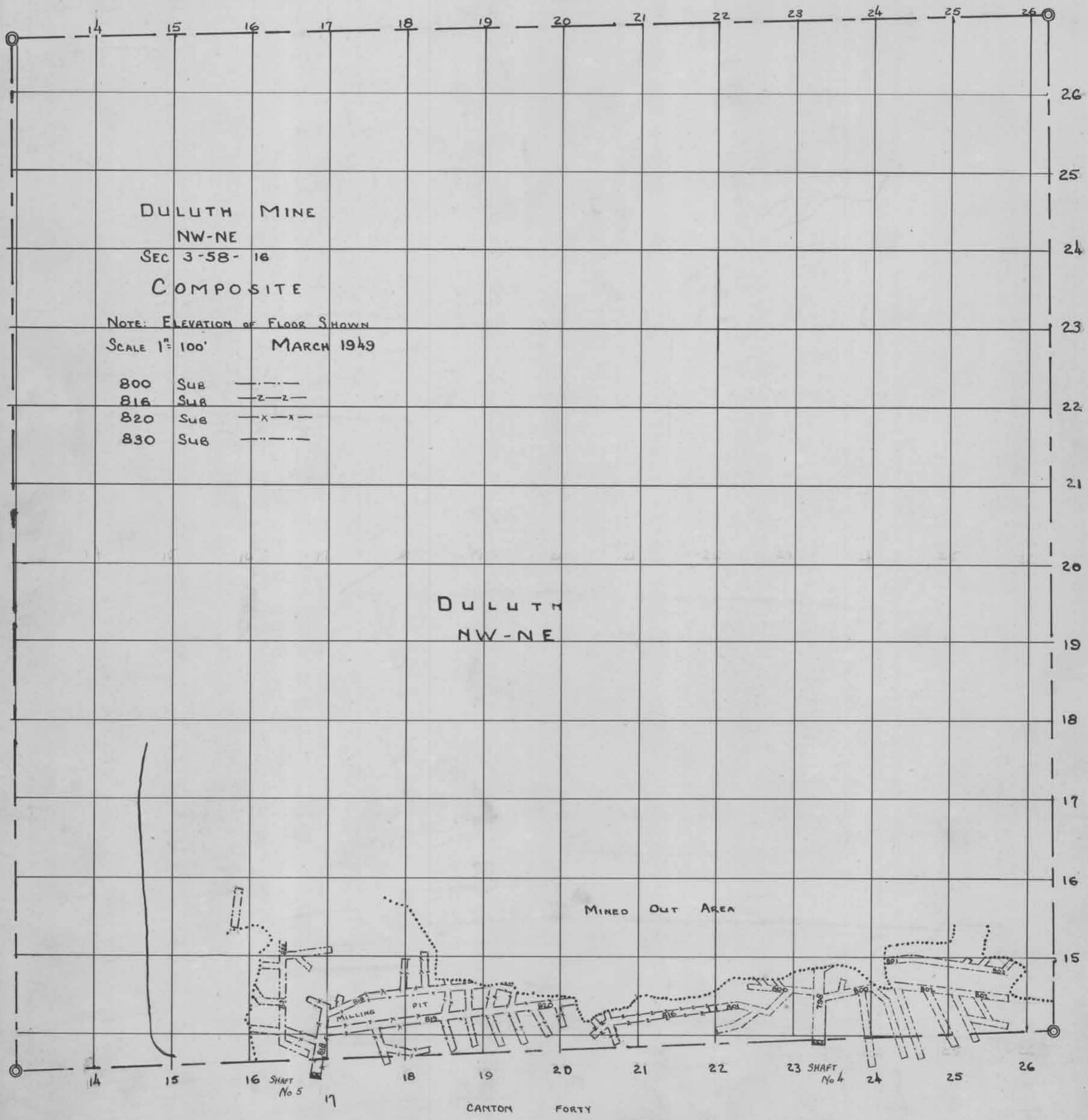

6260-1-43-7-1