

Location: Secs. 26-27-34&35, T.141 N. R.27 W.
Scale: 8" = 1 Mile

LOWER TRELIPE LAKE
Chippewa National Forest
Cass Co. - Minnesota

REPRODUCED PROPER CREDIT MUST BE GIVEN.
© State of Minnesota 1964

Area: 425 Acres
Length of Shore Line: 5.5 Miles

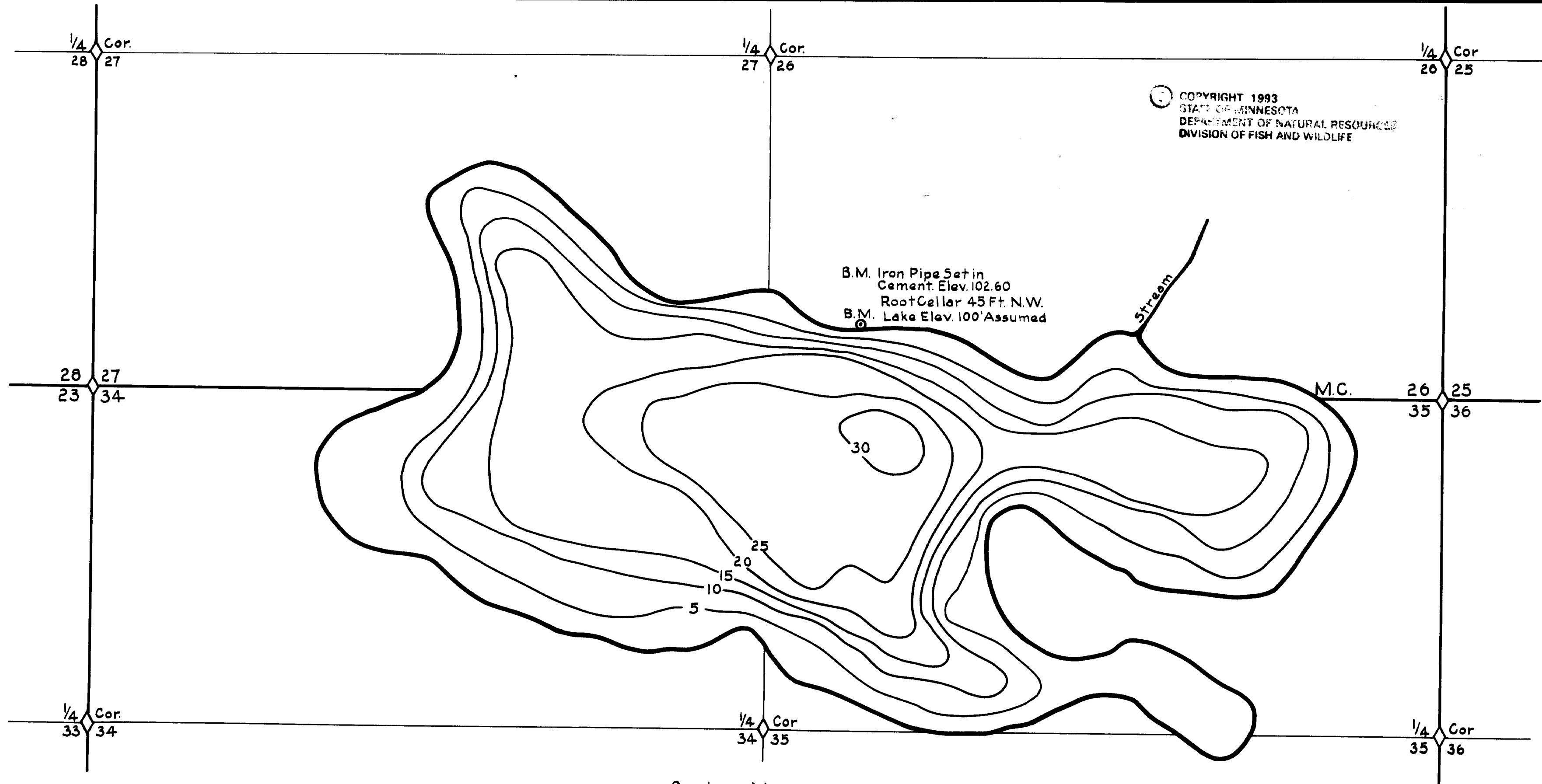

Contour Map
Contour Interval 5 Ft.

B-355

B-355