

LEGEND

- EMERGENT VEGETATION E.V.
- SUBMERGED VEGETATION S.V.
- FLOATING LEAF VEGETATION F.L.
- OPEN WATER O.W.
- MARSH
- STREAM
- BENCH MARK B.M. ⊕
- CULVERT
- PAVED ROAD
- GRAVEL ROAD
- UNIMPROVED ROAD
- COUNTY STATE AID HIGHWAY
- COUNTY ROAD
- SECTION LINE
- COUNTY PARK BOUNDARY

PLANNED AREA 297.2 ACRES
 LITTORAL AREA 140.2 ACRES (47.2%)
 MEDIAN DEPTH 16.5 FEET
 LENGTH OF SHORELINE 4.1 MILES

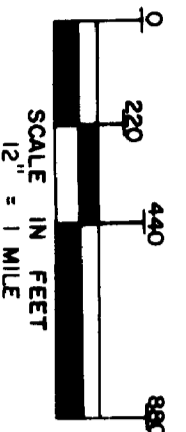

LAKE OUTLINE DRAWN FROM 1977 AERIAL BLUELINE
 PHOTO NO. 180-3 AND 181-2.

© COPYRIGHT 1993
 STATE OF MINNESOTA
 DEPARTMENT OF NATURAL RESOURCES
 DIVISION OF FISH AND WILDLIFE



STATE OF MINNESOTA
 Department of Administration
 Minnesota's Bookstore
 Part of the Department of Administration
 Print Communications Division
 To order reproduced copies of
 Contour Lake Maps call:
 612/297-5600 or our
 Nationwide toll-free number
 1-800-657-5187

B.M. 1 - TOP CENTER OF 6' DIAMETER CEMENT
 CULVERT BETWEEN LILY AND FAIRY LAKES.
 W.S.E. = 6.21' BELOW B.M. 1.
 B.M. 2 - GAUGE AT SOUTH END OF PARK NEAR
 PAVILION ON SOUTHEAST SHORE OF LAKE,
 10' FROM SHORE IN WATER.
 W.S.E. = 0.68' (GAUGE READING)

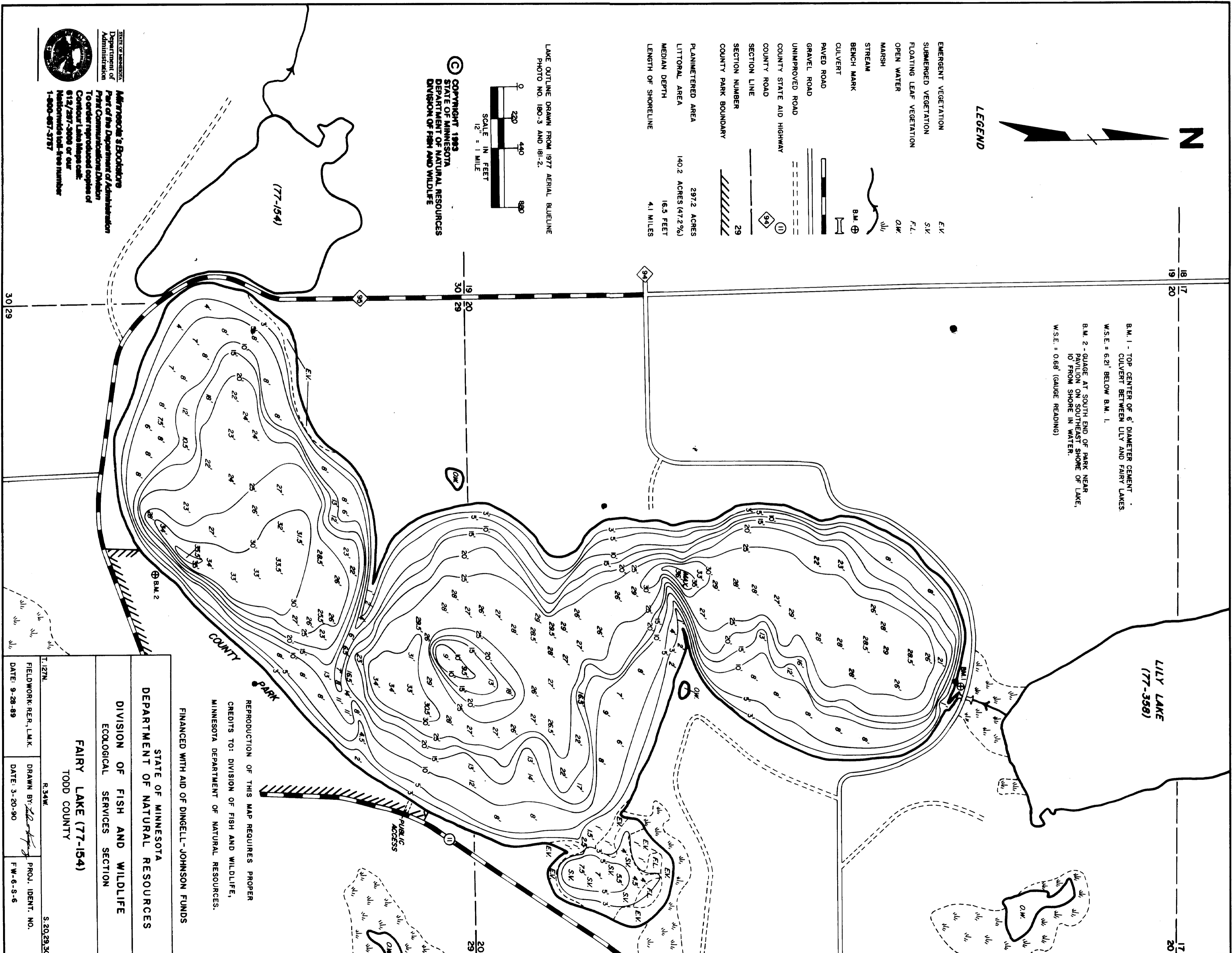

REPRODUCTION OF THIS MAP REQUIRES PROPER
 CREDITS TO: DIVISION OF FISH AND WILDLIFE,
 MINNESOTA DEPARTMENT OF NATURAL RESOURCES.
 FINANCED WITH AID OF DINGELL-JOHNSON FUNDS

STATE OF MINNESOTA
 DEPARTMENT OF NATURAL RESOURCES
 DIVISION OF FISH AND WILDLIFE
 ECOLOGICAL SERVICES SECTION

FAIRY LAKE (77-154)
 TODD COUNTY

T-127N	R-34W	S-20,29,30
FIELDWORK RER. L.M.K.	DRAWN BY: <i>[Signature]</i>	PROJ. IDENT. NO.
DATE: 9-28-89	DATE: 3-20-90	FW-6-S-6

C-2927

C-2927