

LEGEND

- OPEN WATER
- EMERGENT VEGETATION
- SUBMERGED VEGETATION
- MARSH
- STREAM
- INTERMITTENT STREAM
- DRAINAGE DITCH
- BENCH MARK
- CULVERT
- GRAVEL ROAD
- UNIMPROVED ROAD
- COUNTY ROAD
- SECTION LINE
- SECTION NUMBER

PLANIMETERED AREA 183.7 ACRES
 LITTORAL AREA 183.7 ACRES (100%)
 MEDIAN DEPTH 3.9 FEET
 LENGTH OF SHORELINE 2.95 MILES

LAKE OUTLINE DRAWN FROM 1977 BLUELINE
 AERIAL PHOTO NO. 18-3.

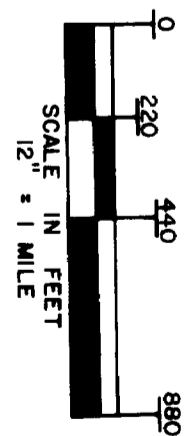

© COPYRIGHT 1989
STATE OF MINNESOTA
DEPARTMENT OF NATURAL RESOURCES
DIVISION OF FISH AND WILDLIFE

B.M. 1 - TOP OF SOUTH SIDE OF CEMENT APRON AROUND 3" DIAMETER CEMENT CULVERT ON WEST SIDE OF LAKE AT WATER'S EDGE.
 W.S.E. = 3.9' BELOW B.M. 1.
 B.M. 2 - TOP OF 8" DIAMETER CORRUGATED METAL CULVERT 50 FEET FROM WEST END OF LAKE, 3' FROM WATER'S EDGE.
 W.S.E. = 2.25' BELOW B.M. 2.

STATE OF MINNESOTA
 Department of Administration
Minnesota's Bookstore
 Part of the Department of Administration
 First Communications Division
 To order reproduced copies of
 Contact Lita Hays (ask
 612/297-3000 or our
 Nationwide toll-free number
 1-800-687-5787

REPRODUCTION OF THIS MAP REQUIRES PROPER CREDITS TO: DIVISION OF FISH AND WILDLIFE, MINNESOTA DEPARTMENT OF NATURAL RESOURCES.
 FINANCED WITH AID OF DINGELL-JOHNSON FUNDS

STATE OF MINNESOTA
 DEPARTMENT OF NATURAL RESOURCES
 DIVISION OF FISH AND WILDLIFE
 ECOLOGICAL SERVICES SECTION
 INDIAN LAKE (53-7)
 NOBLES COUNTY

T. LOIN R. 39W. S. 27, 34
 FIELDWORK M.E.H. C.J.B. DRAWN BY: *[Signature]* PROJ. IDENT. NO.
 DATE: 6-9-87 DATE: 4-20-89 FW-6-S-4,6

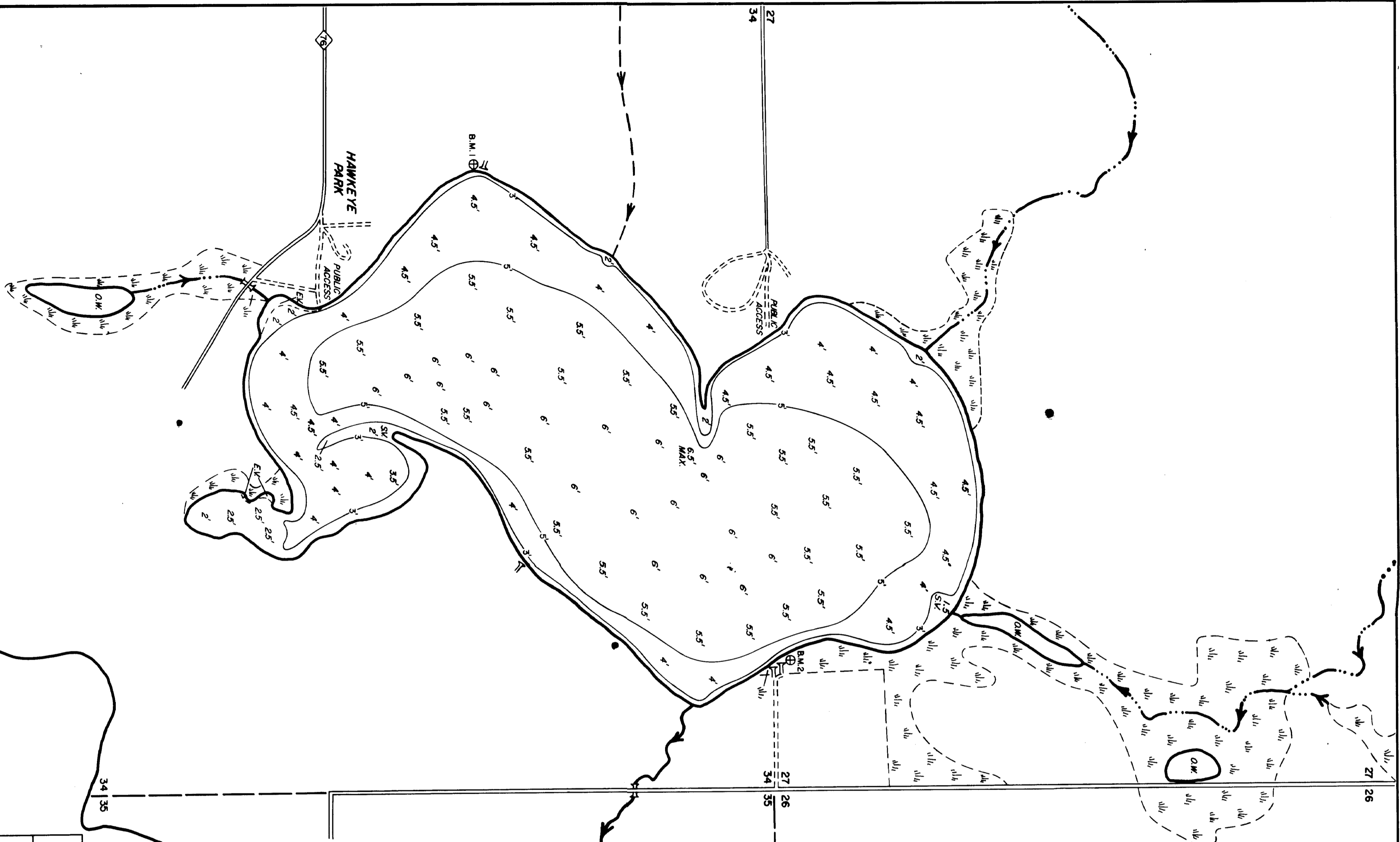

C-2911

1152 C