

© COPYRIGHT 1963
 STATE OF MINNESOTA
 DEPARTMENT OF NATURAL RESOURCES
 DIVISION OF FISH AND WILDLIFE

R. 24 W.

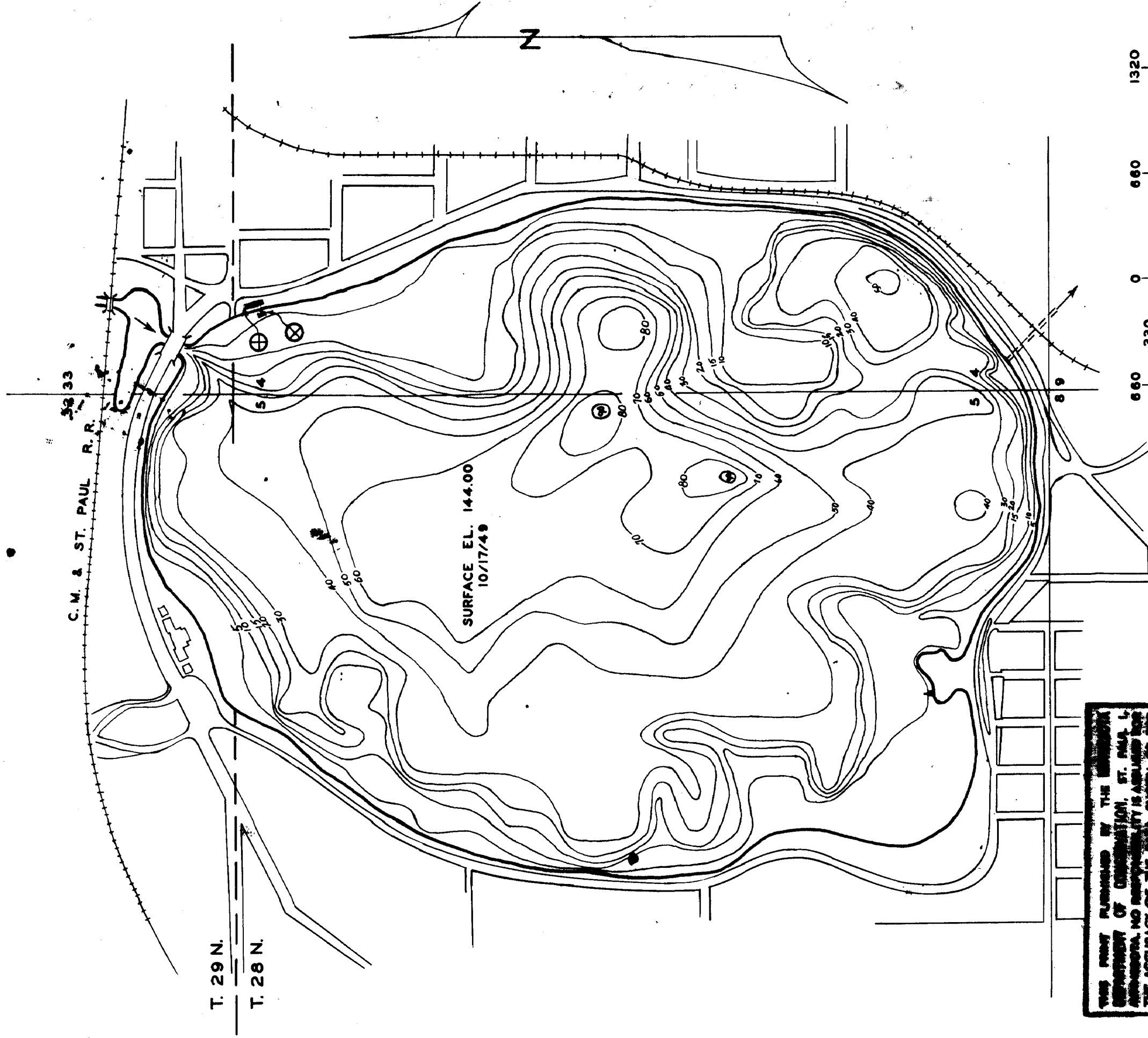

THIS MAP WAS PLANNED BY THE MINNESOTA DEPARTMENT OF CONSERVATION, ST. PAUL, MINNESOTA. NO RESPONSIBILITY IS ASSUMED FOR THE ACCURACY OF THE DATA SHOWN OR FOR CHANGES OR OMISSIONS MADE IN ANY REPRODUCED FORM. PROPER CREDIT MUST BE GIVEN.

⊕ B.M. - NW CORNER OF REFECTORY BUILDING
 SET BY MPLS. BRD. PARKS ENG.
 EL. - 147.99

⊗ B.M. - TOP OF CONCRETE WALL AT SOUTH
 SIDE OF DOCK
 SET BY FISH. RESEARCH
 W.L. = B.M. - 2.0 FT.
 8/25/53

● State of Minnesota 1964

STATE OF MINNESOTA
 DEPARTMENT OF CONSERVATION
 CHESTER S. WILSON - COMMISSIONER

DIVISION OF GAME AND FISH
 BUREAU OF FISHERIES

LAKE CALHOUN 27 - 31
 HENNEPIN COUNTY

FIELD WORK AND BASE MAP BY
 MPLS. PARK BRD. ENGS. - 10/17/48
 DRAWN BY E.L. DATE 3/30/54
 FISHERIES RESEARCH UNIT

D.O.W.
 FILE
 NO.

1964

6/C