

Minnesota's Bookstore
Part of the Department of Administration
Print Communications Division
To order reproduced copies of
Contour Lake Maps call:
612/297-3000 or our
Nationwide toll-free number
1-800-657-3757

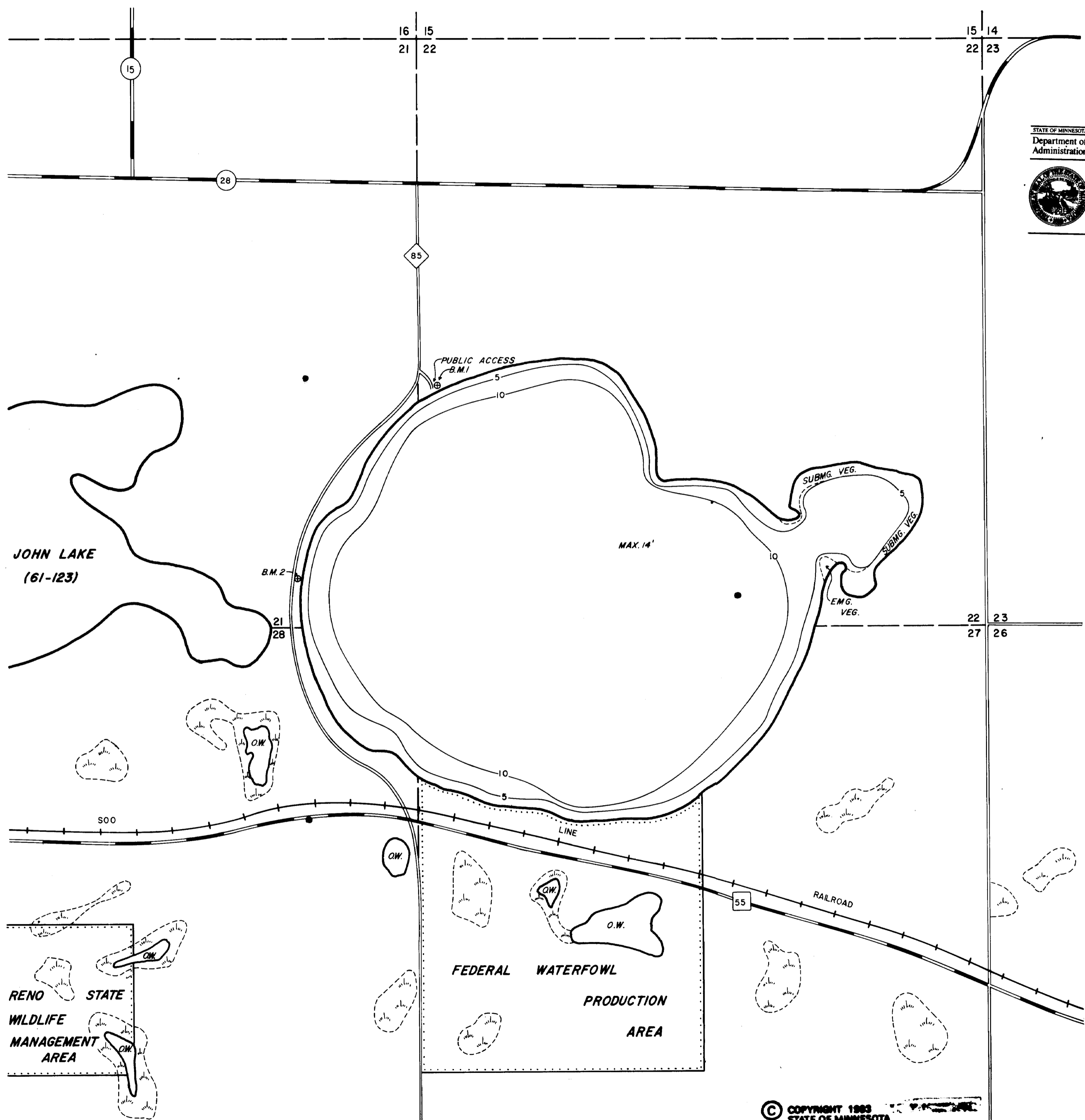

LEGEND

- GRAVEL ROAD
- BITUMINOUS ROAD
- WILDLIFE AREA BOUNDARY
- MARSH AREA
- COUNTY ROAD
- STATE HIGHWAY
- COUNTY STATE AID HIGHWAY
- OPEN WATER
- EMERGENT VEGETATION
- SUBMERGED VEGETATION

PLANIMETERED AREA 356 ACRES
LITTORAL AREA 356 ACRES
SHORELINE LENGTH 3.2 MILES

B.M. 1 = SPIKE IN DOUBLE-TRUNKED COTTONWOOD 10' EAST OF PUBLIC ACCESS RAMP, 10' FROM WATER'S EDGE ON NORTH SIDE OF LAKE

W.S. ELEV. = 3.7' BELOW B.M. 1

B.M. 2 = SPIKE IN UTILITY POLE 15' FROM ROAD, 10' FROM WATER'S EDGE ON WEST SIDE OF LAKE

W.S. ELEV. = 3.7' BELOW B.M. 2

OUTLINE DRAWN FROM 1965 AERIAL PHOTO. NO.: BJJ-2FF-189

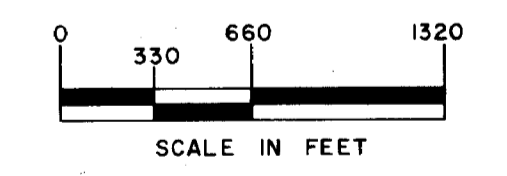

STATE OF MINNESOTA DEPARTMENT OF NATURAL RESOURCES		
DIVISION OF GAME AND FISH TECHNICAL SERVICES SECTION		
ANN LAKE (61-122)		
POPE COUNTY		
T. 126 N. R. 38 W. S. 21, 22, 27, 28		
FIELDWORK C.M.H. & R.L.M.	DRAWN BY R.L.M.	PROJ. IDENT. NO.
DATE 7-19-71	DATE 5-12-72	FW-1-R-16

© COPYRIGHT 1983
STATE OF MINNESOTA
DEPARTMENT OF NATURAL RESOURCES
DIVISION OF FISH AND WILDLIFE