

LEGEND
 MINNESOTA C.C.C.
CAMP S-144, BADOURA
 SURVEY OF
LITTLE SAND LAKE
 HUBBARD COUNTY
 SECS. 25-30-35-36
 T. 141 R. 33-34W.
 AREA 418.35 ACRES
 WORK DONE MARCH 20, 1941
 SHORE LINE
 CONTOUR LINES
 BOTTOM TYPES
 SCALE 1" = 400'
 FIELD WORK BY R. W. BOSMANS
 MAPPED BY R. J. CAVANAUGH
 TRACED BY E. E. LAHTI
 BENCH MARK ⊕

REPRODUCED PROPER CREDIT MUST BE GIVEN.

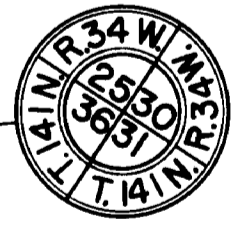
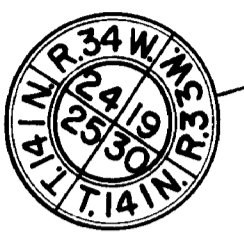
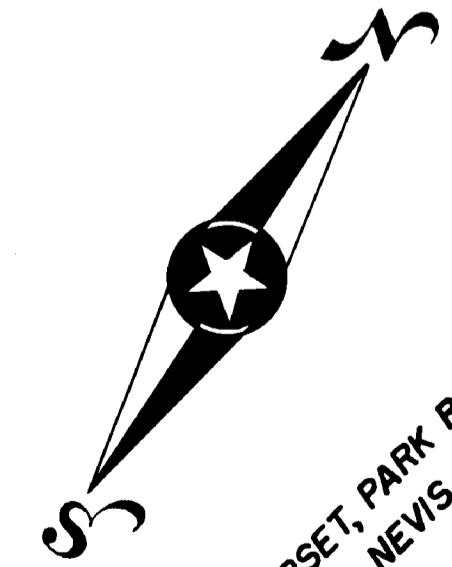
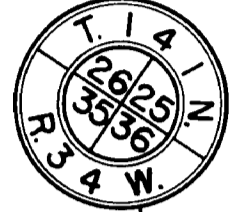
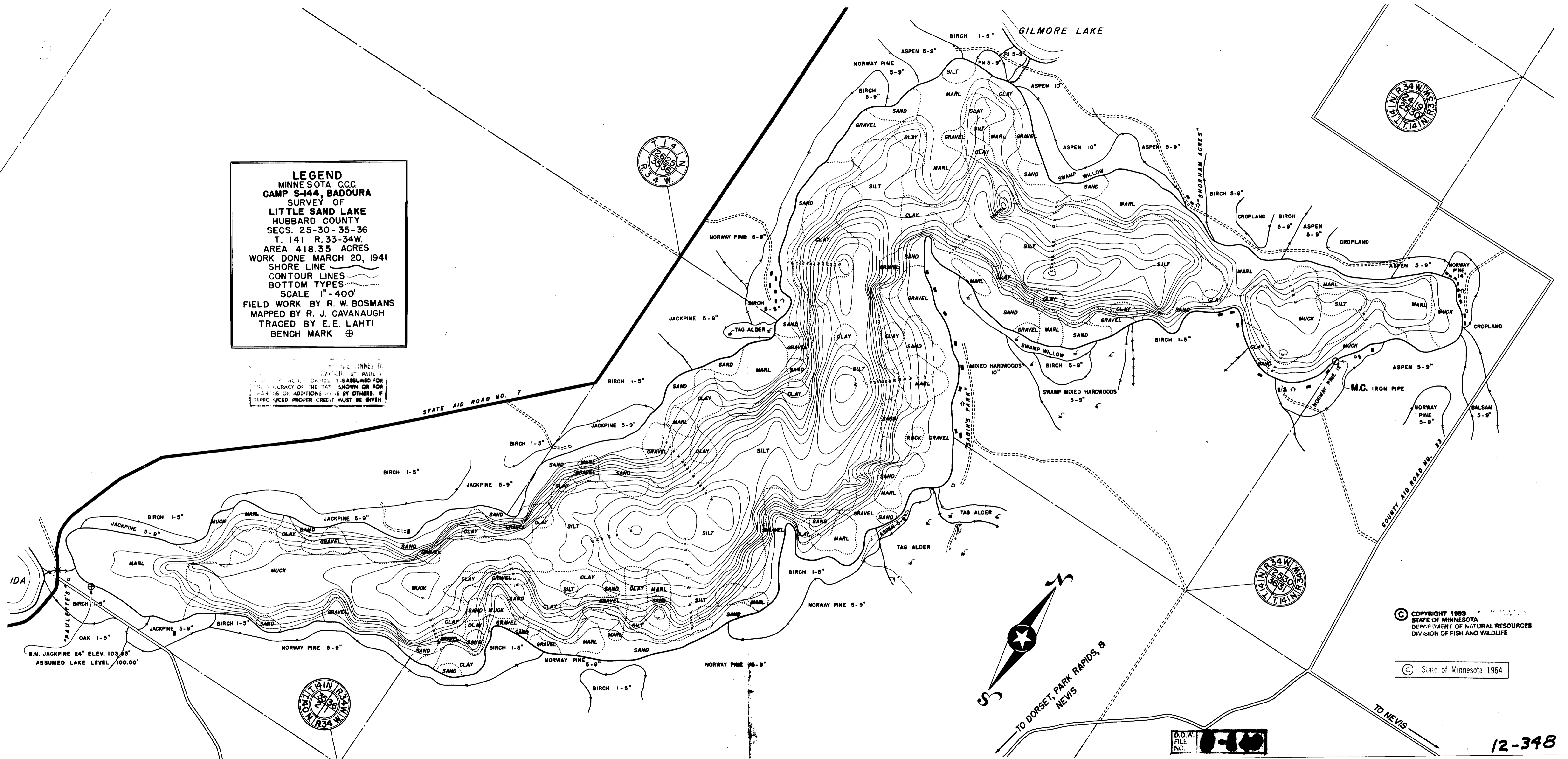

© COPYRIGHT 1963
 STATE OF MINNESOTA
 DEPARTMENT OF NATURAL RESOURCES
 DIVISION OF FISH AND WILDLIFE

State of Minnesota 1964

D.O.W.
 FILE NO. 1-10

12-348

B.M. JACKPINE 24" ELEV. 103.63'
 ASSUMED LAKE LEVEL 100.00'

TO DORSET, PARK RAPIDS, &
 NEVIS

TO NEVIS