

# ADNEY LAKE

S. 32 - T137, R26  
 S. 31 - T137, R26  
 S. 1 - T136, R27  
 S. 6 - T136, R26

1938  
 STATE OF MINNESOTA  
 DEPARTMENT OF NATURAL RESOURCES  
 DIVISION OF FISH AND WILDLIFE

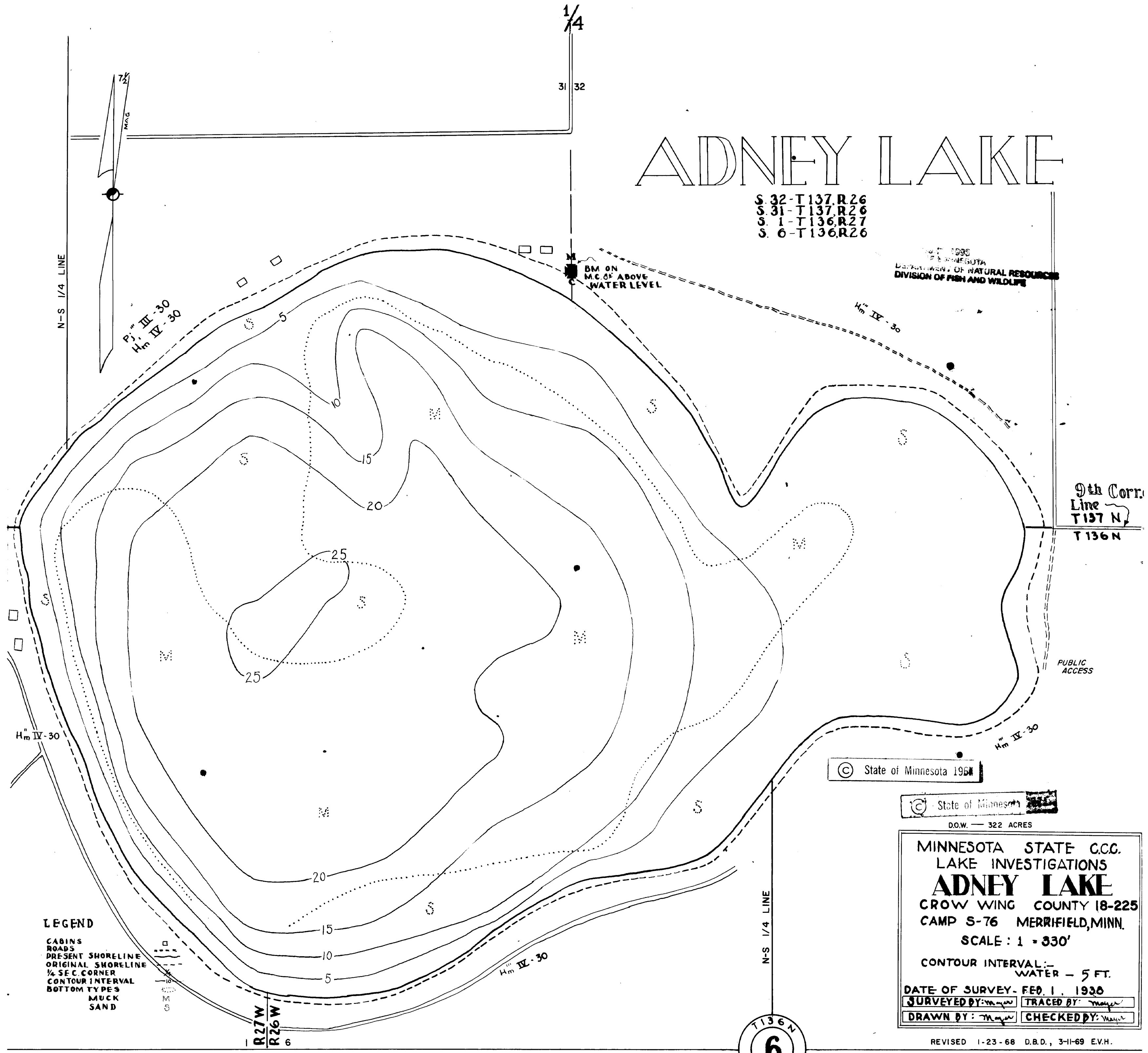

**LEGEND**  
 CABINS  
 ROADS  
 PRESENT SHORELINE  
 ORIGINAL SHORELINE  
 1/4 SE C. CORNER  
 CONTOUR INTERVAL  
 BOTTOM TYPES  
 MUCK  
 SAND

© State of Minnesota 1968

State of Minnesota  
 D.O.W. — 322 ACRES

MINNESOTA STATE C.C.C.  
 LAKE INVESTIGATIONS  
**ADNEY LAKE**  
 CROW WING COUNTY 18-225  
 CAMP S-76 MERRIFIELD, MINN.  
 SCALE: 1 = 330'  
 CONTOUR INTERVAL: —  
 WATER — 5 FT.  
 DATE OF SURVEY: FEB. 1, 1938  
 SURVEYED BY: *Mayer* TRACED BY: *Mayer*  
 DRAWN BY: *Mayer* CHECKED BY: *Mayer*

REVISED 1-23-68 D.B.D., 3-11-69 E.V.H.

T136 N  
**6**  
 R26 W

C-1Q31