

BASS LAKE

SEC'S 29-32 TWP.136,R.27

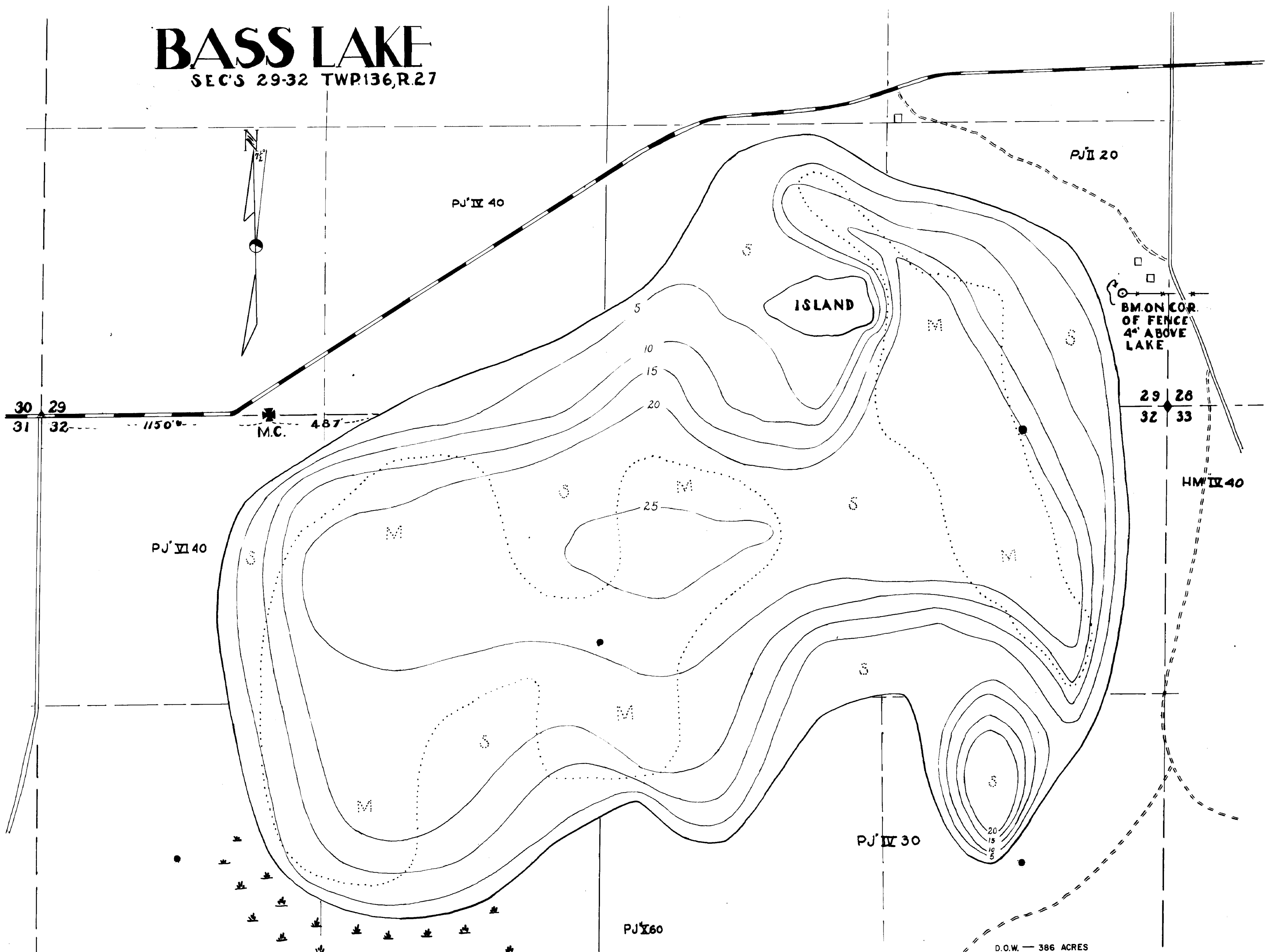

LEGEND

- CABIN ROAD
- ROAD
- SEC. COR.
- PRESENT SHORE LINE
- WATER CONTOUR
- BOTTOM TYPE AREA
- BOTTOM TYPES
- SWAMP AREA

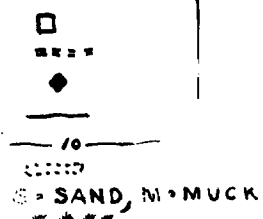

© COPYRIGHT 1993
STATE OF MINNESOTA
DEPARTMENT OF NATURAL RESOURCES
DIVISION OF FISH AND WILDLIFE

© State of Minnesota

REVISED 1-23-68 D.B.D.

D.O.W. — 386 ACRES

MINNESOTA STATE C.C.C.
LAKE INVESTIGATIONS
BASS LAKE
CROW WING COUNTY 18-256
CAMP S-76 MERRIFIELD, MINN.
SCALE 1" = 330'
CONTOUR INTERVAL :-
WATER - 5 FT
DATE OF SURVEY - MAR. 14, 1938
SURVEYED BY: *W.M.A.* TRACED BY: *W.M.A.*
DRAWN BY: *W.M.A.* CHECKED BY: *W.M.A.*

FILE 1.C - 1028

C-1028