

Location Sec's 15, 22 & 27 T. 149 N. R. 26 W.
Scale 1/6 inches = 1 Mile

ITASCA COUNTY

BASS LAKE 31-839
Chippewa National Forest
Minnesota

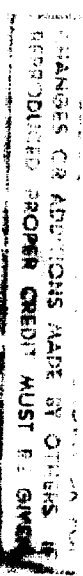

D.O.W. — 202 ACRES
Length of Shore Line 3.4 Miles

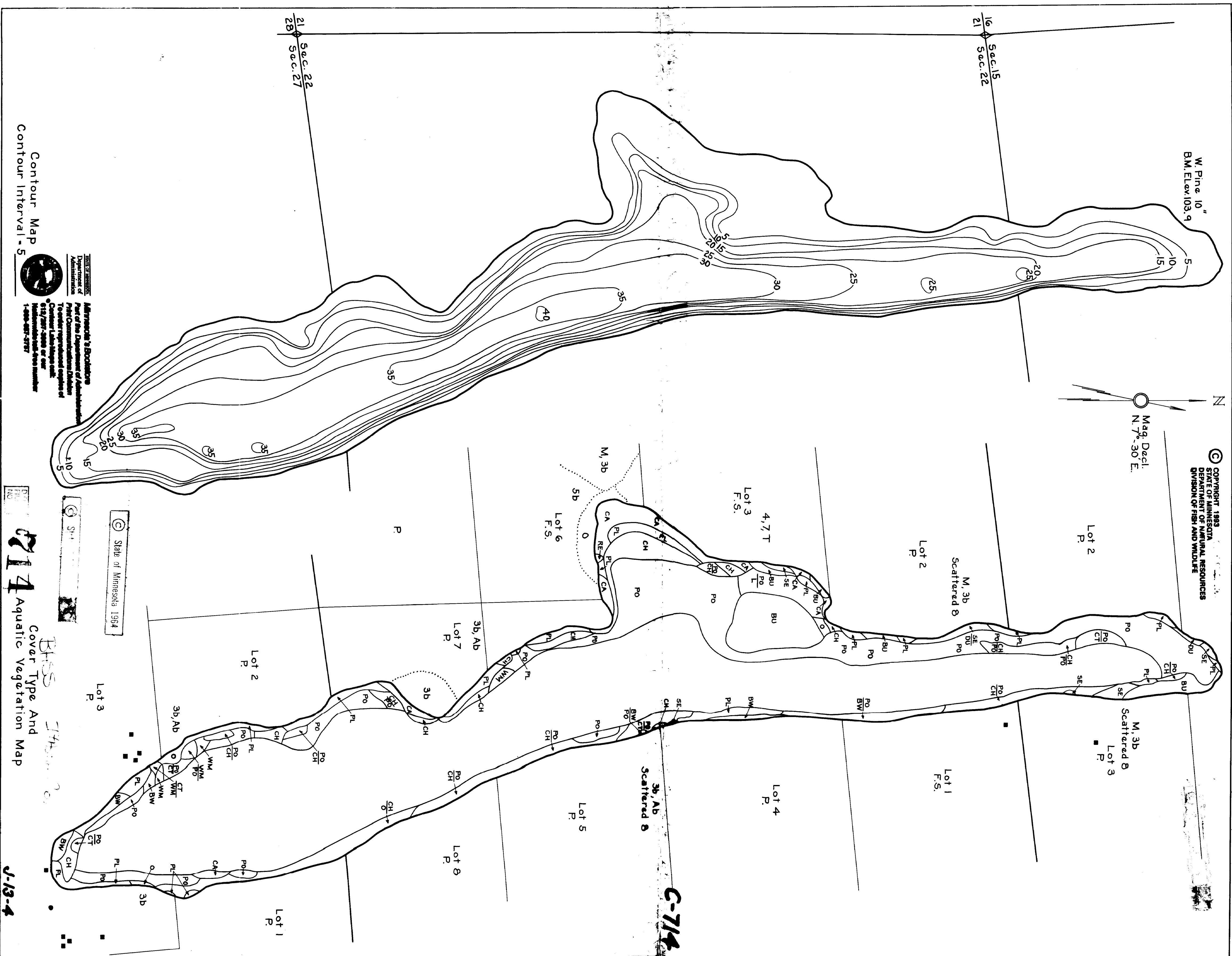

Contour Map
Contour Interval - 5



Minnesota's DNR
Department of
Natural Resources
Part of the Department of Agriculture
Public Conservation Division
The center represents the
Department's headquarters
613/297-2800 or
1-800-551-5771

State of Minnesota 1964

214

Cover Type And
Aquatic Vegetation Map

J-13-4