

HEART LAKE
Superior National Forest
Minnesota

LAKE COUNTY

FOOLS LAKE 38-761
Location Secs. 11, 12 T. 59 N. R. 11 W.
Scale 8 inches = 1 Mile
Area 295 Acres
Length of Shoreline .87 Miles

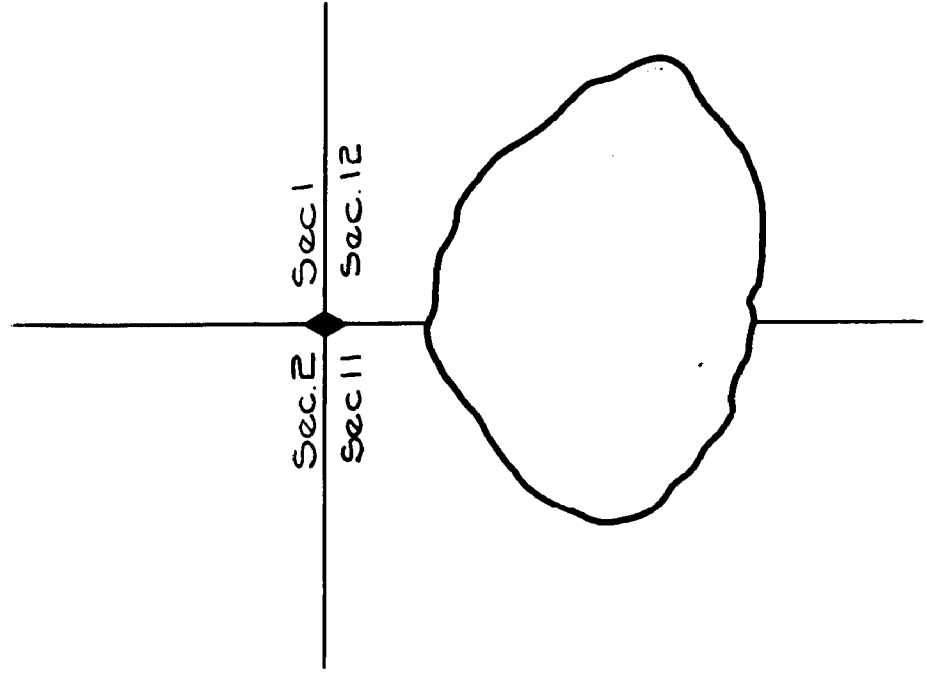

Maximum Depth 11'
Average Depth 5'

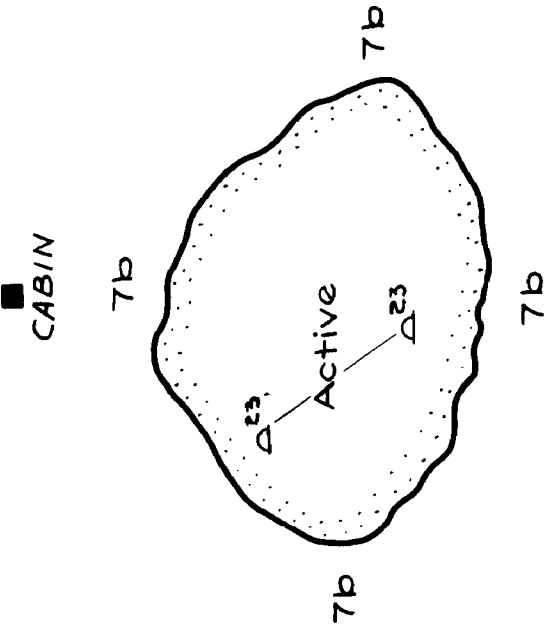

PITCHA (LONG) LAKE 38-676
Location Secs. 19, 20 T. 60 N. R. 10 W.
Scale 8 inches = 1 Mile
Area 30 Acres
Length of Shoreline .8 Miles

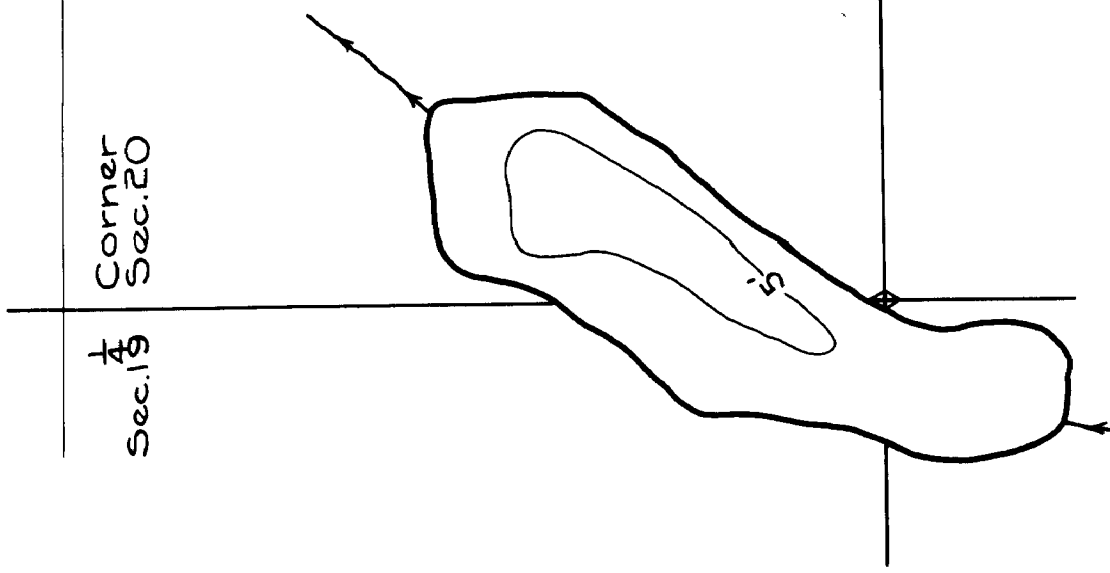

Maximum Depth 7'
Average Depth 4'

Contour Maps
Contour Inter=5

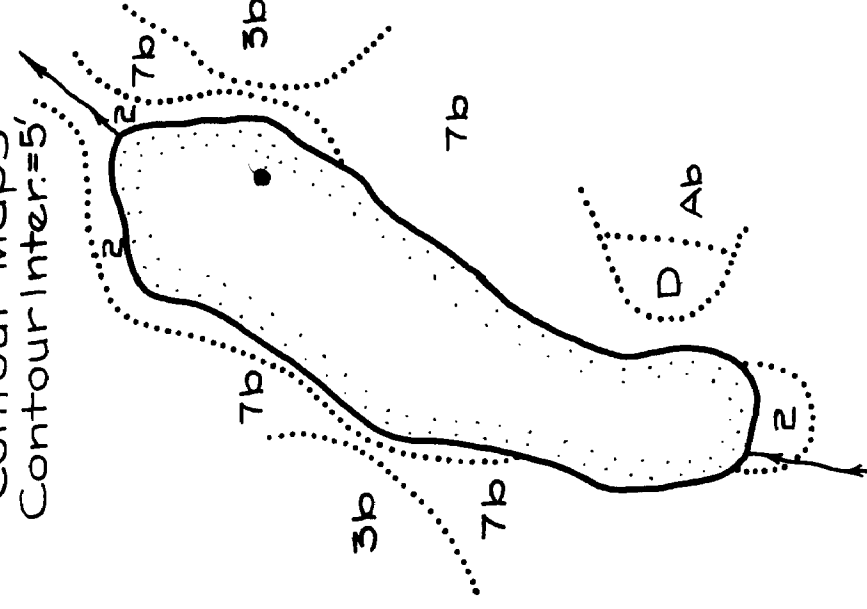

Cover Type And
Lake Bottom Soil Type Maps

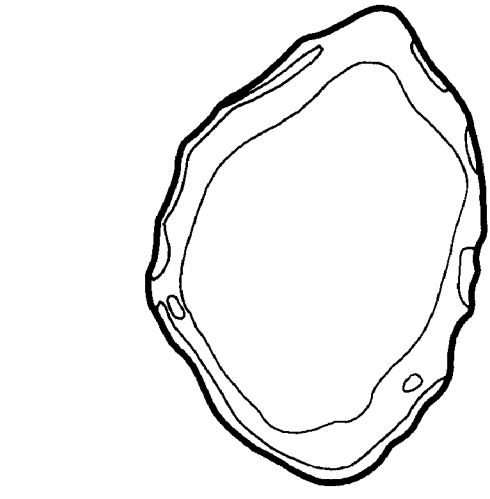

C249

HEART LAKE 38-692
Location Sec. 18 T. 61 N. R. 10 W.
Scale 8 inches = 1 Mile
Area 45 Acres
Length of Shoreline 1.2 Miles

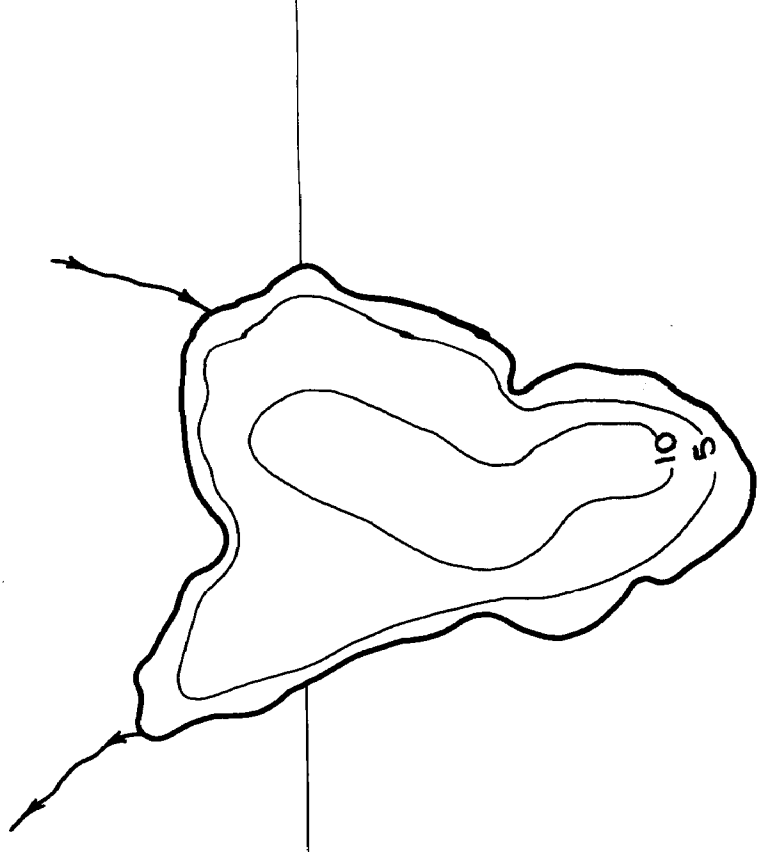
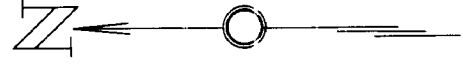

Maximum Depth 11'
Average Depth 8.5'

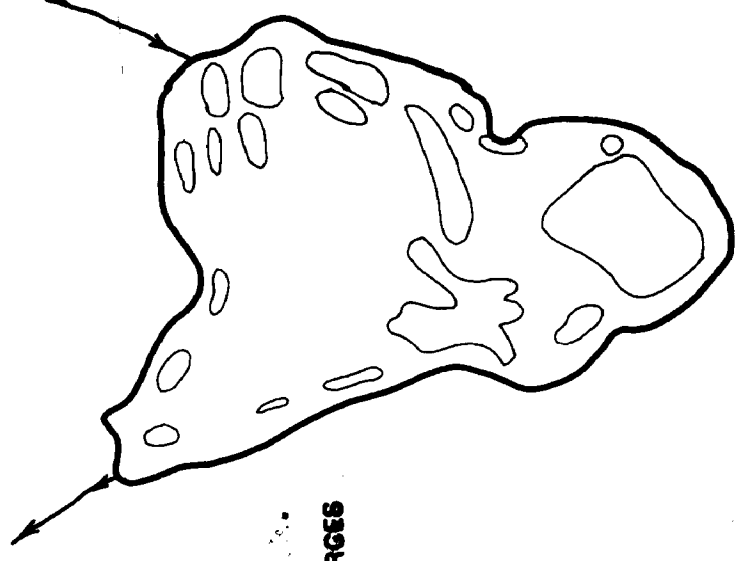
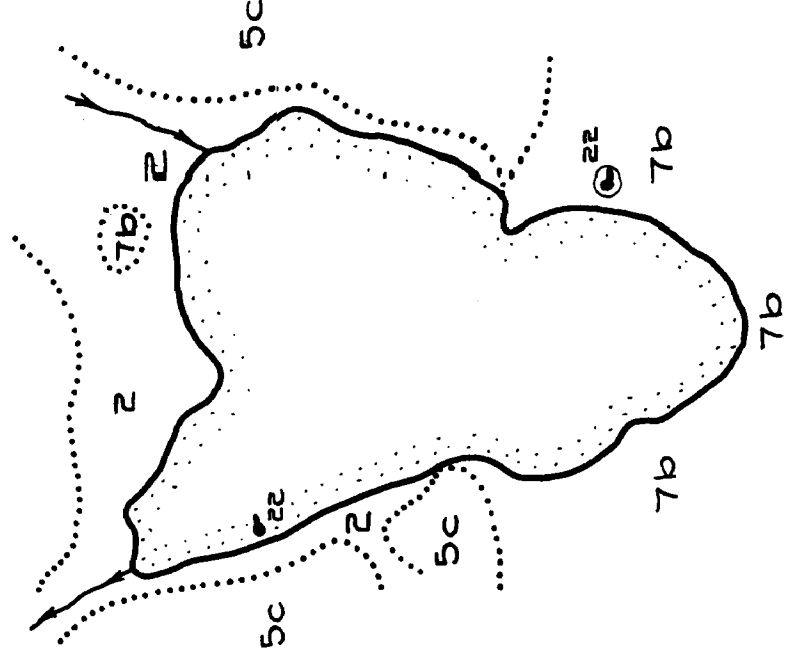

© COPYRIGHT 1993
STATE OF MINNESOTA
DEPARTMENT OF NATURAL RESOURCES
DIVISION OF FISH AND WILDLIFE

© State of Minnesota 1964
Minnesota's Biohistory
Part of the Department of Administration
Plant Conservation Division
Cover Type and Bottom Soil Type Maps
010/007-0007 or call
Minnesota's Biohistory number
1-800-687-3787

Aquatic Vegetation Maps

FILE NO. **C249**

J-17-12