

R-9
 U.S. Department of Agriculture
 Forest Service
 LAKE AND STREAM SURVEY
 FINGER LAKE
 Superior National Forest
 Minnesota

Location Sec. 7, 8, 17, 18 T. 67N. R. 14 W.
 Scale 8 inches = 1 Mile

Area 287.8 Acres
 Length of Shore Line 6.92 Miles

St. Louis

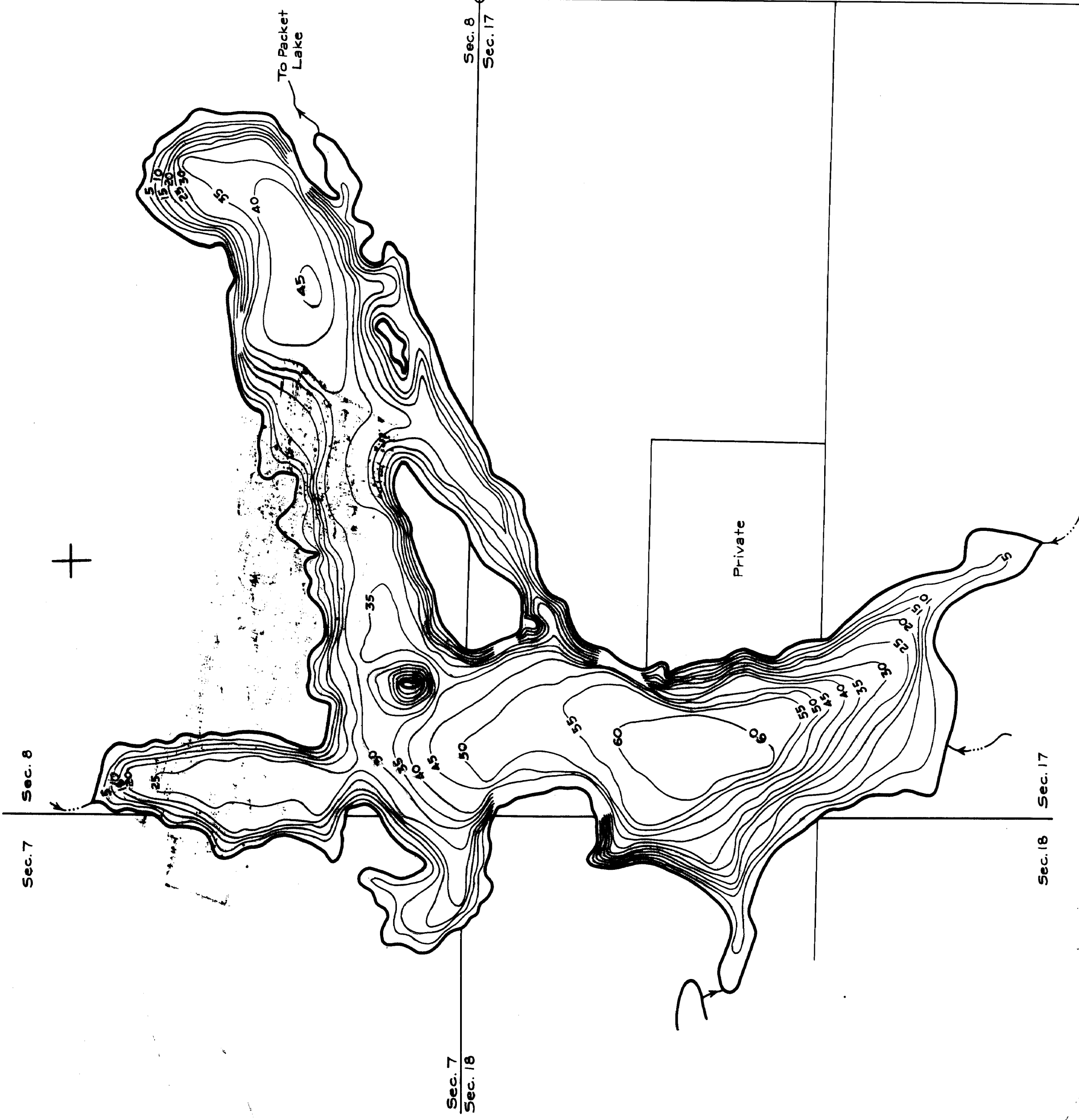

Minnesota's Statewide
 Department of Natural Resources
 Part of the Department of Administration
 100 North Washington Avenue
 St. Paul, Minnesota 55101
 Central Lakes Region
 1-800-557-5787

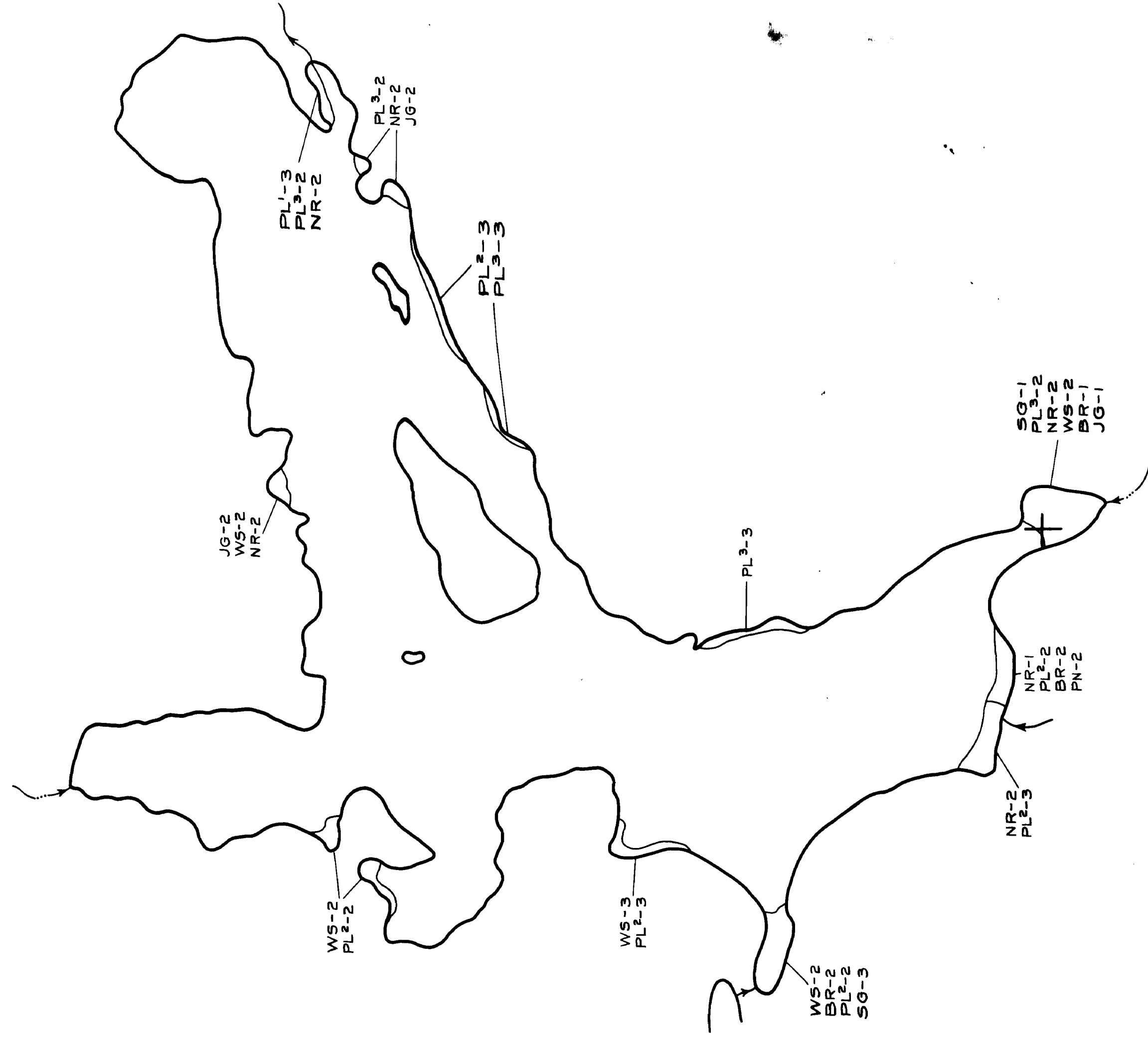
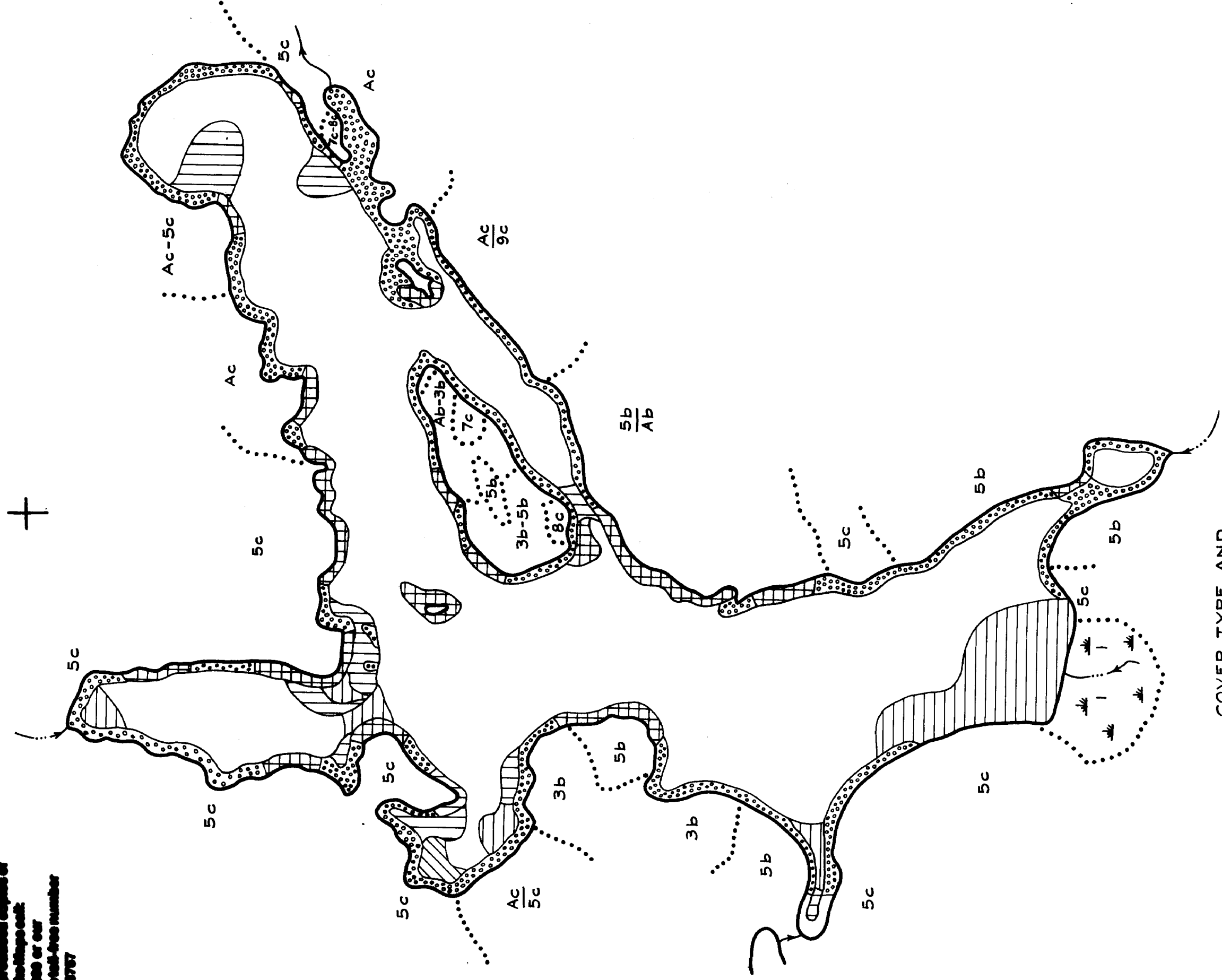

COMPILED 1988
 FROM DATA OF
 SUPERIOR NATIONAL FOREST
 DIVISION OF FISH AND WILDLIFE

State of Minnesota 1964

