

WEST BATTLE LAKE

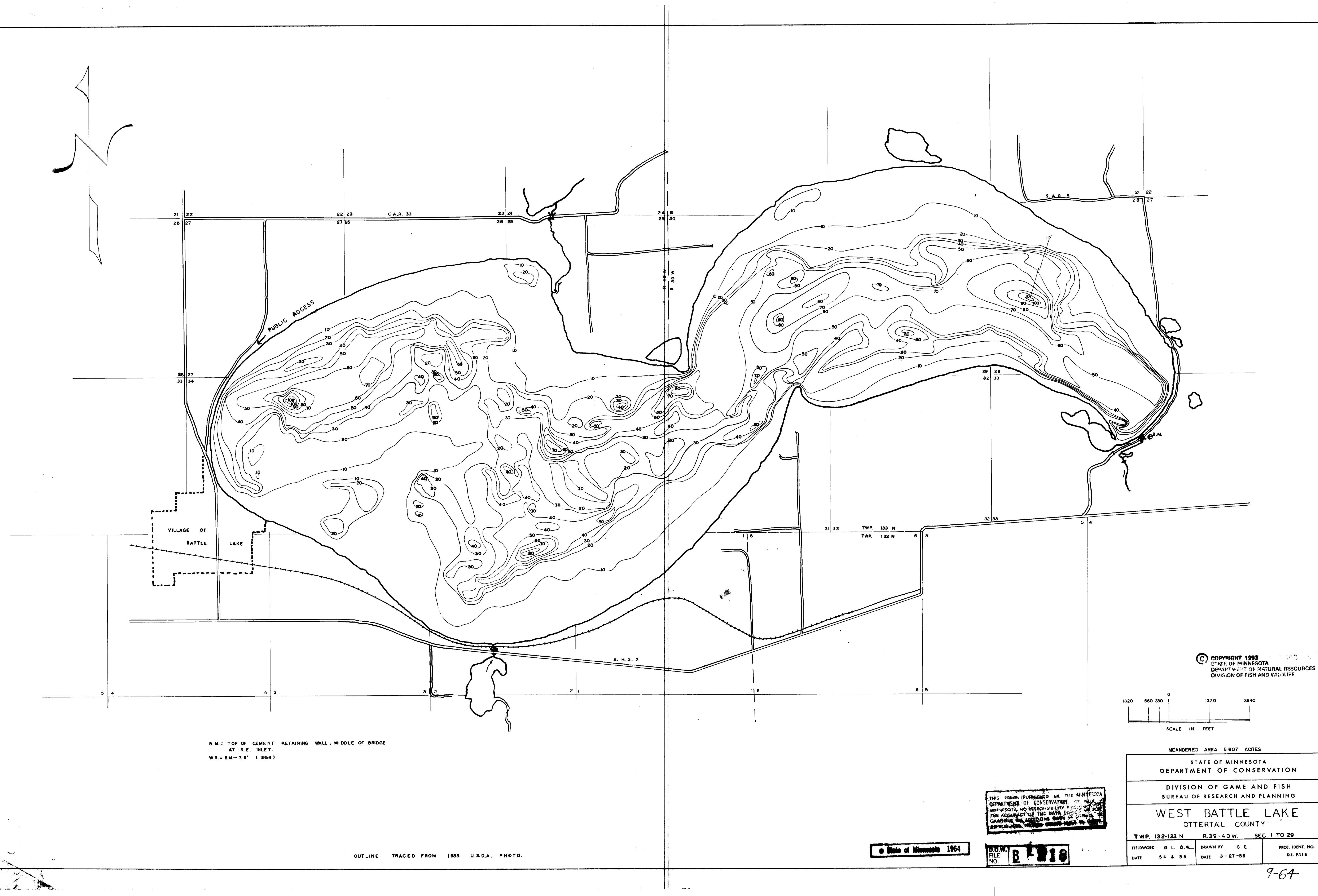
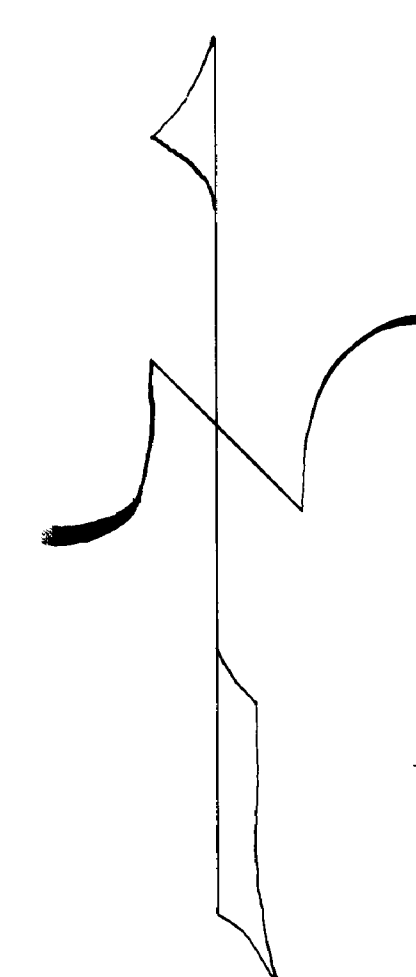

B.M. = TOP OF CEMENT RETAINING WALL, MIDDLE OF BRIDGE AT S.E. INLET.
W.S. = B.M. - 7.6' (1954)

OUTLINE TRACED FROM 1953 U.S.D.A. PHOTO.

© COPYRIGHT 1993
STATE OF MINNESOTA
DEPARTMENT OF NATURAL RESOURCES
DIVISION OF FISH AND WILDLIFE

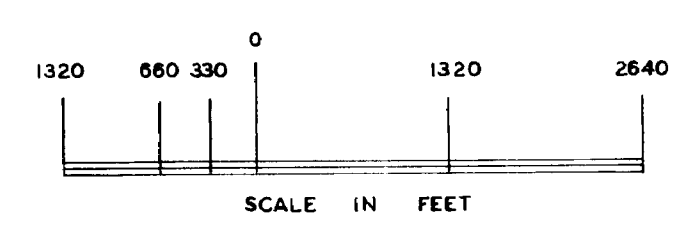

MEANDERED AREA 5 607 ACRES

STATE OF MINNESOTA DEPARTMENT OF CONSERVATION		
DIVISION OF GAME AND FISH BUREAU OF RESEARCH AND PLANNING		
WEST BATTLE LAKE OTTERTAL COUNTY		
TWP. 132-133 N	R. 39-40 W.	SEC. 1 TO 29
FIELDWORK DATE 54 & 55	G. L. D. W. DRAWN BY G. L. DATE 3-27-58	PROJ. IDENT. NO. D.J. F.111-R

THIS MAP, FURNISHED BY THE MINNESOTA DEPARTMENT OF CONSERVATION, IS MADE WITHOUT WARRANTY OF ACCURACY OR LIABILITY. THE STATE OF MINNESOTA, DEPARTMENT OF CONSERVATION, ACCEPTS NO LIABILITY FOR THE ACCURACY OF THE DATA BASED ON WHICH THIS MAP WAS PREPARED. ANY CHANGES OR ADDITIONS MADE BY OTHERS ARE NOT RESPONSIBLE TO THE STATE OF MINNESOTA.

© State of Minnesota 1964

D.D.W. FILE NO. B-818

9-64

12