

- ① FOR SNOWMOBILE TRAILS, MIN. 20'
FOR ATV ONLY TRAILS, MIN 14'
- ② FOR SNOWMOBILE TRAILS, MIN. 16'
FOR ATV ONLY TRAILS, MIN 12' 3
- ③ PLACE ADDITIONAL PIT RUN AS DIRECTED IN THE FIELD. ASSUME AVERAGE OF 3" PIT RUN DEPTH ACROSS SUBGRADE PREPARATION AREA FOR BIDDING PURPOSES.

NEW TRAIL TYPICAL SECTION

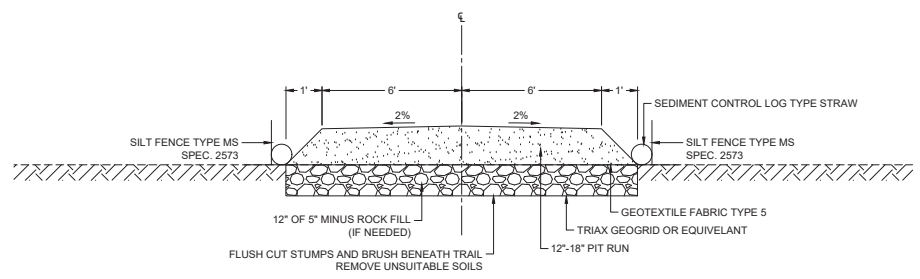

**TYPICAL A WETLAND CROSSING
ATV AND SNOWMOBILE
(14' OVERALL WIDTH)**

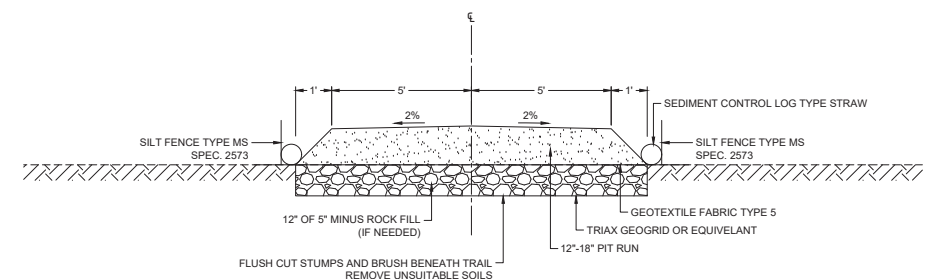

**TYPICAL B WETLAND CROSSING
ATV ONLY
(12' OVERALL WIDTH)**

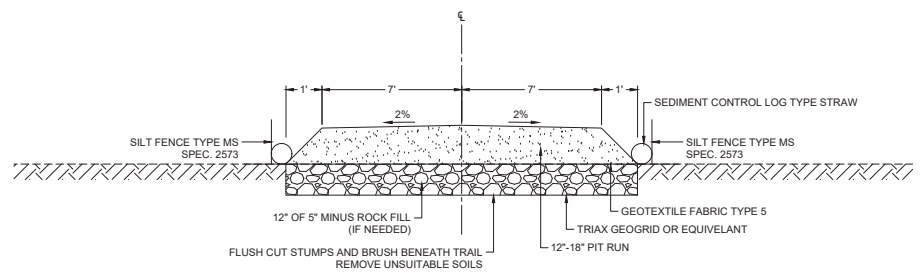

**TYPICAL D WETLAND CROSSING
ATV AND SNOWMOBILE
(16' OVERALL WIDTH)**

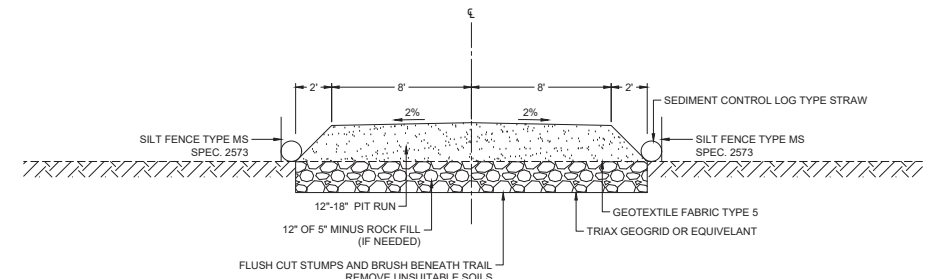

**TYPICAL C WETLAND CROSSING
ATV AND SNOWMOBILE
(20' OVERALL WIDTH)**

S:\03\3172020\457 PM\primary\Proj_3172020_502 PM\KOL\LCH\DT1\446405.dwg:dwg:51:carawangi:10:0:\lead\log\sheet.ctb:446407TY.dwg

DRAWN BY: _____				
DESIGNER: _____				
CHECKED BY: _____				
DESIGN TEAM	NO.	BY	DATE	REVISIONS

PHONE: 218.741.4284
 615 5TH STREET NORTH
 VIRGINIA, MN 55792-3761
 www.sehinc.com

Date: _____ Lic. No. _____

**PROSPECTOR
ATV TRAIL**

TYPICAL SECTIONS

Save: 3/17/2020 4:57 PM mmarvy Plot: 3/17/2020 5:01 PM p:\KOLL\CHDT\144640\5-final-dsgn\51-drawings\10-Civil\cad\dwg\sheet\LC144640DTZ.dwg

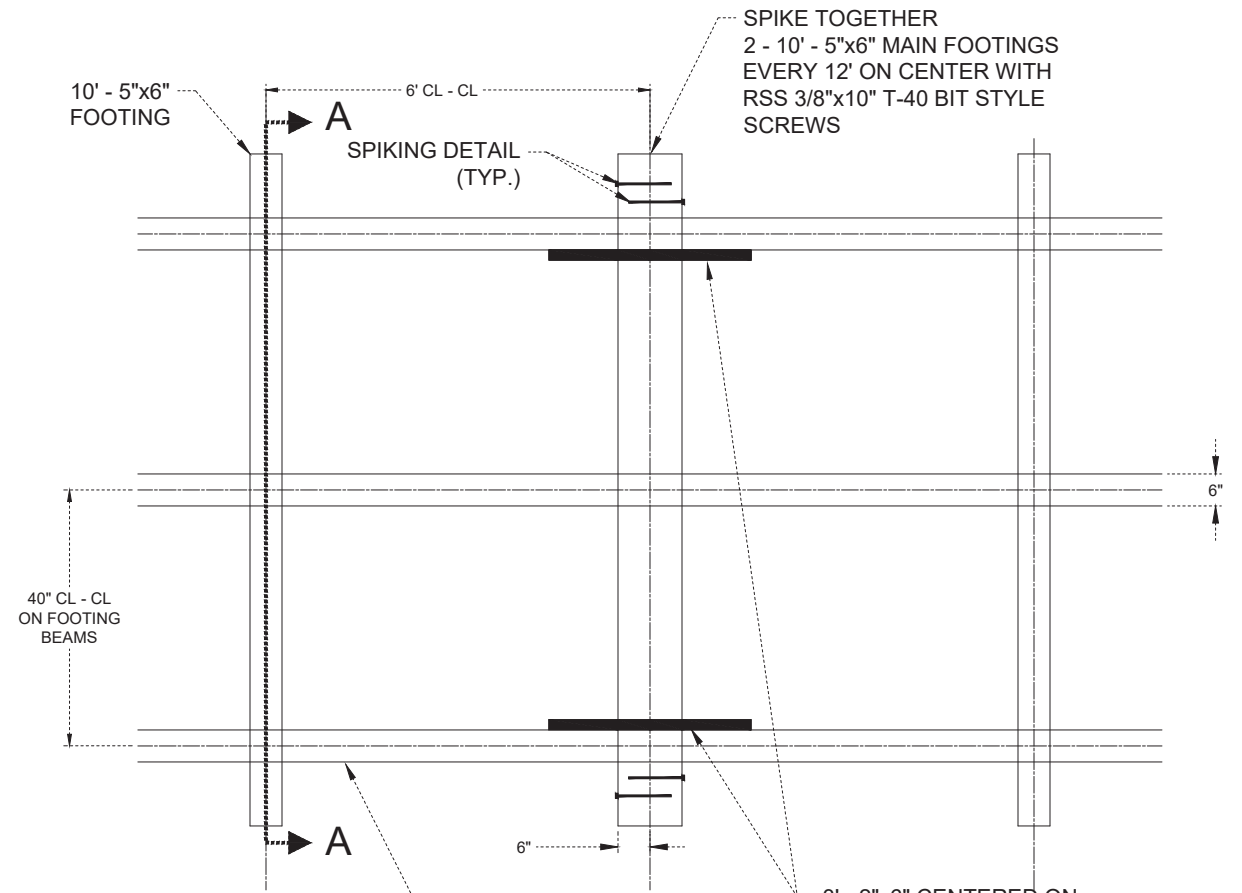

NOTE:

1. ALL LUMBER MATERIALS SUPPLIED BY OWNER.
2. CONTRACTOR TO PROVIDE ALL LABOR AND EQUIPMENT TO TRANSPORT MATERIAL TO THE CONSTRUCTION SITE. APPROXIMATELY 50% OF THE MATERIAL IS LOCATED AT DNR FACILITY IN TOWER AND 50% OF MATERIAL IS LOCATED AT THE CITY GARAGE IN BABBITT.

PUNCHEON DETAIL

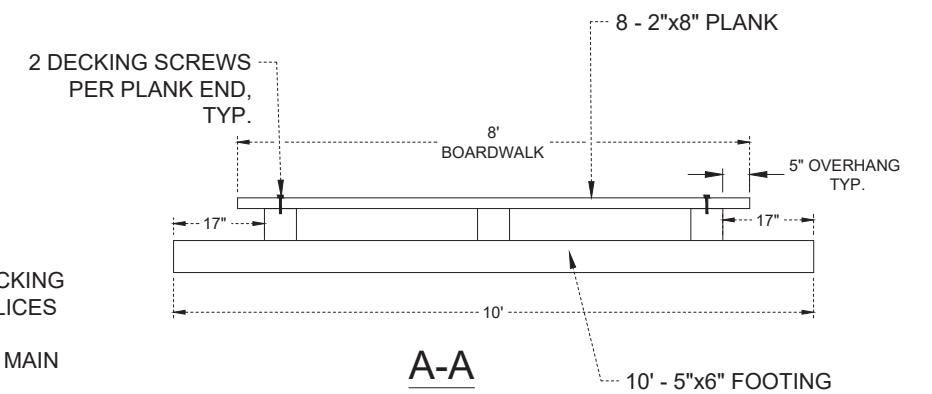

FASTENER SCHEDULE (PER 12' SECTION)

- 68 - 2 1/2" (T-25 BIT) DECK SCREWS FOR DECKING
- 20 - 2 1/2" (T-25 BIT) DECK SCREWS FOR SPLICES
- 2 - 10' X 3/8" (T-40 BIT) FOR SPIKING
- 18" 10' X 3/8" (T-40 BIT) SCREWS TO FASTEN MAIN FOOTING TO DECK STRINGERS

BOARDWALK DETAIL

DRAWN BY:				
DESIGNER:				
CHECKED BY:				
DESIGN TEAM	NO.	BY	DATE	REVISIONS

PHONE: 218.741.4284
615 9TH STREET NORTH
VIRGINIA, MN 55792-3761
www.sehinc.com

I HEREBY CERTIFY THAT THIS PLAN WAS PREPARED BY ME OR UNDER MY DIRECT SUPERVISION AND THAT I AM A DULY LICENSED PROFESSIONAL ENGINEER UNDER THE LAWS OF THE STATE OF MINNESOTA.

Jan Chy
Date: 03/13/2020 Lic. No. 52865

**PROSPECTOR
ATV TRAIL**

CONSTRUCTION DETAILS

FILE NO.
LCHDT 144640

4
36