

STATE
SW-SW

O. I. M. CO.
SE-SW

SW-SE

SE-SE

MEADOW
LOT 4

MEADOW
LOT 3

FOWLER
LOT 2

FOWLER
LOT 1

SHAFT

D SHAFT

HIGHWAY

NO.

MEADOW RES.

MEADOW
SW-NE

FOWLER
SE-NE

O. I. M. CO.
SW-NW

SE-NW

STATE

TRUNK

3

T58N R15W

CAVE

ST. JAMES
YARDS
D.M. & I.R. RY.

OLIVER RESERVE
NW-SW

ST. JAMES

NE-SW
OPEN PIT

OLIVER RESERVE

NW-SE

O. I. M. CO.
NE-SE

MEADOW & FOWLER MINES

EXPLORATION

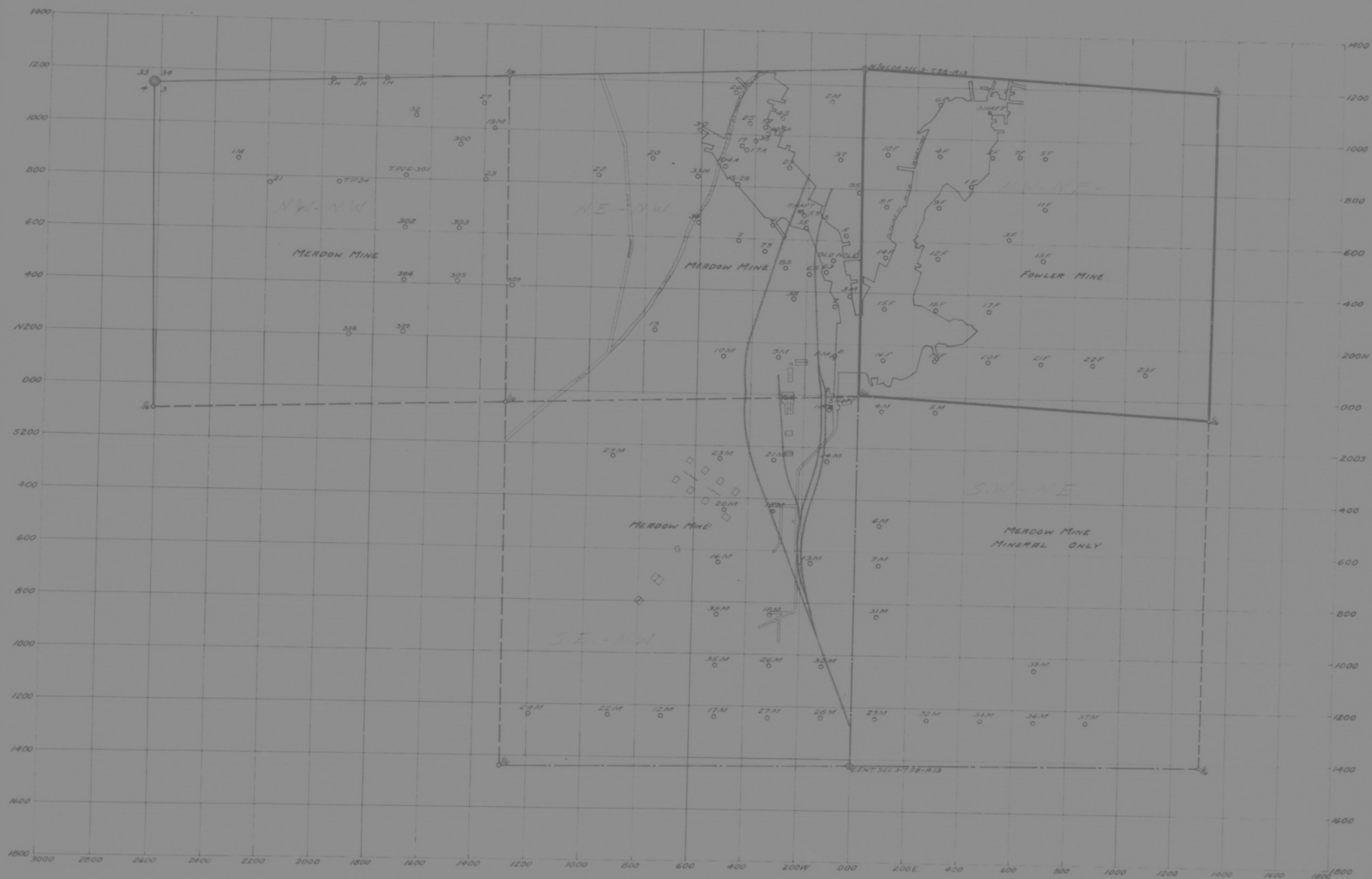
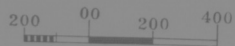

MEADOW & FOWLER MINES

EXPLORATION

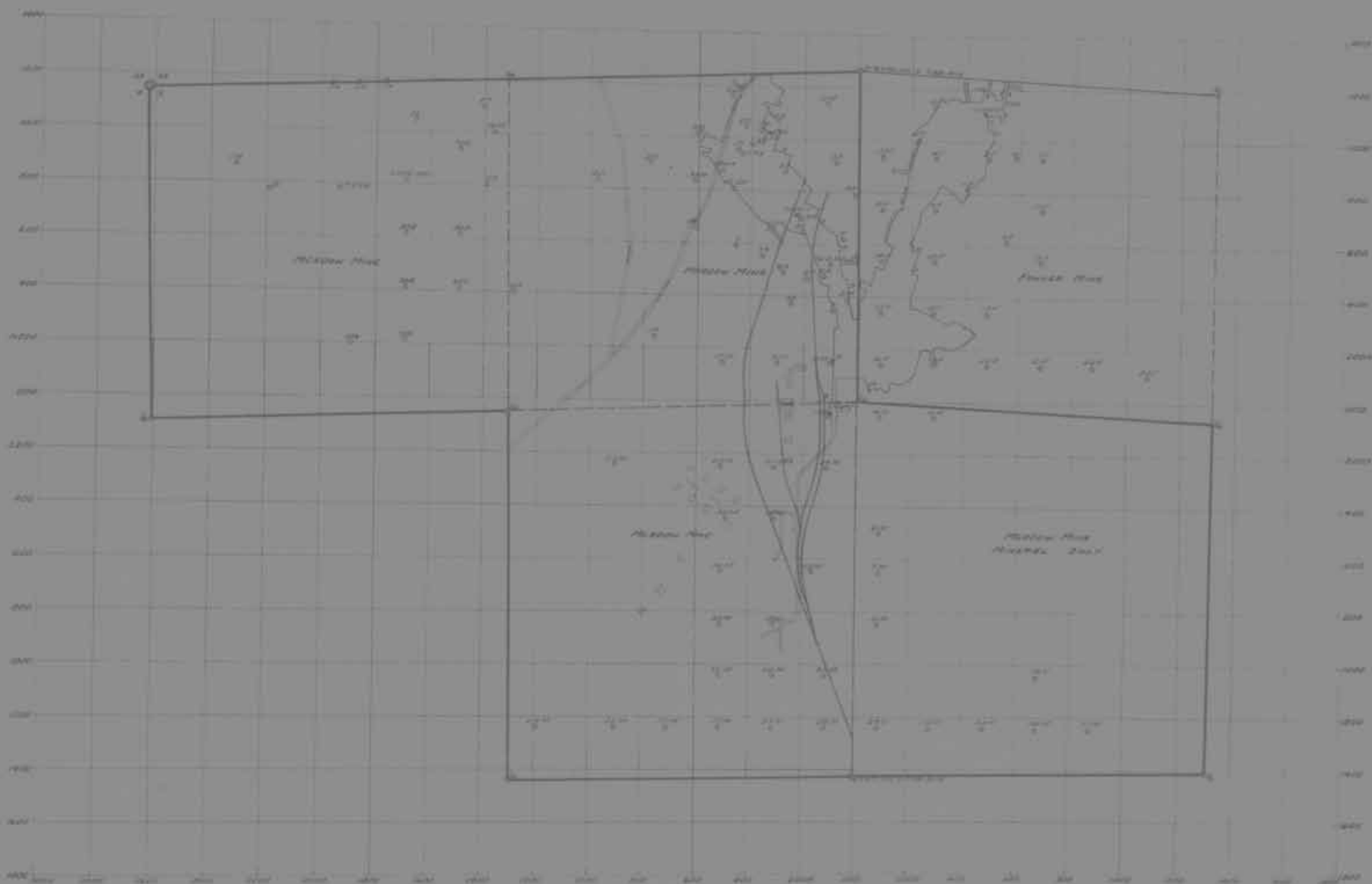

MEADOW-FOWLER MINE

1000 FEET SURFACE

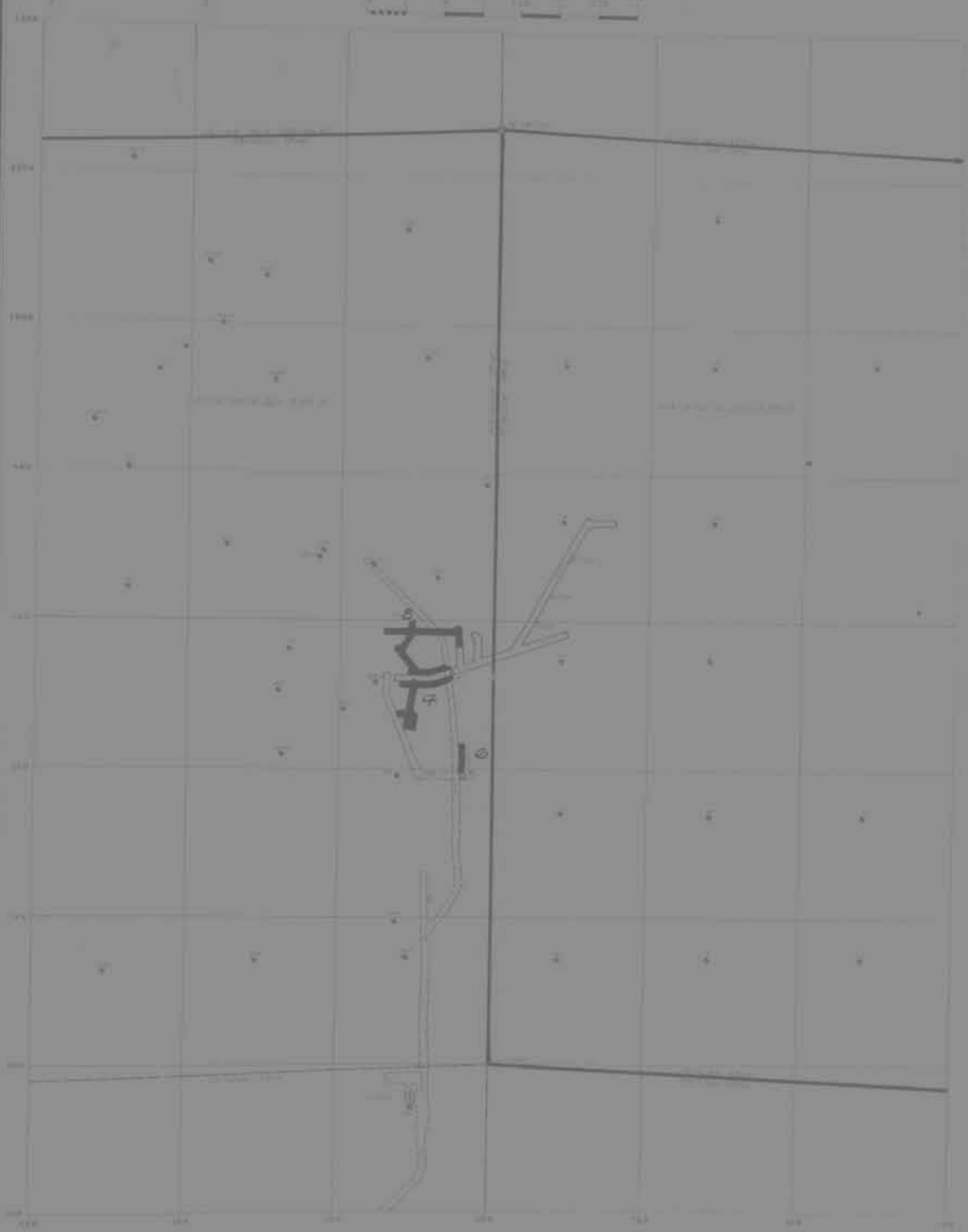

MEADOW-FOWLER MINE

1320 FOOT SUB LEVEL

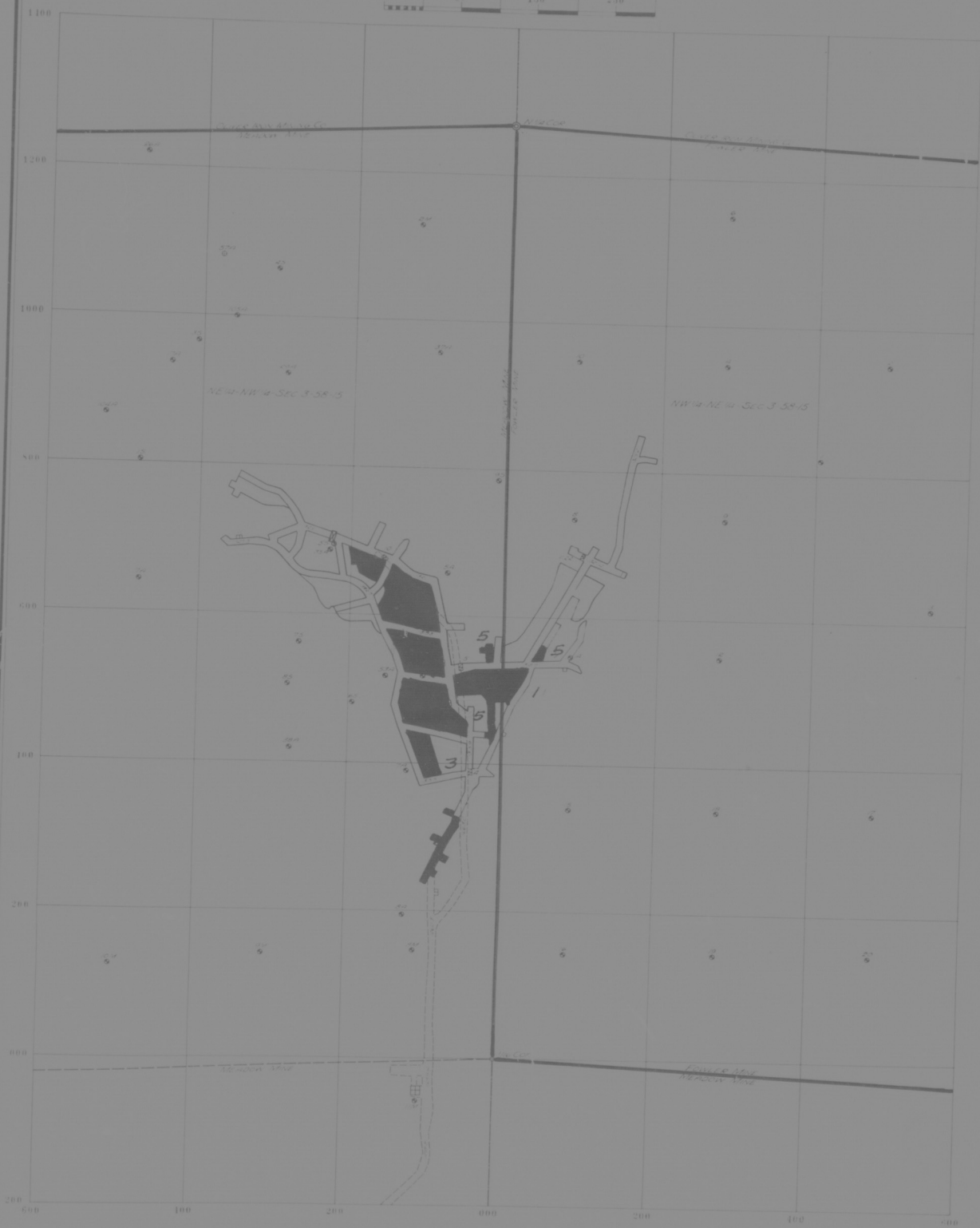
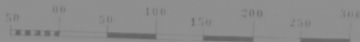

MEADOW-FOWLER MINE

1330 FOOT SUB LEVEL

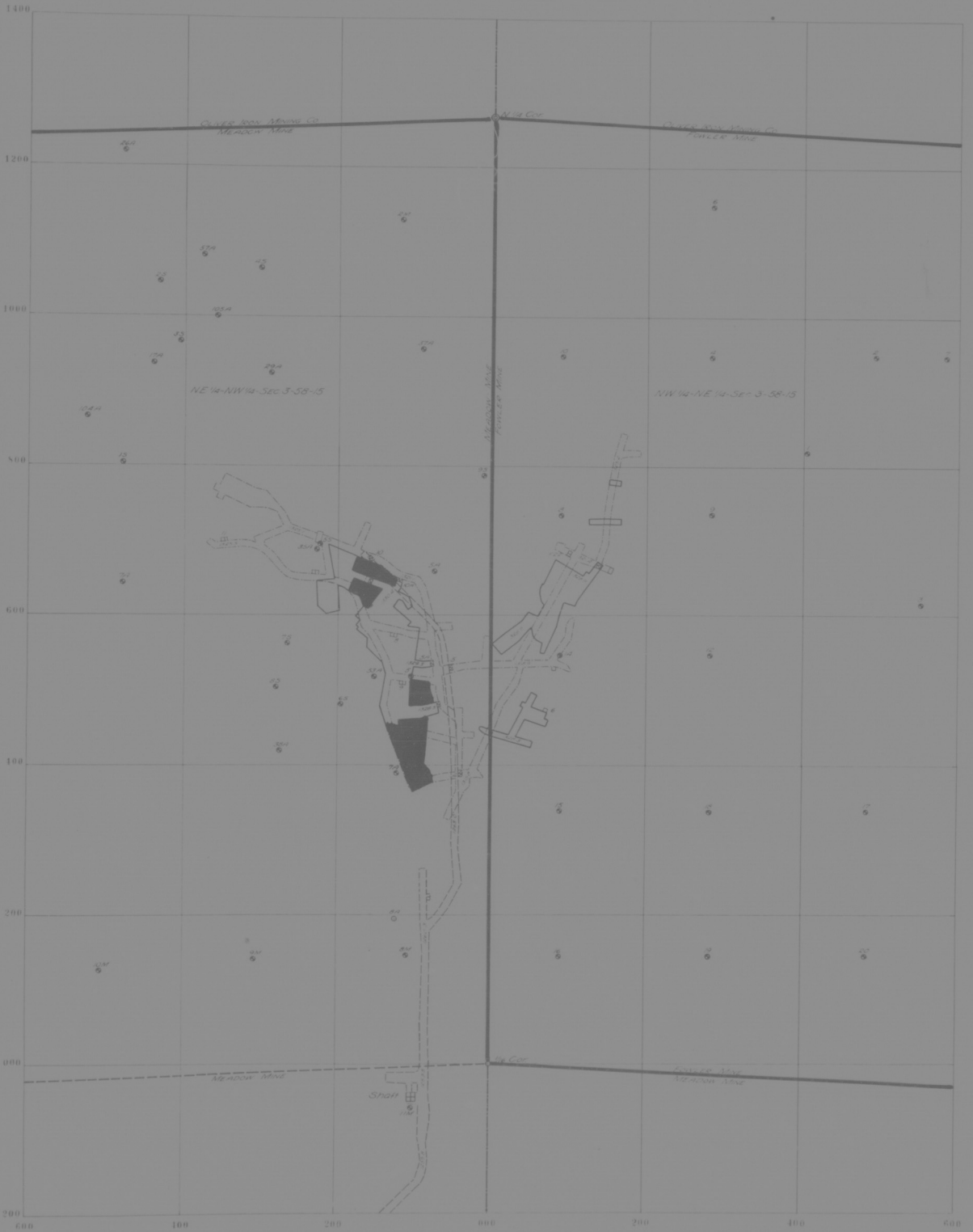
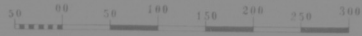

MEADOW MINE

1880 LEVEL



MEADOW MINE

1340 LEVEL

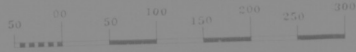

MEADOW MINE

1840 LEVEL

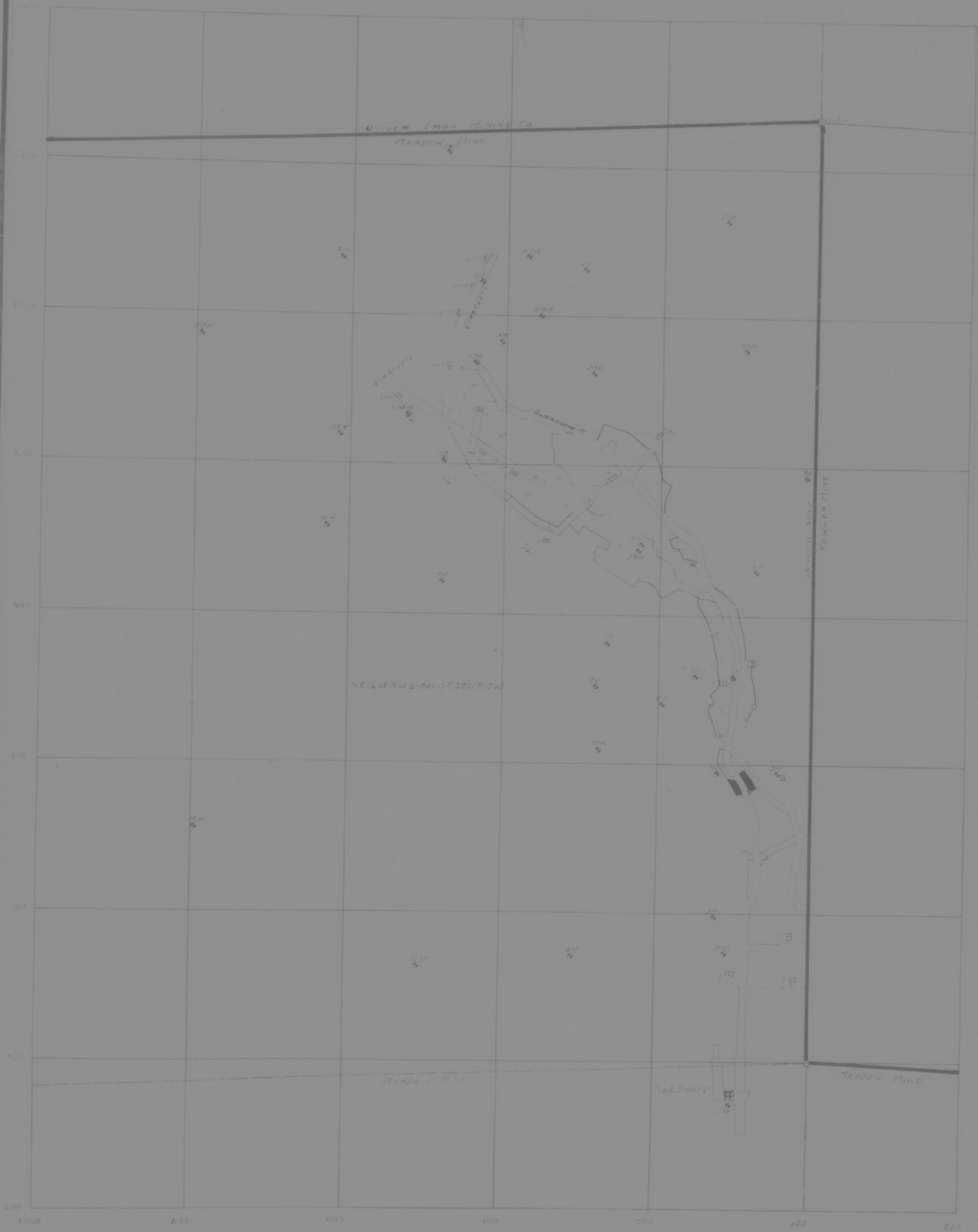
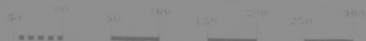

MEADOW MINE

1365 LEVEL

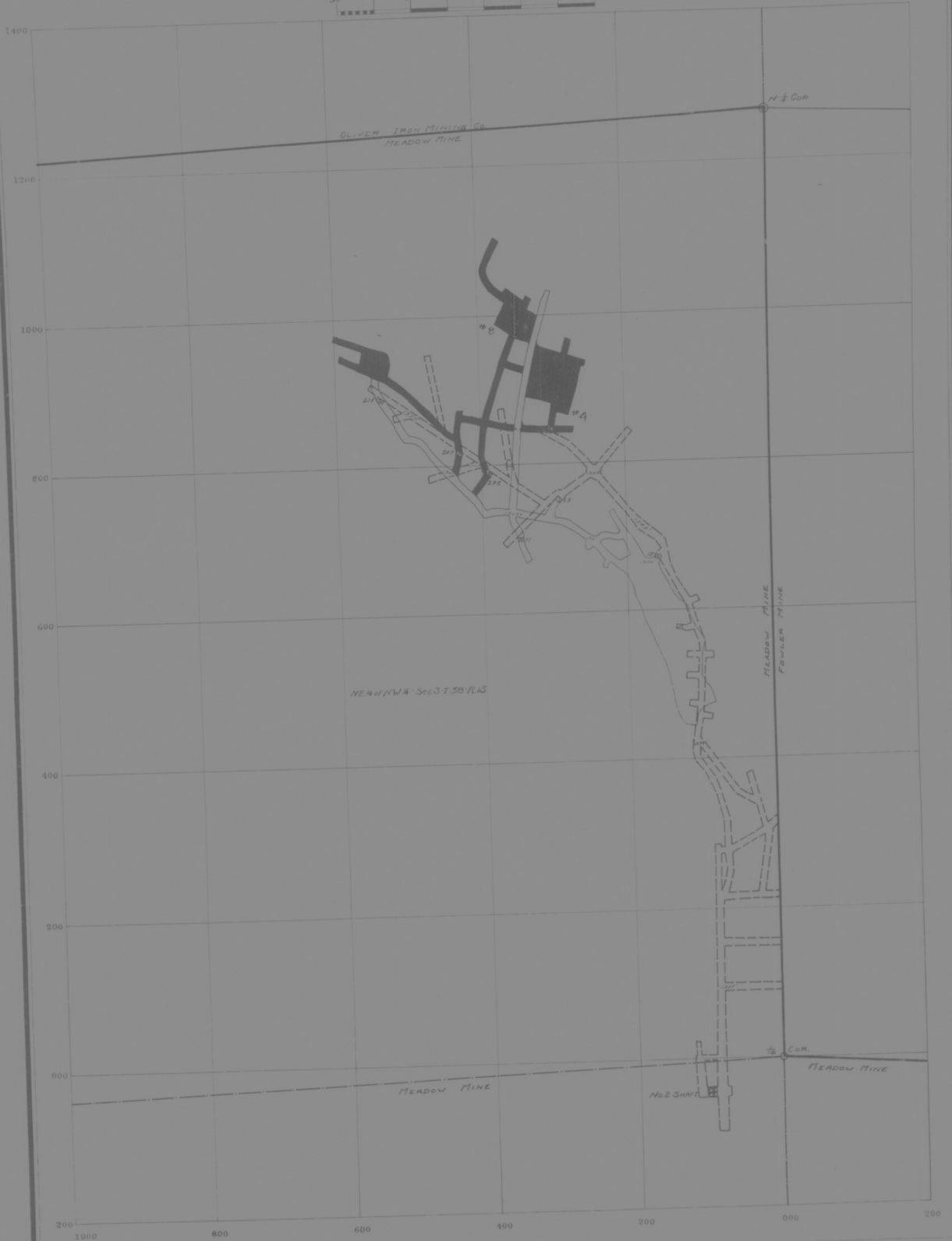
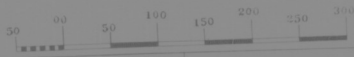

MEADOW MINE

1365 LEVEL

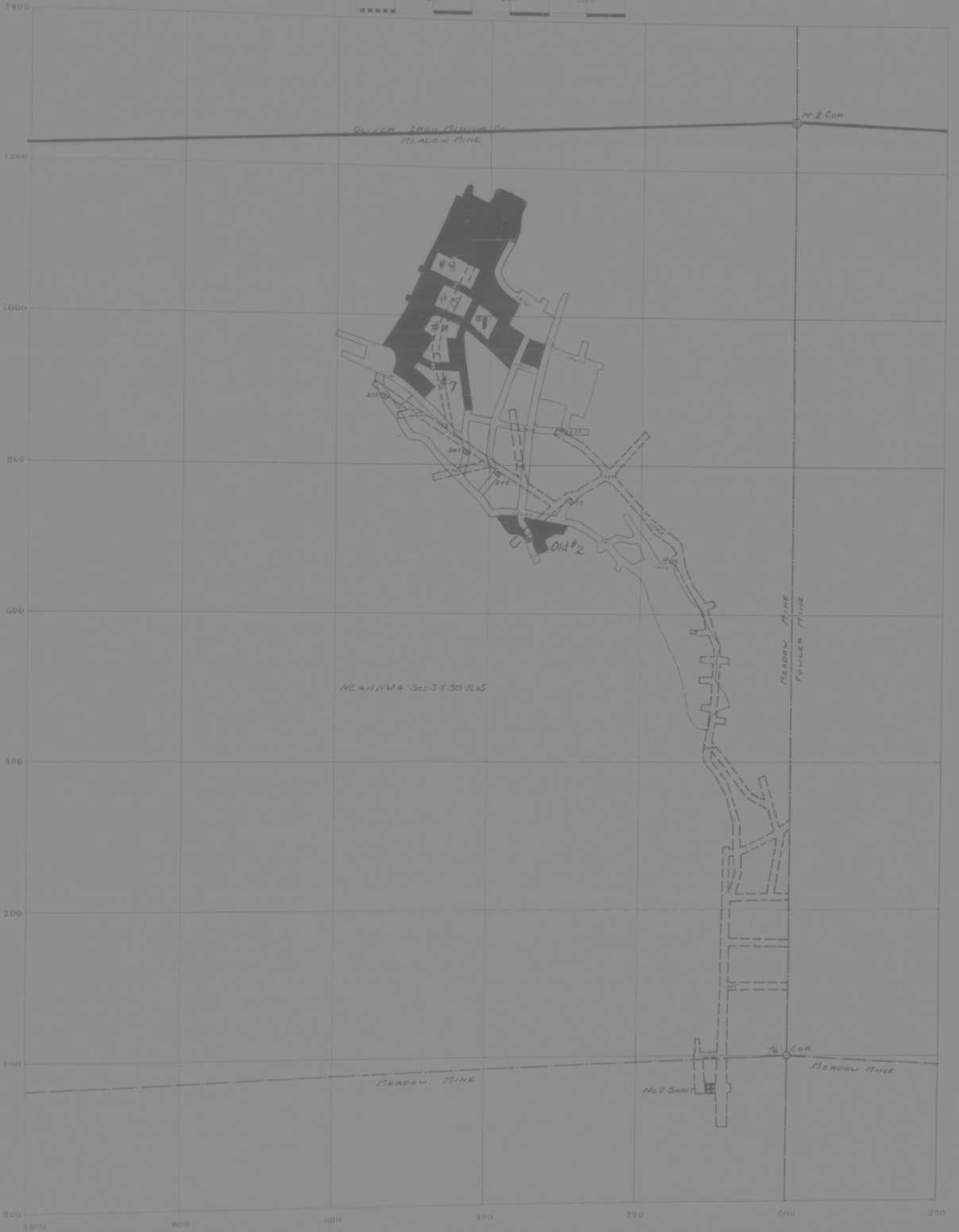
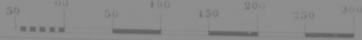

MEADOW MINE

1385 LEVEL

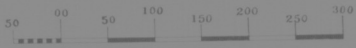

MEADOW MINE

1385 LEVEL

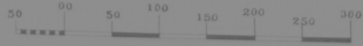

MEADOW MINE

1335 LEVEL.

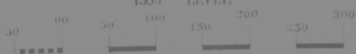

MEADOW MINE

1395 LEVEL

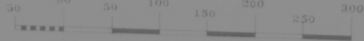

MEADOW MINE

NO. 0152

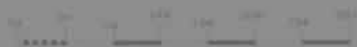

MEADOW MINE

1410 LEVEL

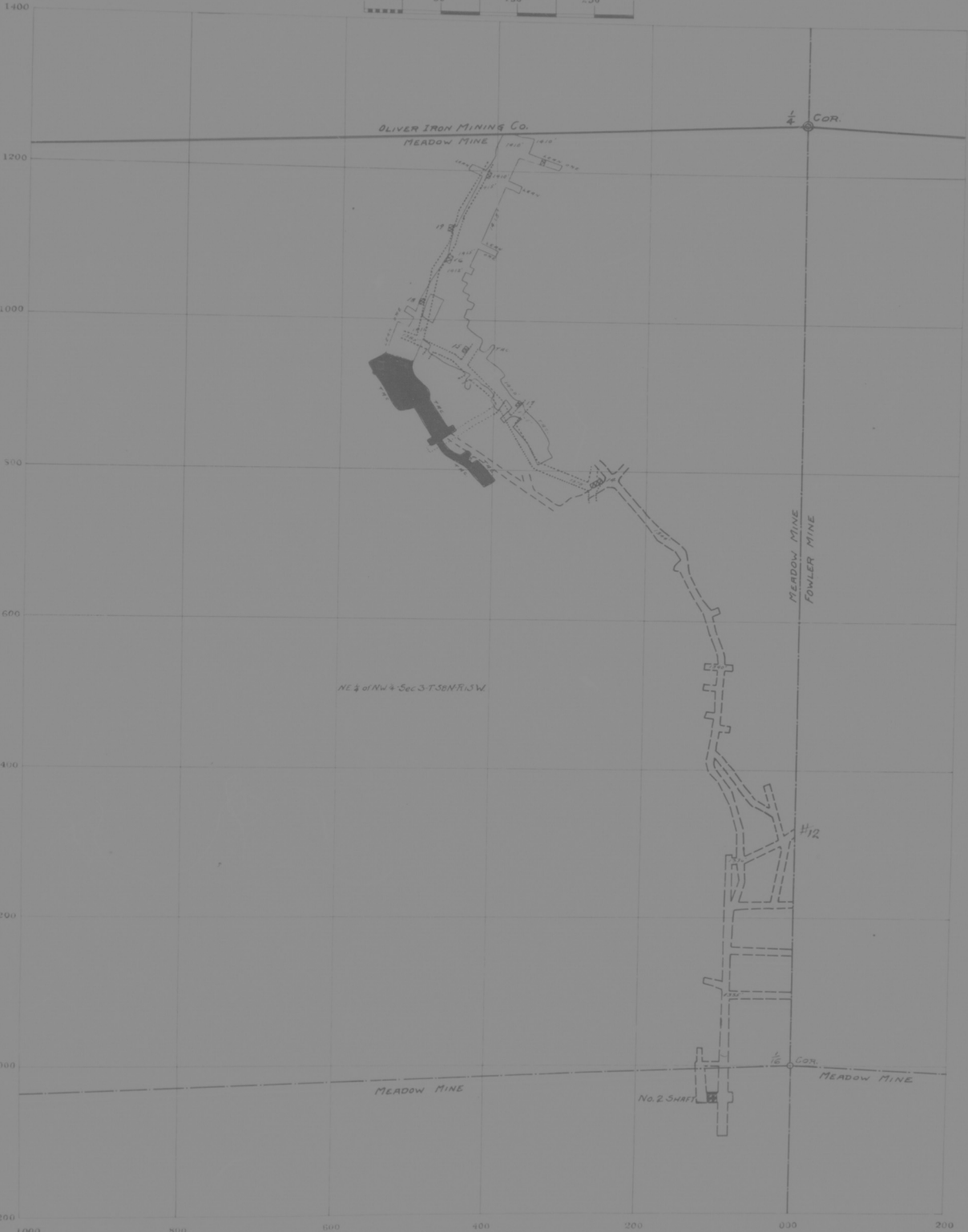
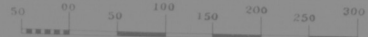

OLIVER IRON MINING CO.
MEADOW MINE

$\frac{1}{4}$ COR.

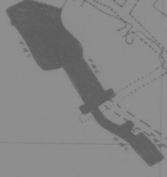

NE $\frac{1}{4}$ of NW $\frac{1}{4}$ Sec 3-T.56N-R.3W

MEADOW MINE
FOWLER MINE

H/12

MEADOW MINE

No. 2 SHAFT

$\frac{1}{2}$ COR.

MEADOW MINE

MEADOW MINE

E. 1/2 OF NW 1/4 OF SEC. 3 T. 58 N. R. 15 W.

50 100 150 200 250 300



MEADOW MINE

E. 1/2 OF NW. 1/4 OF SEC. 3 T. 98 N. R. 14 W.

50 00 50 100 150 200 250 300



MEADOW MINE

OF SEC. 3 T. 98 N. R. 14 W.

MEADOW MINE SURFACE

