

ELBA NO. 2 RES.
NW-SW

ELBA NO. 1 RES.
NE-SW

ELBA NO. 2 RES.
SW-SW

ELBA NO. 1 RES.
SE-SW

MALTA
NW-NW

R-F.M.D
NE-NW

MALTA
SW-NW

JARVIS
SE-NW

R-F.M.D
LOT 2

LUUKANEN
NE-SW

PETERSON'S
BEACH

VIL. OF GILBERT
PUMP HOUSE

35

T58N R17W

SPARTA
E-SE

68
72
76
80
84
88
92
96
100
104
108
112
116
120
124
128
132

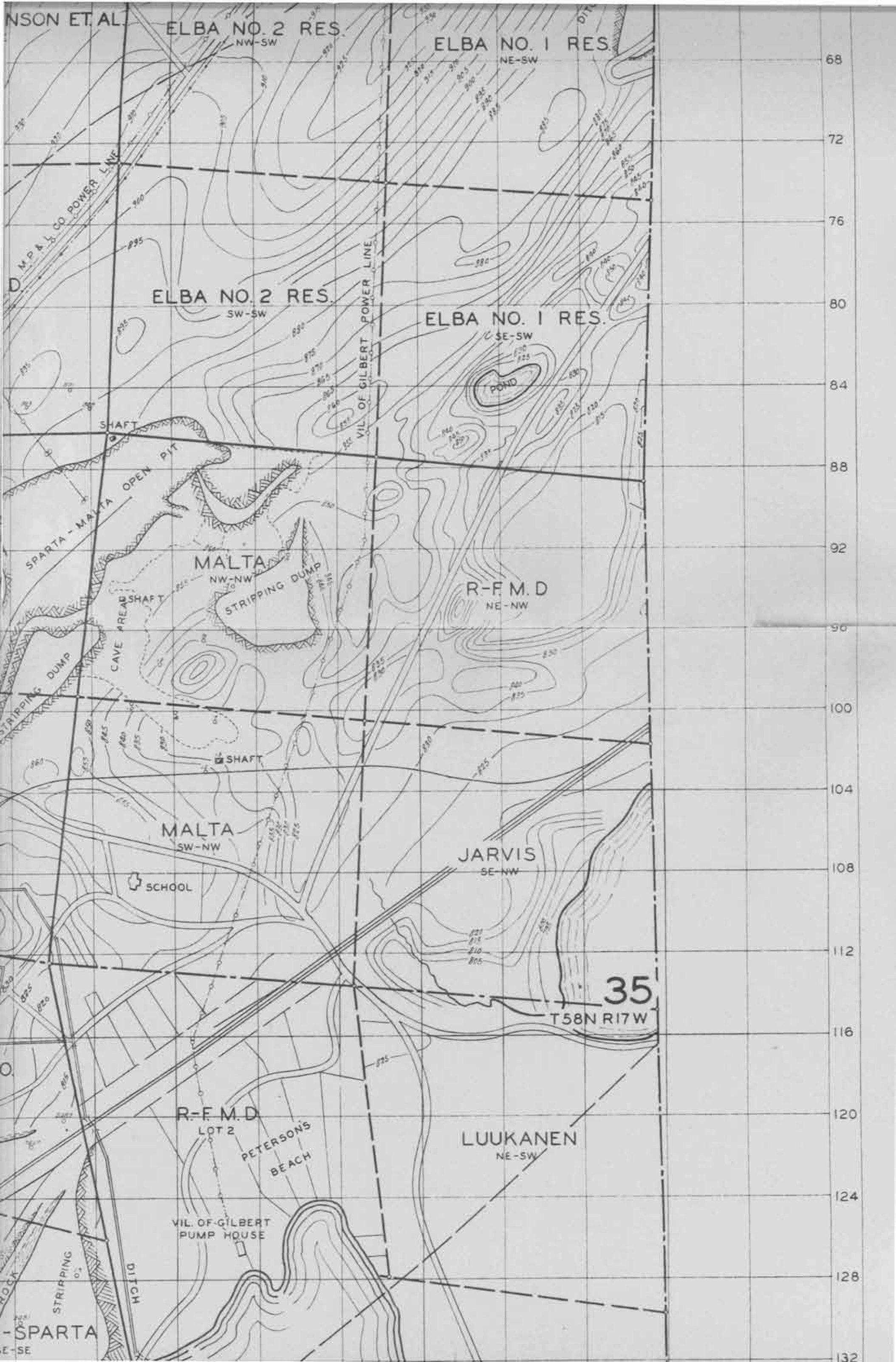

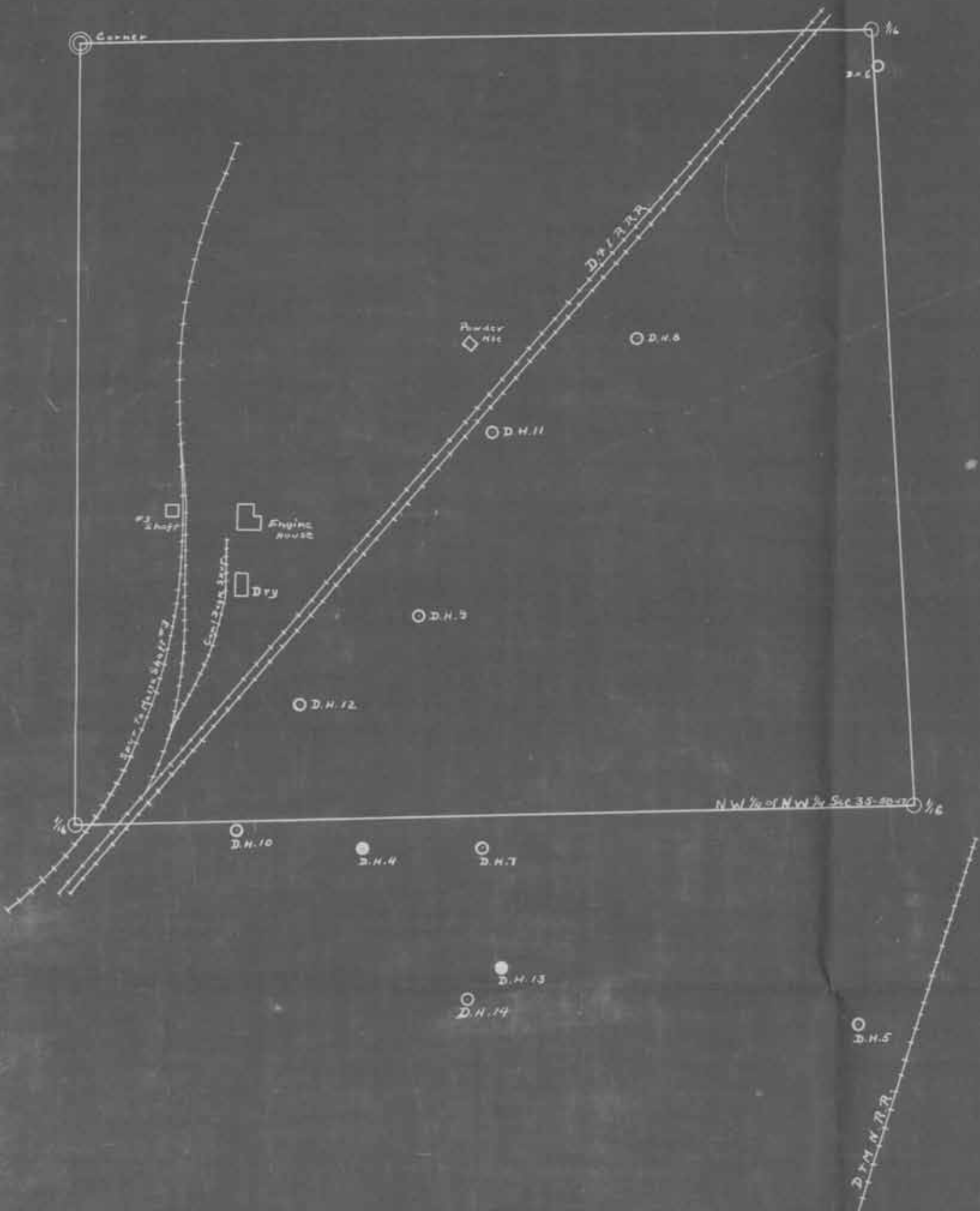

No. Plans	Sq Ft	Ht	Cu Yds	Tons	Iron	Free Man	Silica
1	1,100	21.140	2,325	1,200			
2	375	13.120	4,920	2,500	41.37	0.50	7.10
3	20	18.100	357	180			
Total		15,000	3,000	3,700	0.00		
Average		18.010					

NO. 4 MALTA ESTIMATE MAP

SCALE 1"=40'

DEC 4 1911

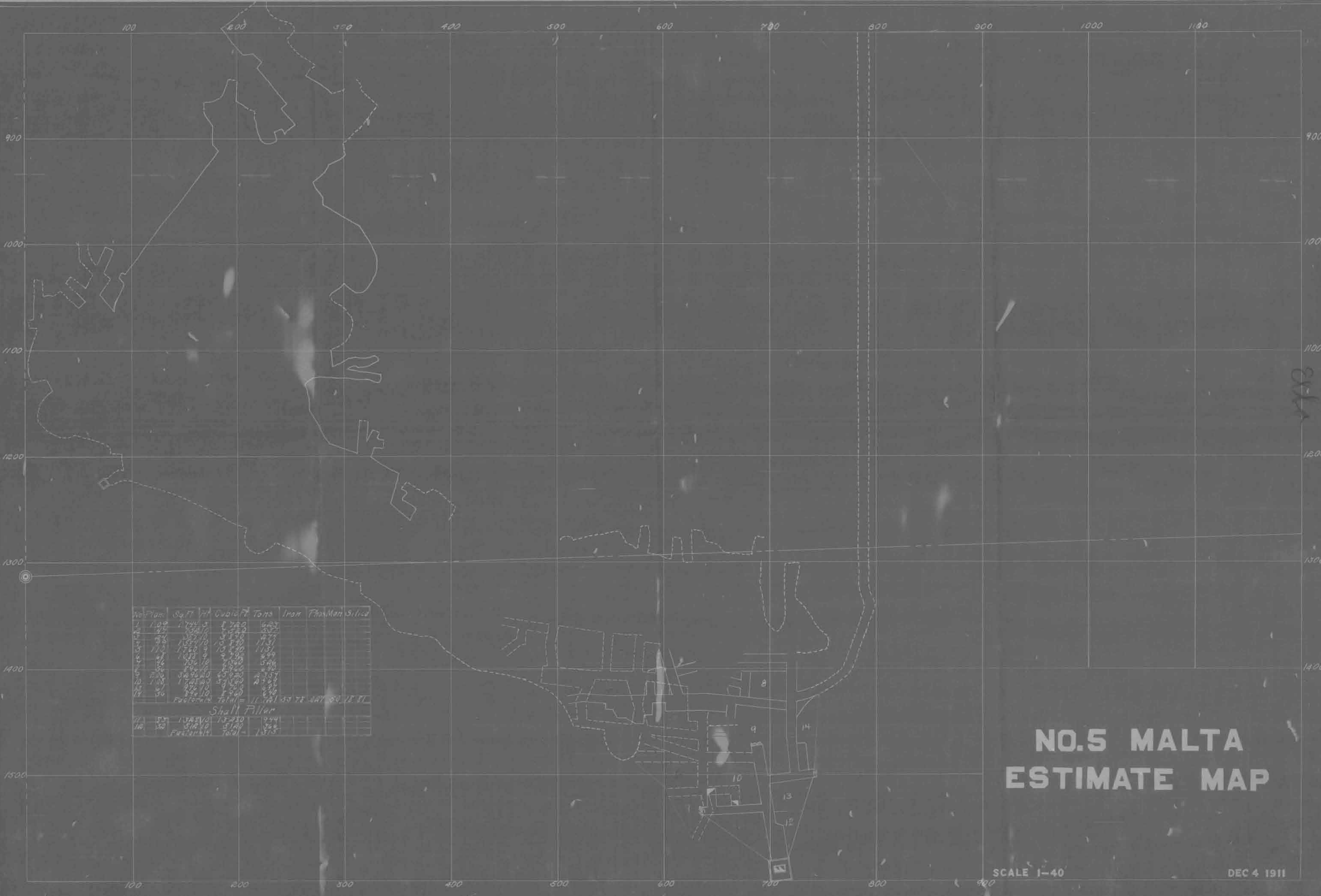

No	Plan	Sq. Ft.	Ht.	Cu. Ft.	Tons	Iron	Phos	Man	Silica
1	1109	11740	3	35220	1623				
2	1110	10080	3	30240	1372				
3	1111	10080	3	30240	1372				
4	1112	10080	3	30240	1372				
5	1113	10080	3	30240	1372				
6	1114	10080	3	30240	1372				
7	1115	10080	3	30240	1372				
8	1116	10080	3	30240	1372				
9	1117	10080	3	30240	1372				
10	1118	10080	3	30240	1372				
11	1119	10080	3	30240	1372				
12	1120	10080	3	30240	1372				
13	1121	10080	3	30240	1372				
14	1122	10080	3	30240	1372				
FACILITIES					Total = 11,740 33 75 887 30 12.11				
SHALL FILL									
15	1123	10080	3	30240	1372				
16	1124	10080	3	30240	1372				
FACILITIES					Total = 1375				

NO.5 MALTA ESTIMATE MAP

SCALE 1-40

DEC 4 1911



NO.4 MALTA

Red work done during April 1973

SCALE 1-40





NO. 5 MALTA

EL. V SHAFT COLLAR — 440.4
 MAIN LEVEL — 198.0

Plan of No. 5 Malta Mine after Nov. 1, 1911.

SCALE 1-40



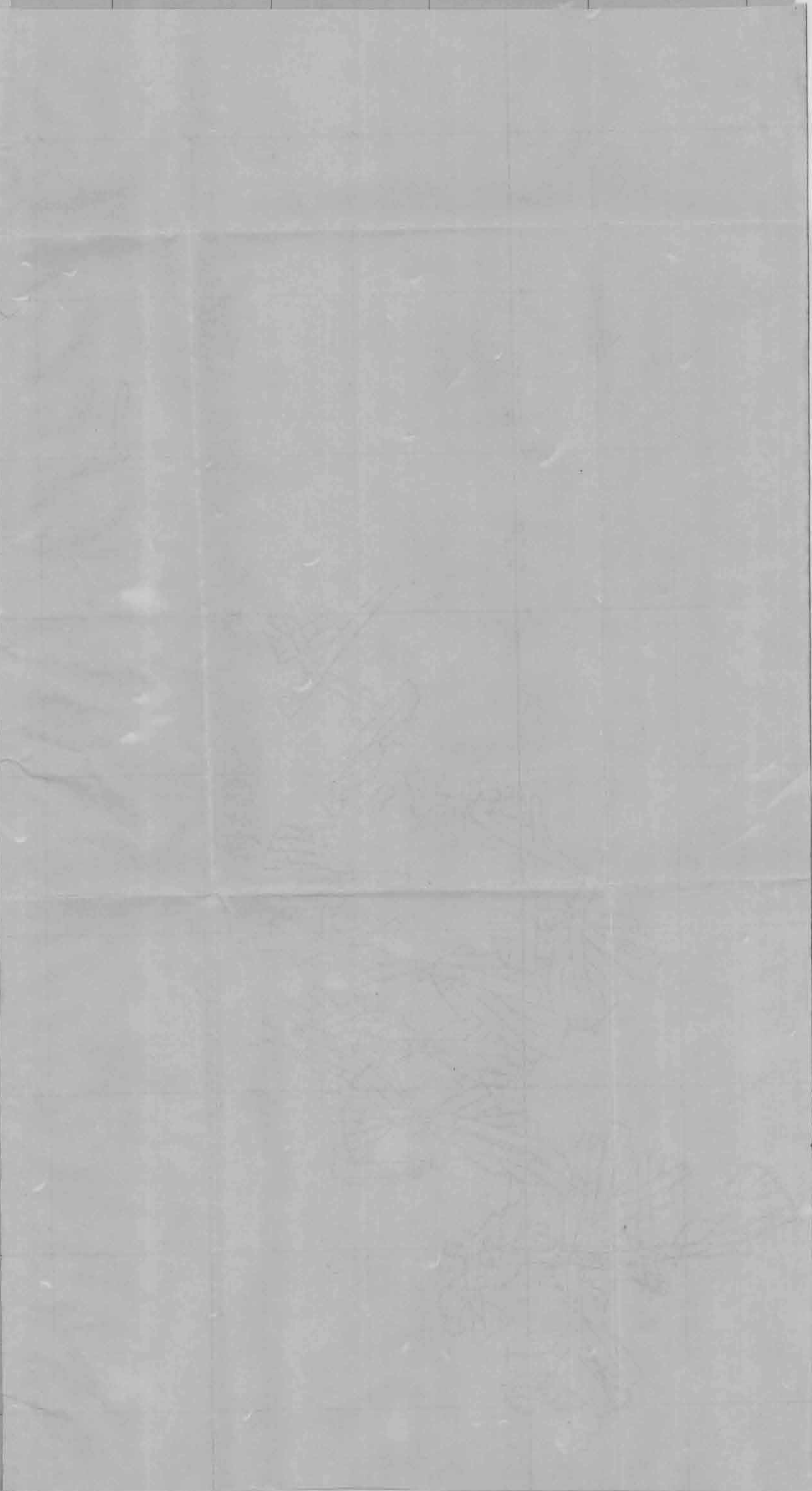
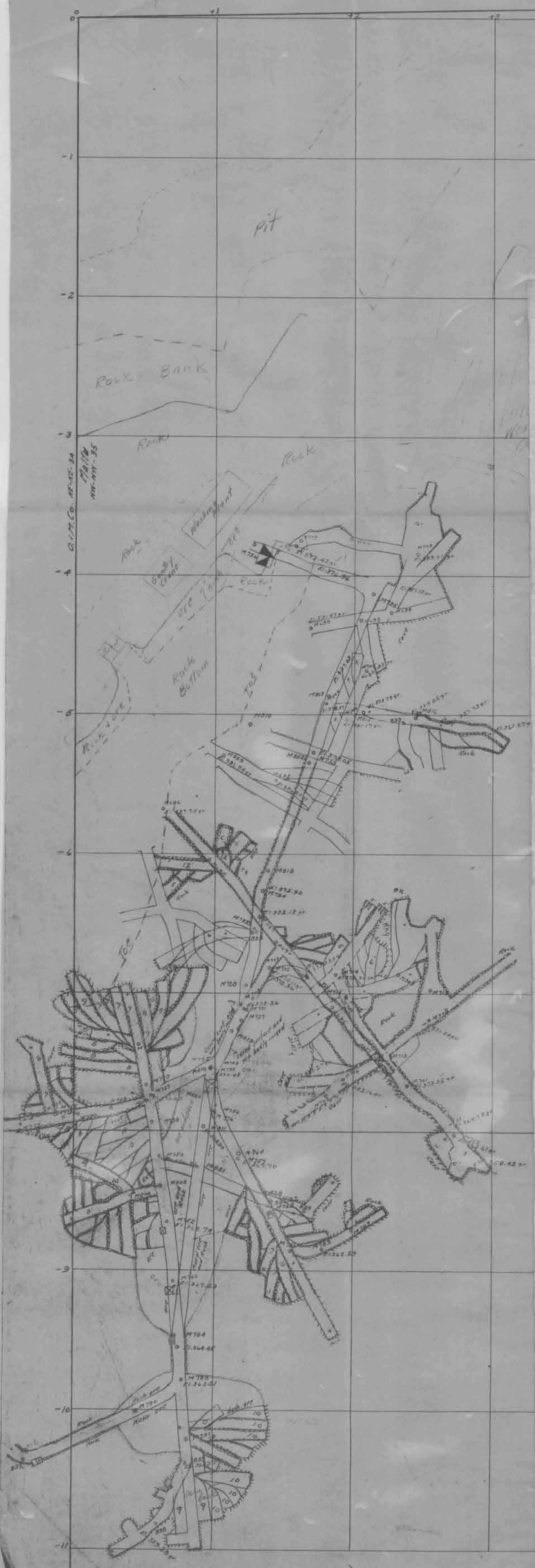

0
-1
-2

1 2 3 4 5 6 7

pit

1/4 Sec 34
NW 1/4 NW 35

0.127 Co.
190/14

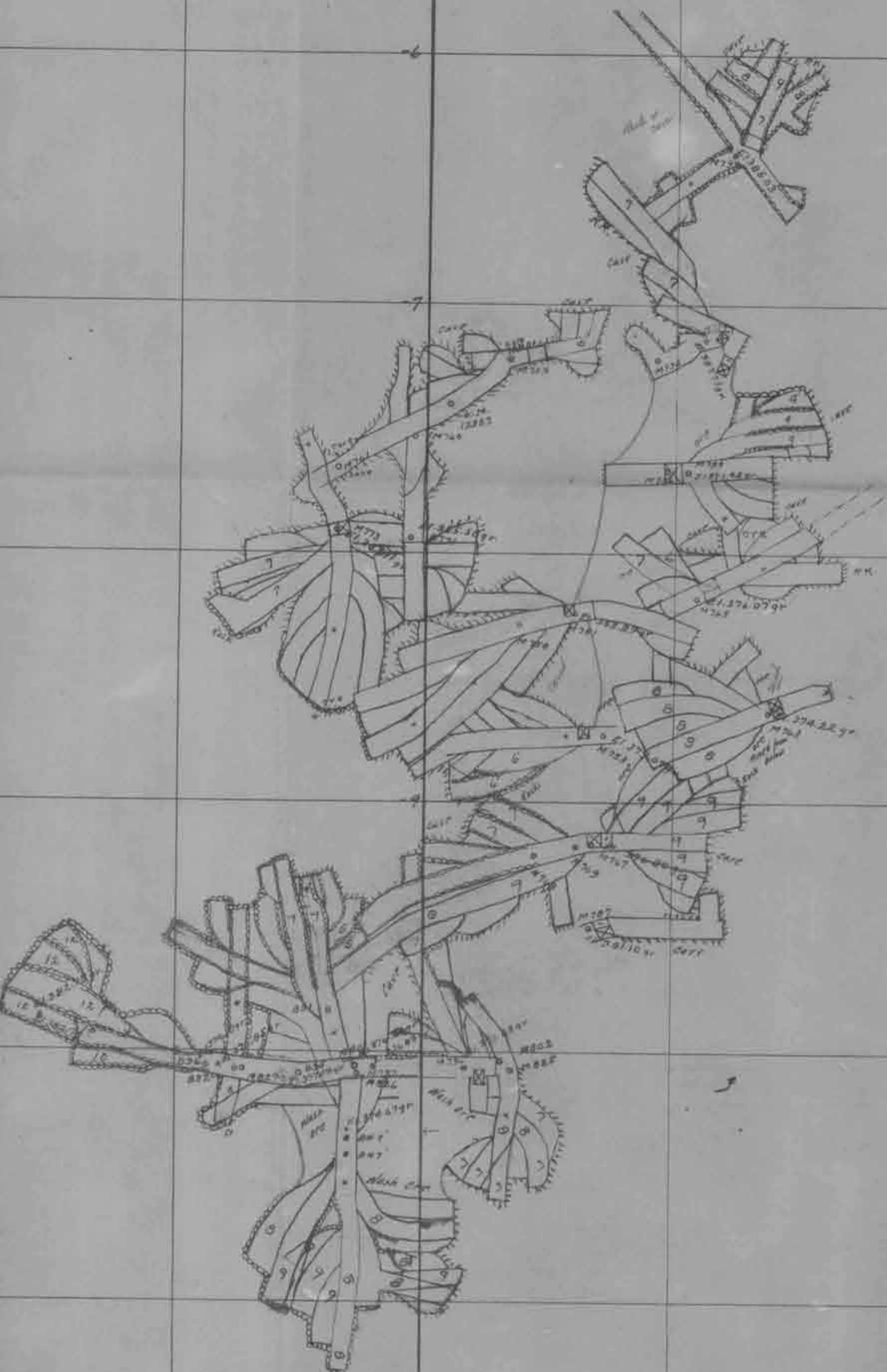

Malta Mine
NW NW 35-58-17
Scale 40' = 1"

Oct. 16, 1936.

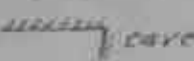
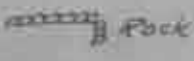
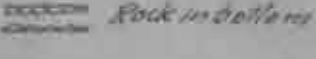
Legend:
 cave
 rock
 rock in dollars

Approx 7,000 feet in 115 pillars
 3,000 feet in Working West Branch.

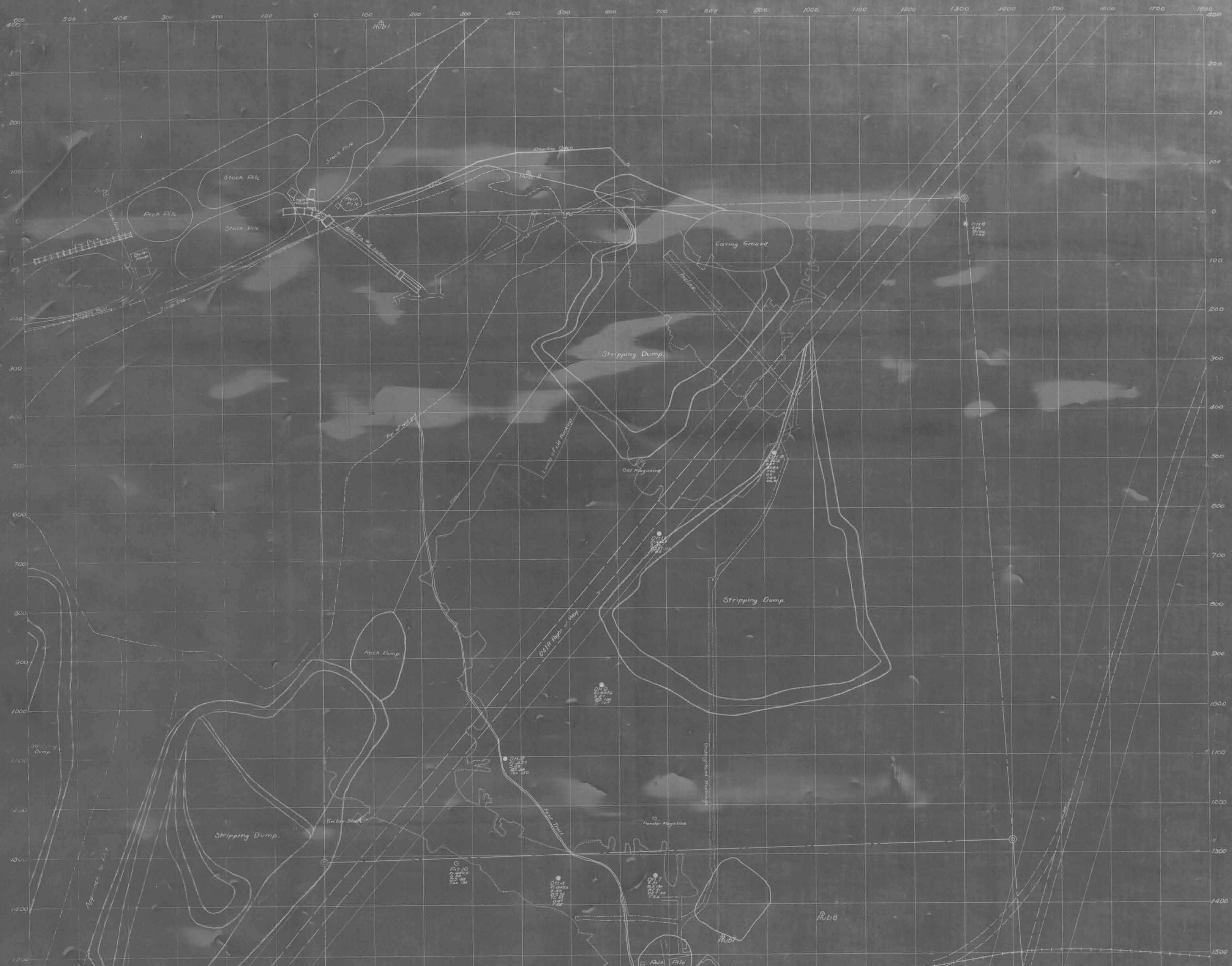



MALTA MINE SURFACE MAP

WEST 1-2 OF NW 1-4 SEC 35 T58N R1 W

- LEGEND
- DRILL HOLES
 - PITS
 - ⊕ PERMANENT HUBS
 - RAILROADS

SCALE 1"=80'

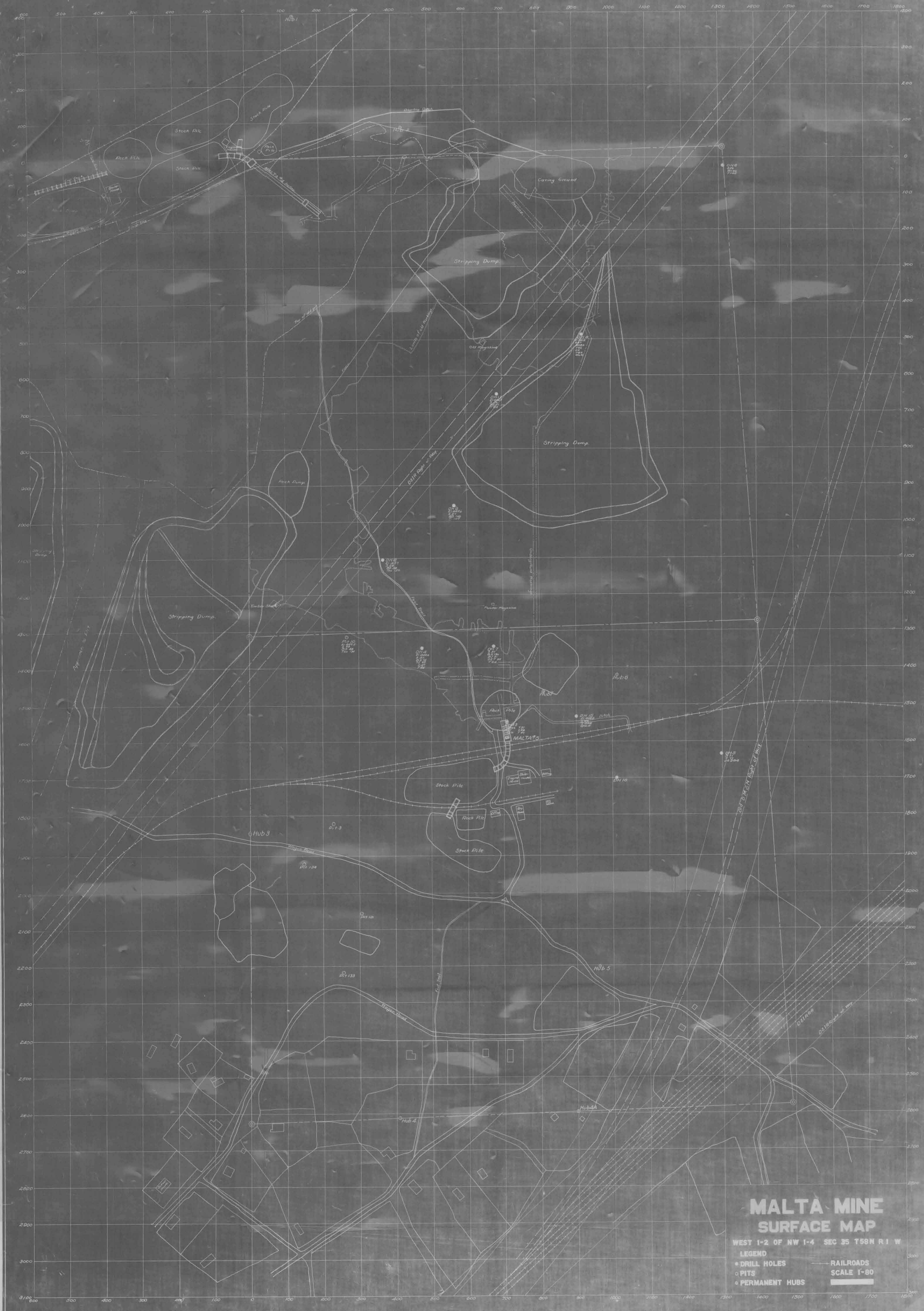

MALTA MINE SURFACE MAP

WEST 1-2 OF NW 1-4 SEC 35 T58N R1 W

- LEGEND
- DRILL HOLES
 - PITS
 - ◐ PERMANENT HUBS
 - RAILROADS

SCALE 1"=80'



NORTH BOUNDARY LINE ↘

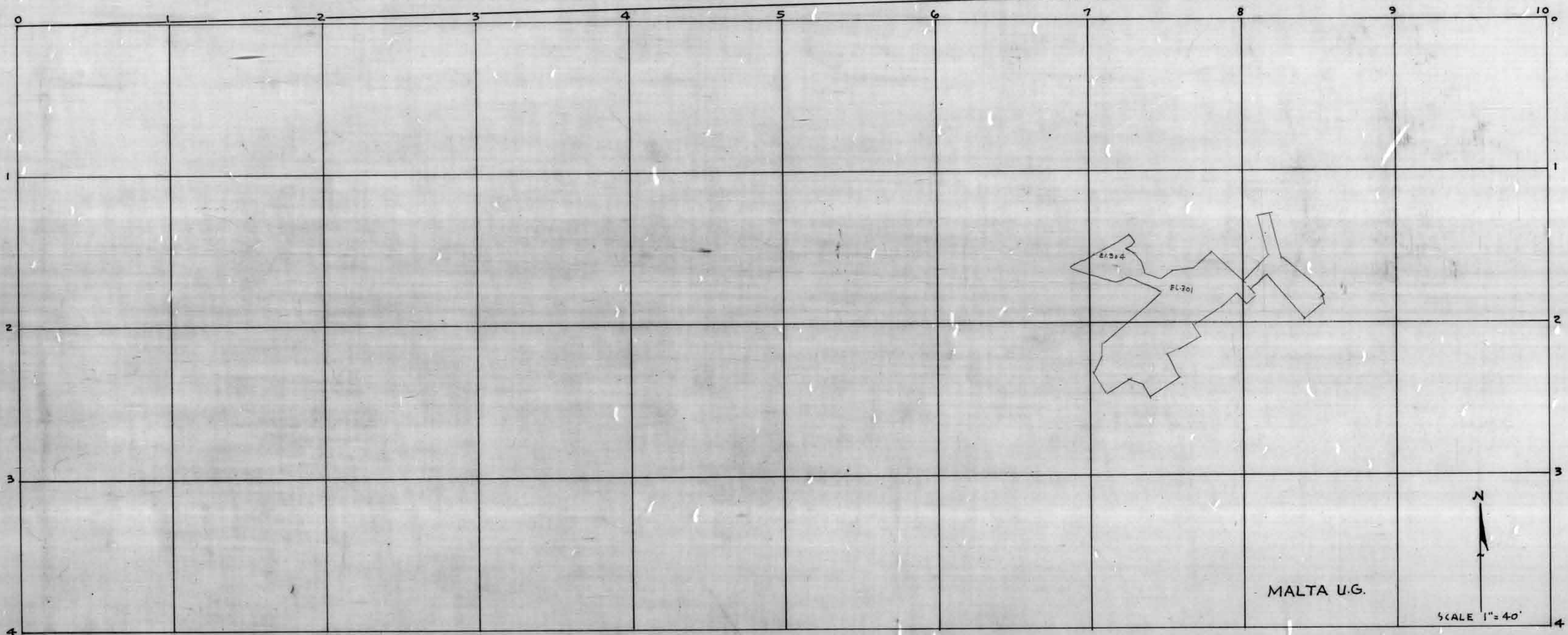

MALTA U.G.

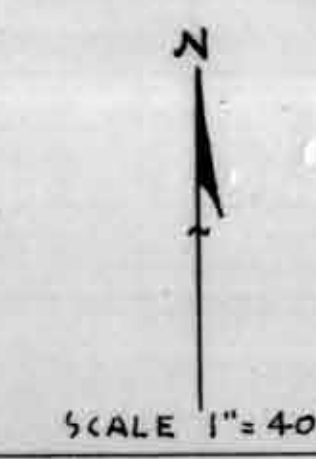

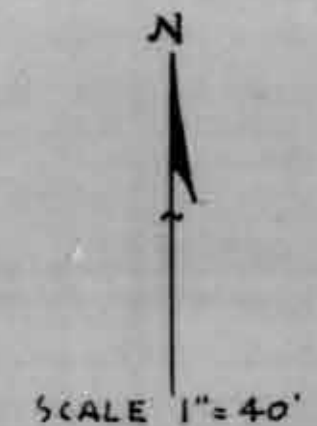
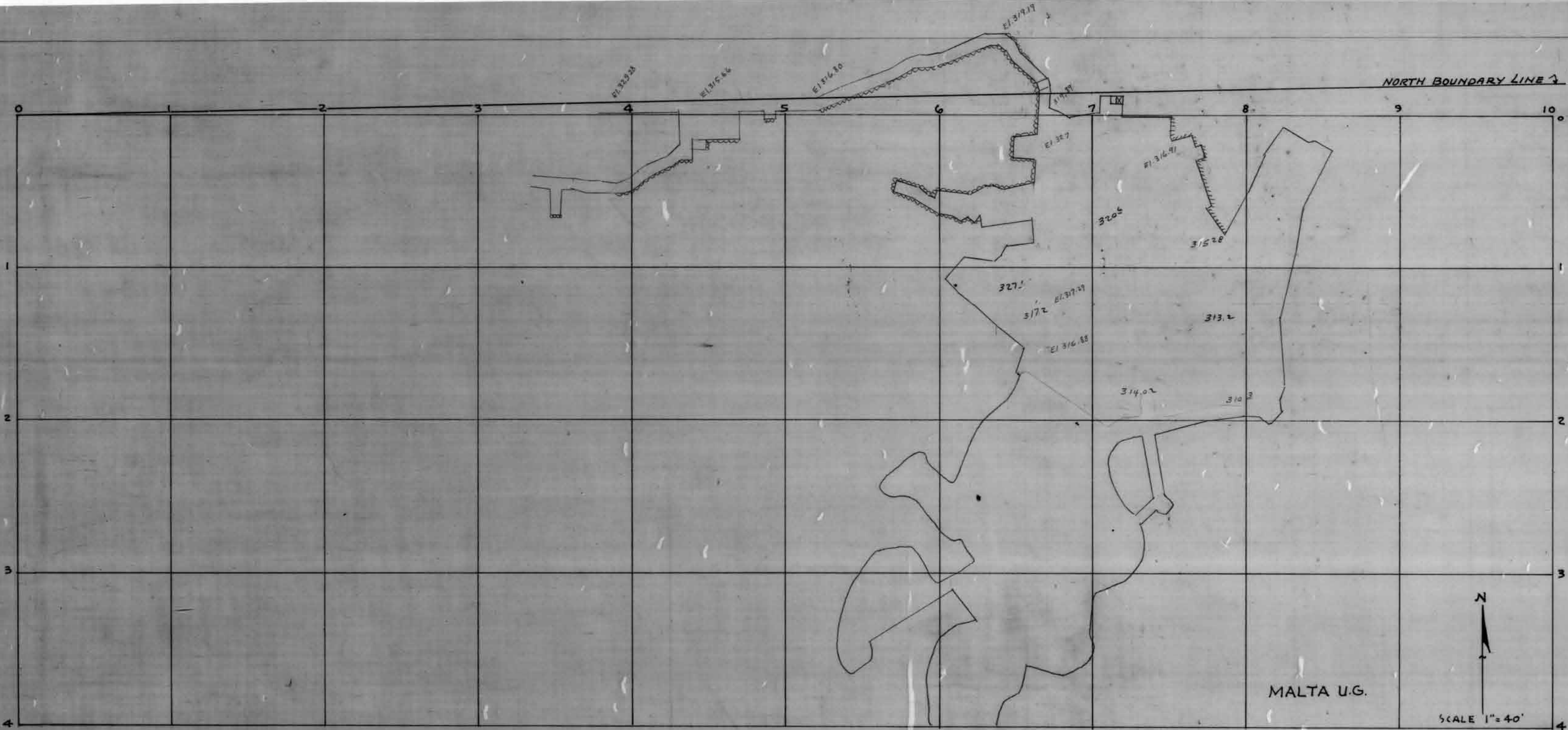

SEE BLOCK

34
T

321 Snd
401 1/2
722 1/2

32

30

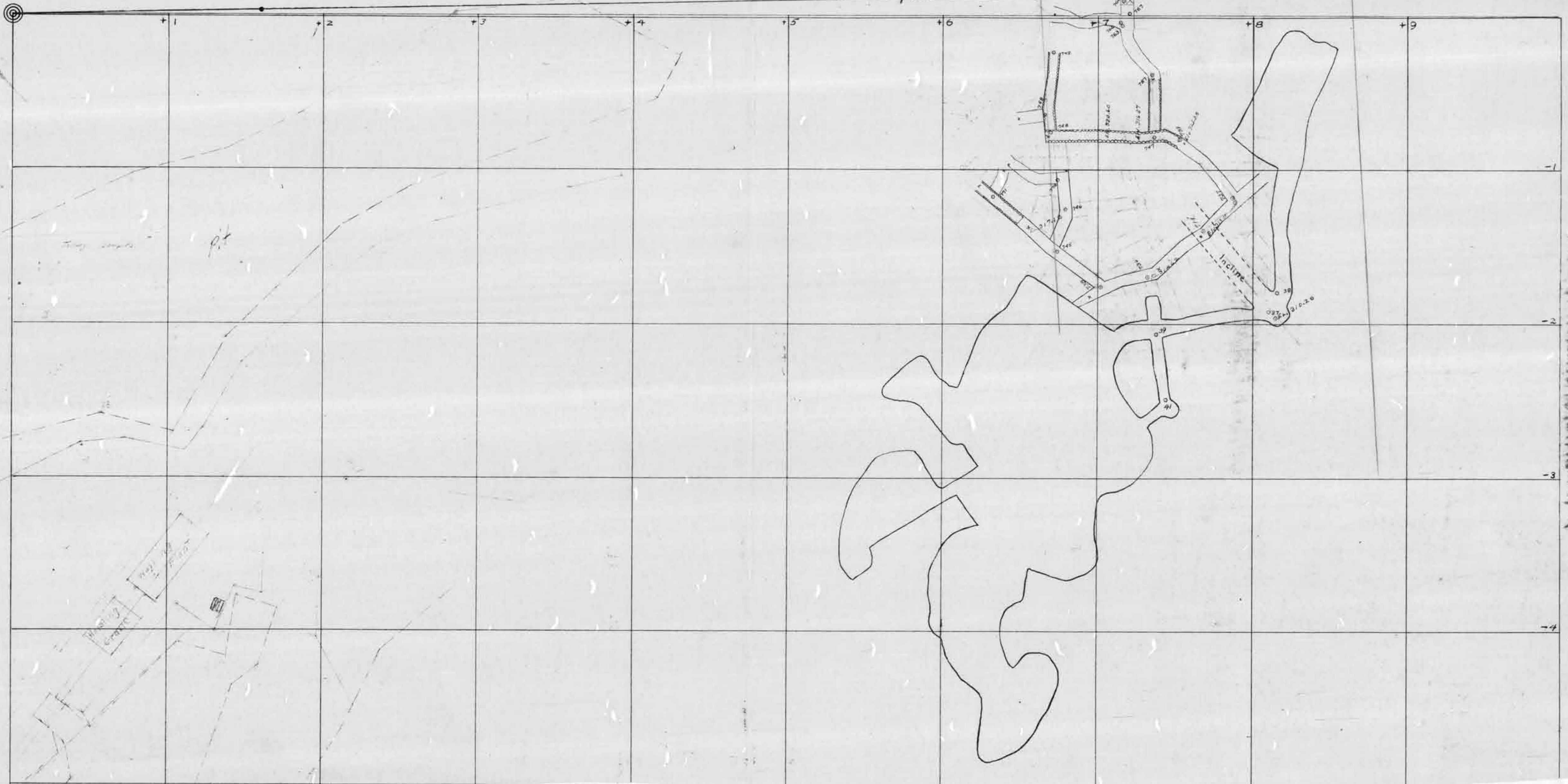

Vertical text on the right edge of the page, possibly a stamp or label, oriented vertically.

NORTH BOUNDARY LINE ↴

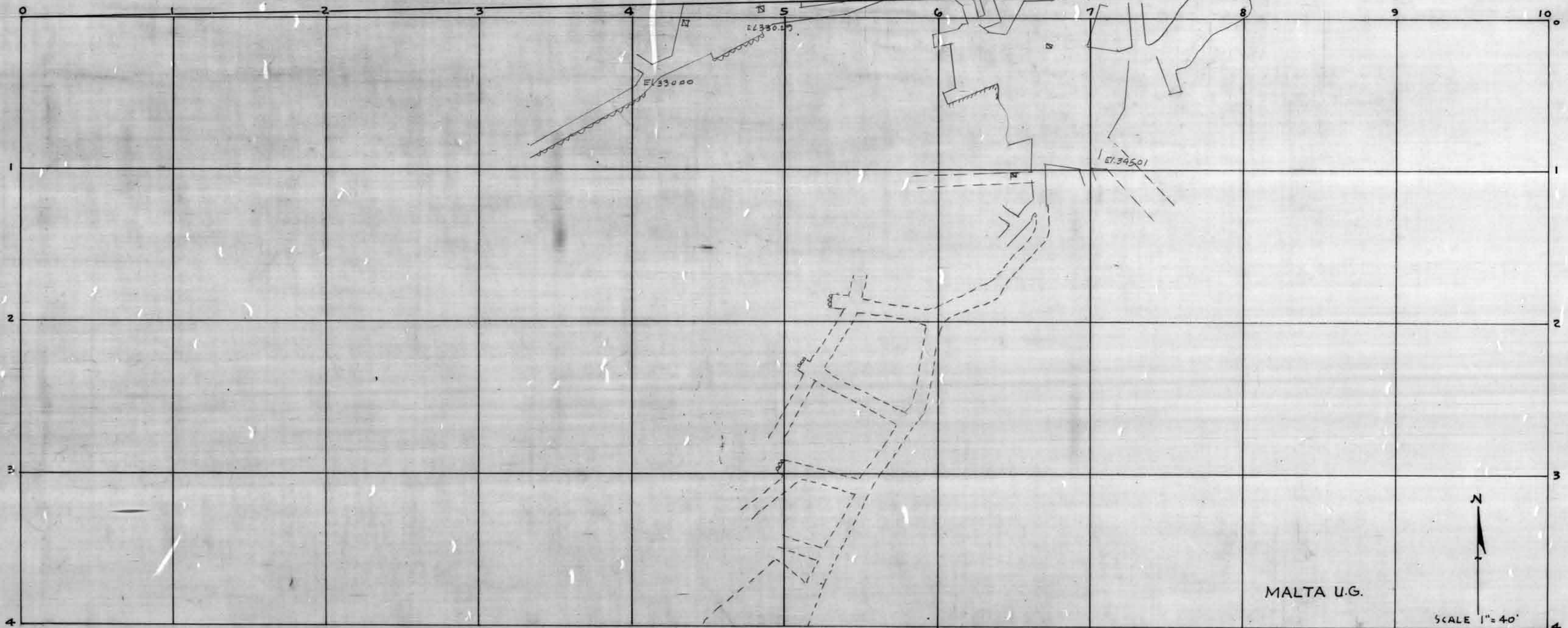

MALTA U.G.



SCALE 1" = 40'

NORTH BOUNDARY LINE ↗

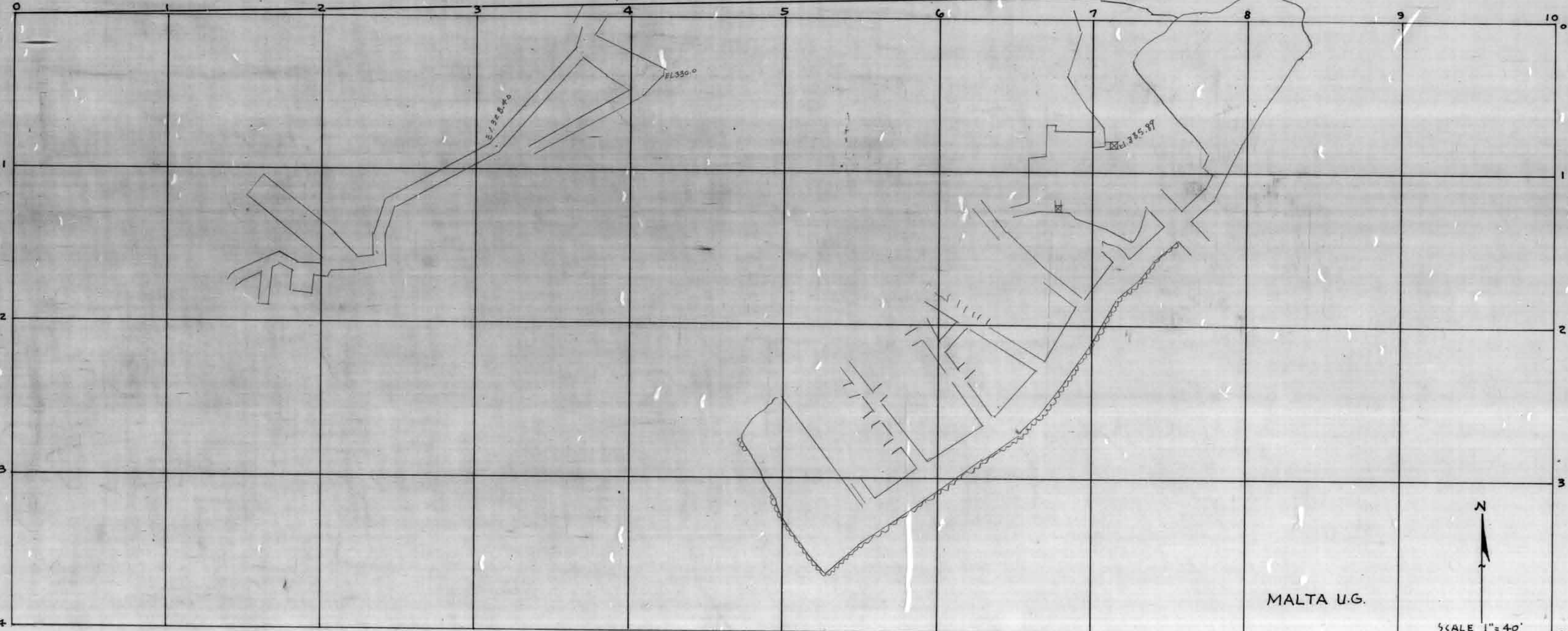

El. 328.98

El. 330.0

El. 328.98 Approx

El. 335.89

N

SCALE 1" = 40'

MALTA U.G.

NORTH BOUNDARY LINE ↘

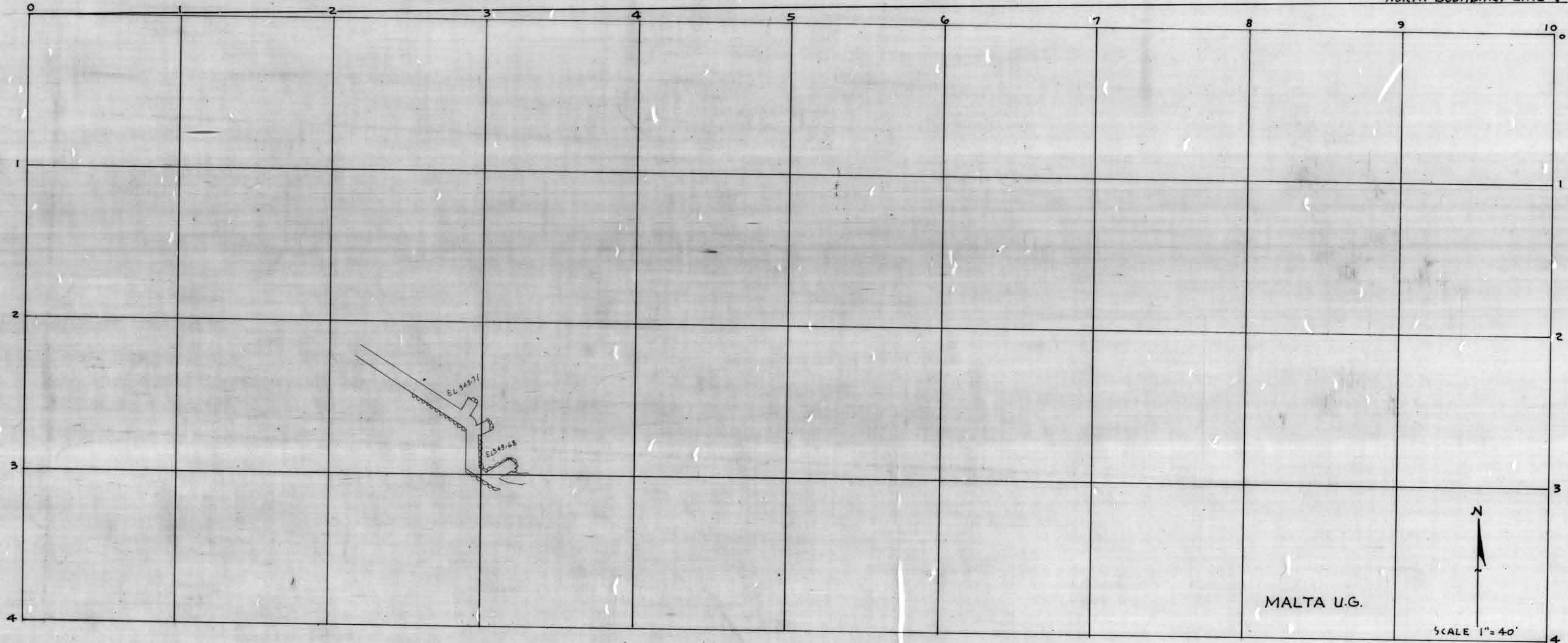

MALTA U.G.



SCALE 1"=40'

SEE BLOCK

30

36
72

348 Sub
4014
7494
5

North Boundary

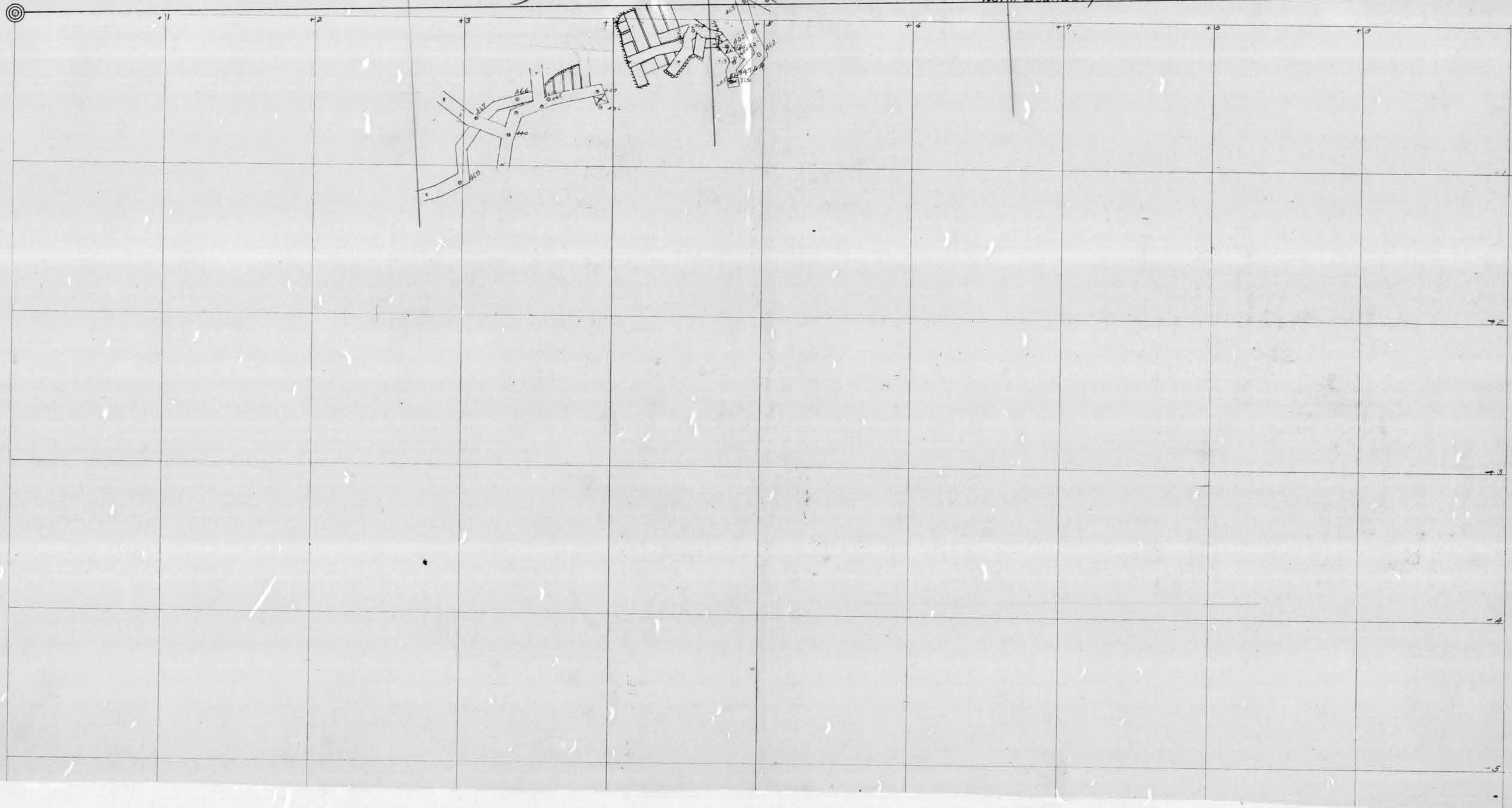

SEE BLOCK

SEE BLOCK

El. 353.0

NORTH BOUNDARY LINE ↘

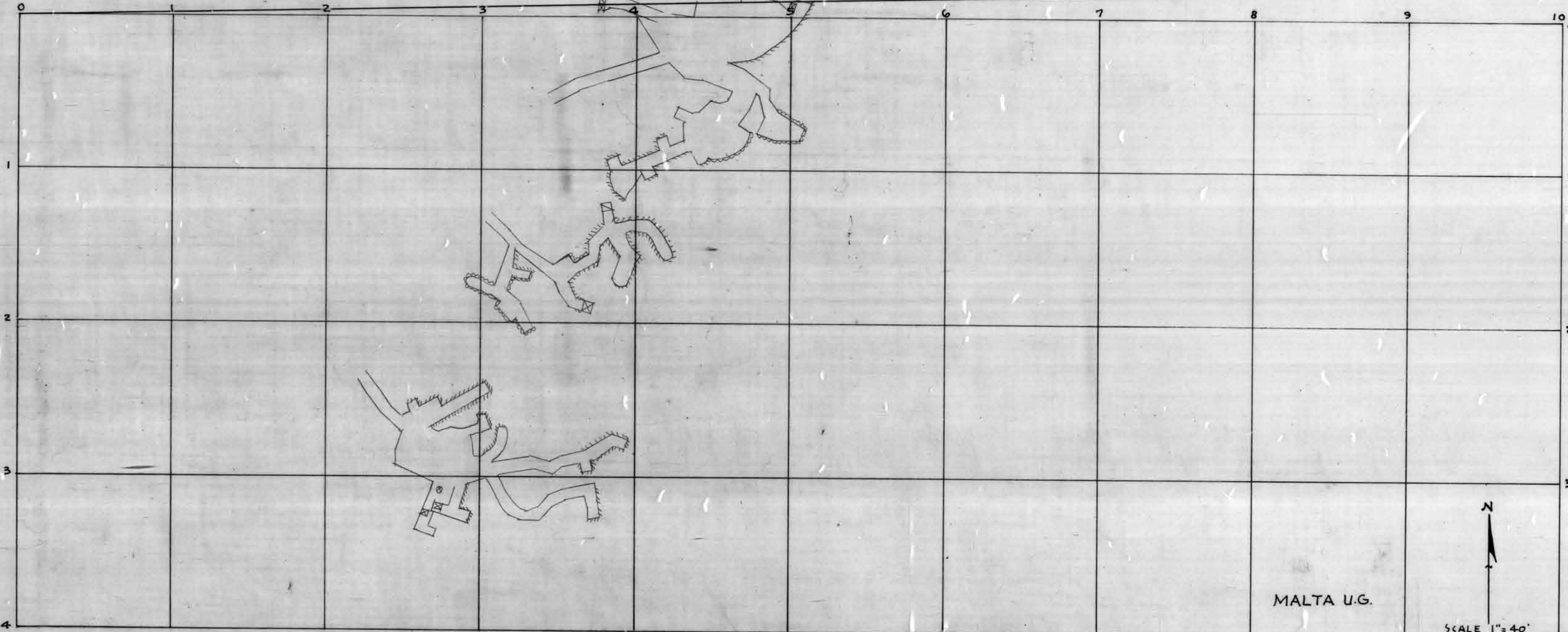

MALTA U.G.

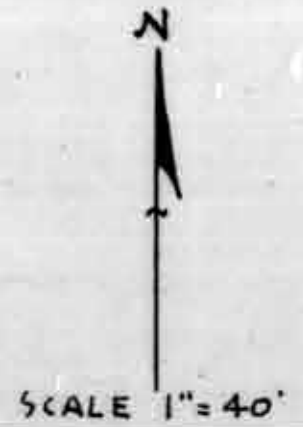

NORTH BOUNDARY LINE 3

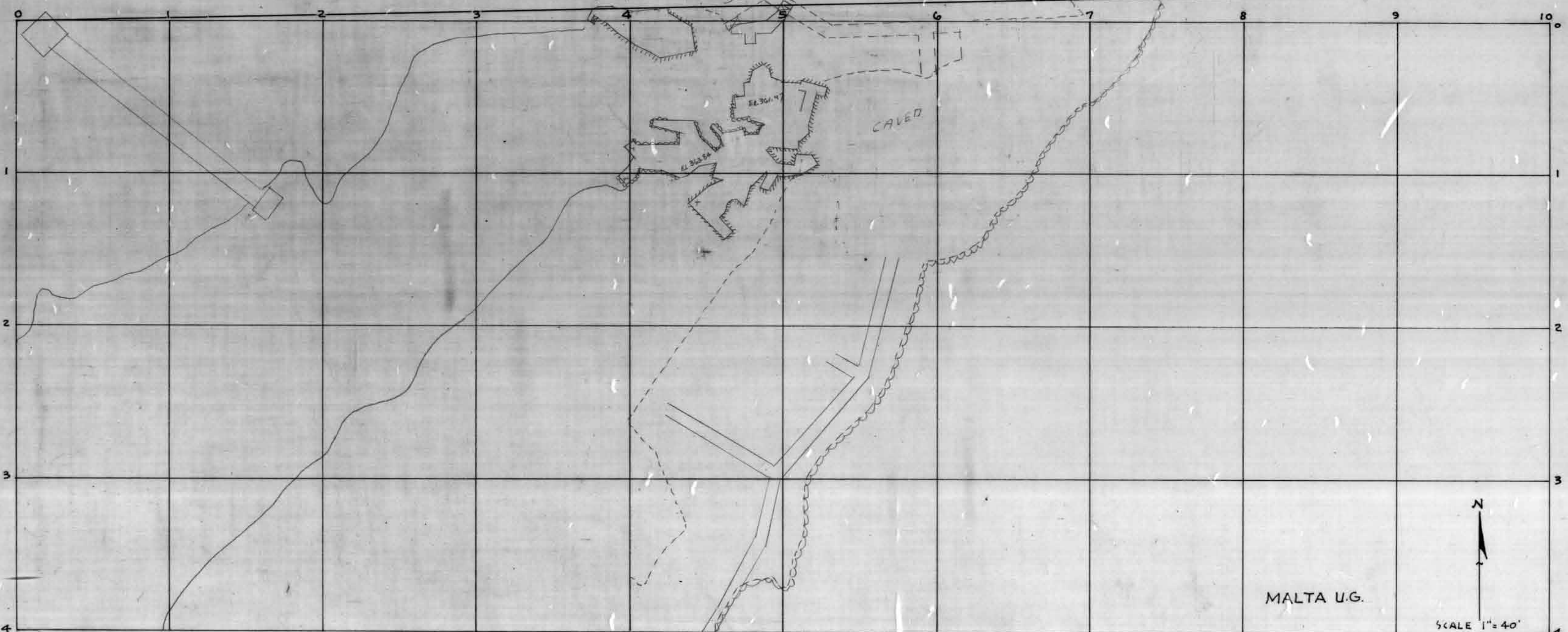

CAVED

EL. 361.47

EL. 361.71

EL. 362.2

MALTA U.G.



SCALE 1" = 40'

NORTH BOUNDARY LINE 3

Elev. 373.0

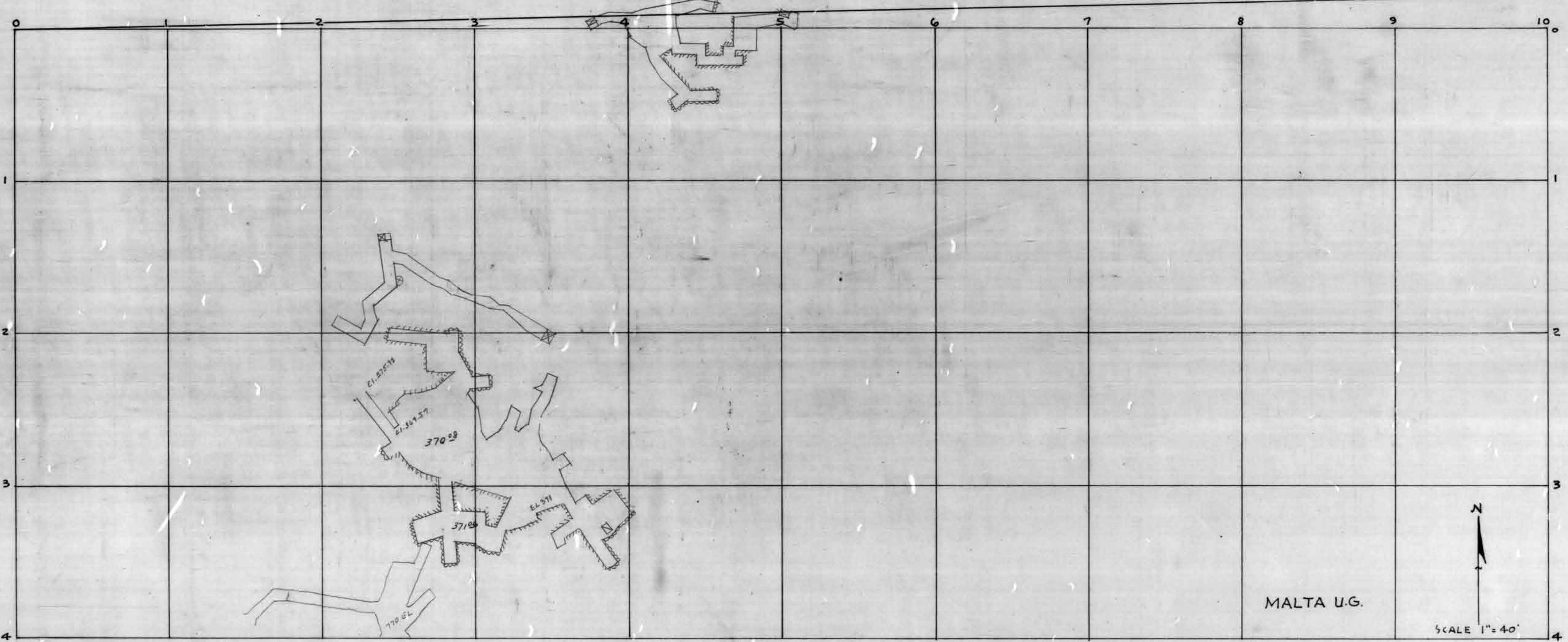

MALTA U.G.



SCALE 1" = 40'

381 $\frac{6}{4}$ \rightarrow μ
401
783 \oplus
3

T₂

North Boundary

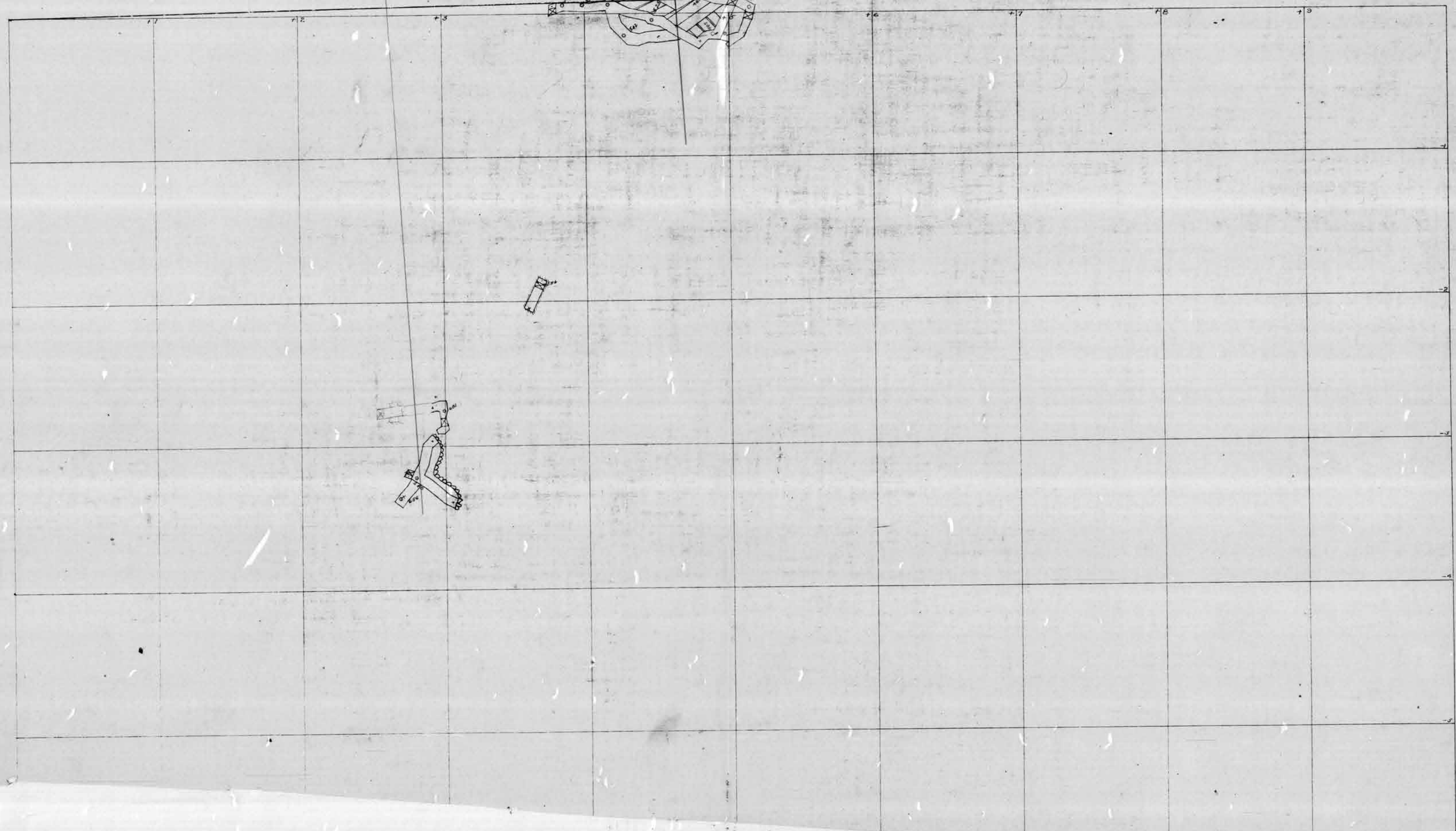

SEE BLOCK

390 SUB
4014
7914

SEE BLOCK

32

30

36

34

North Boundary

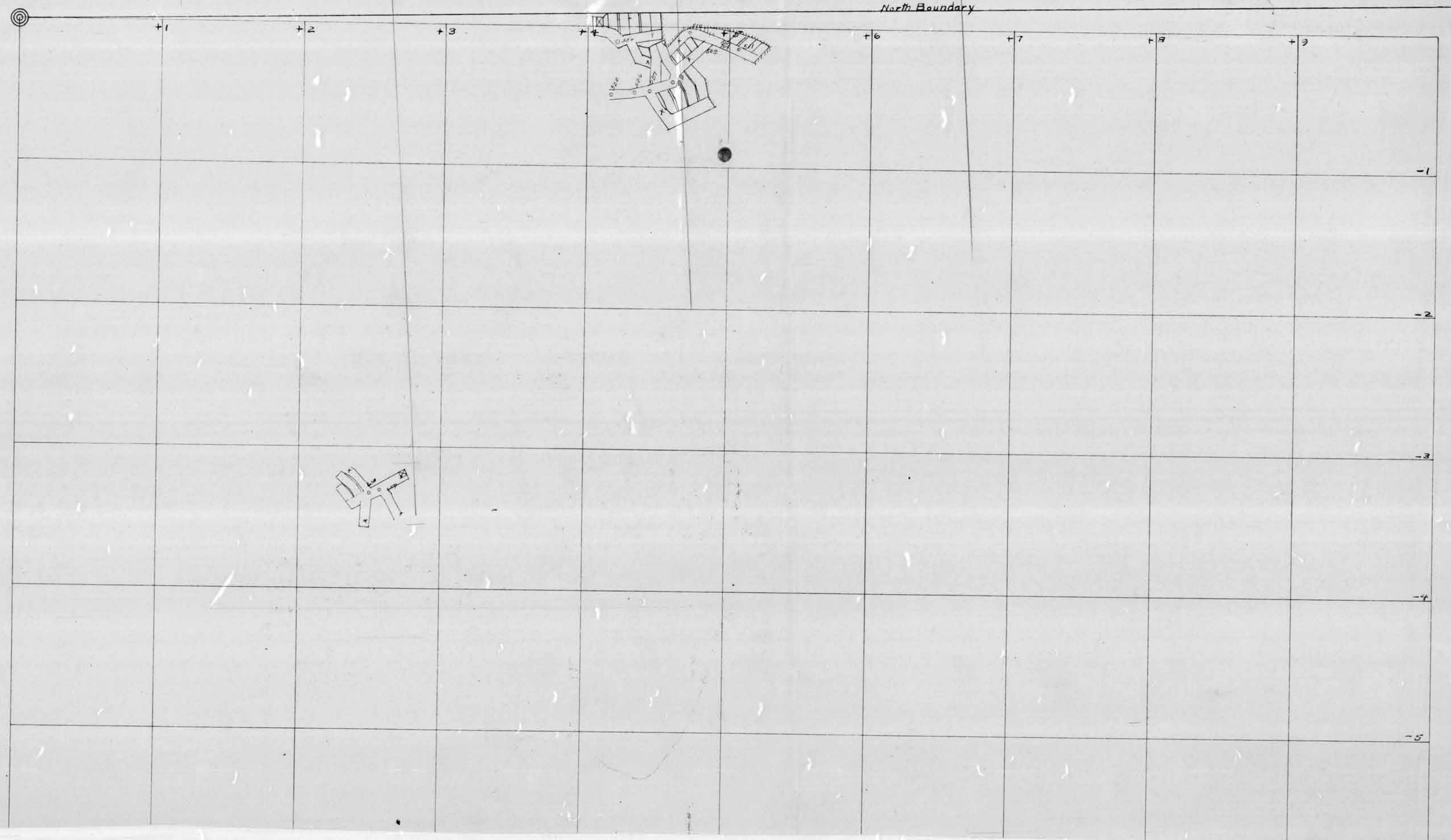

SEE BLOCK

SEE BLOCK 2

401 Sub
401 +
8024
←

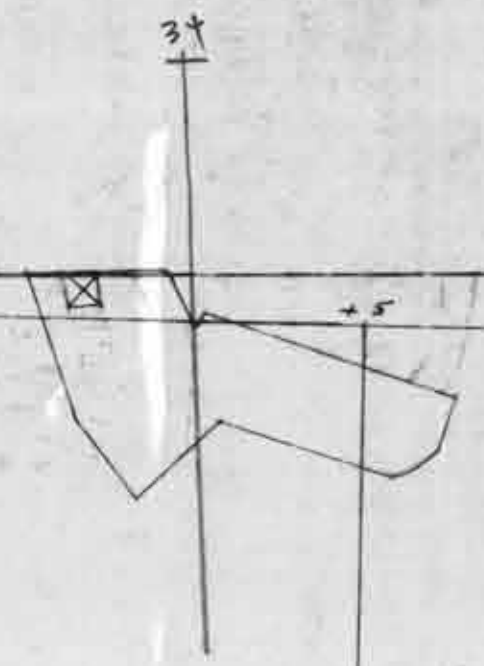

North Boundary

SEE BLOCK

SEE BLOCK

Sec Cor

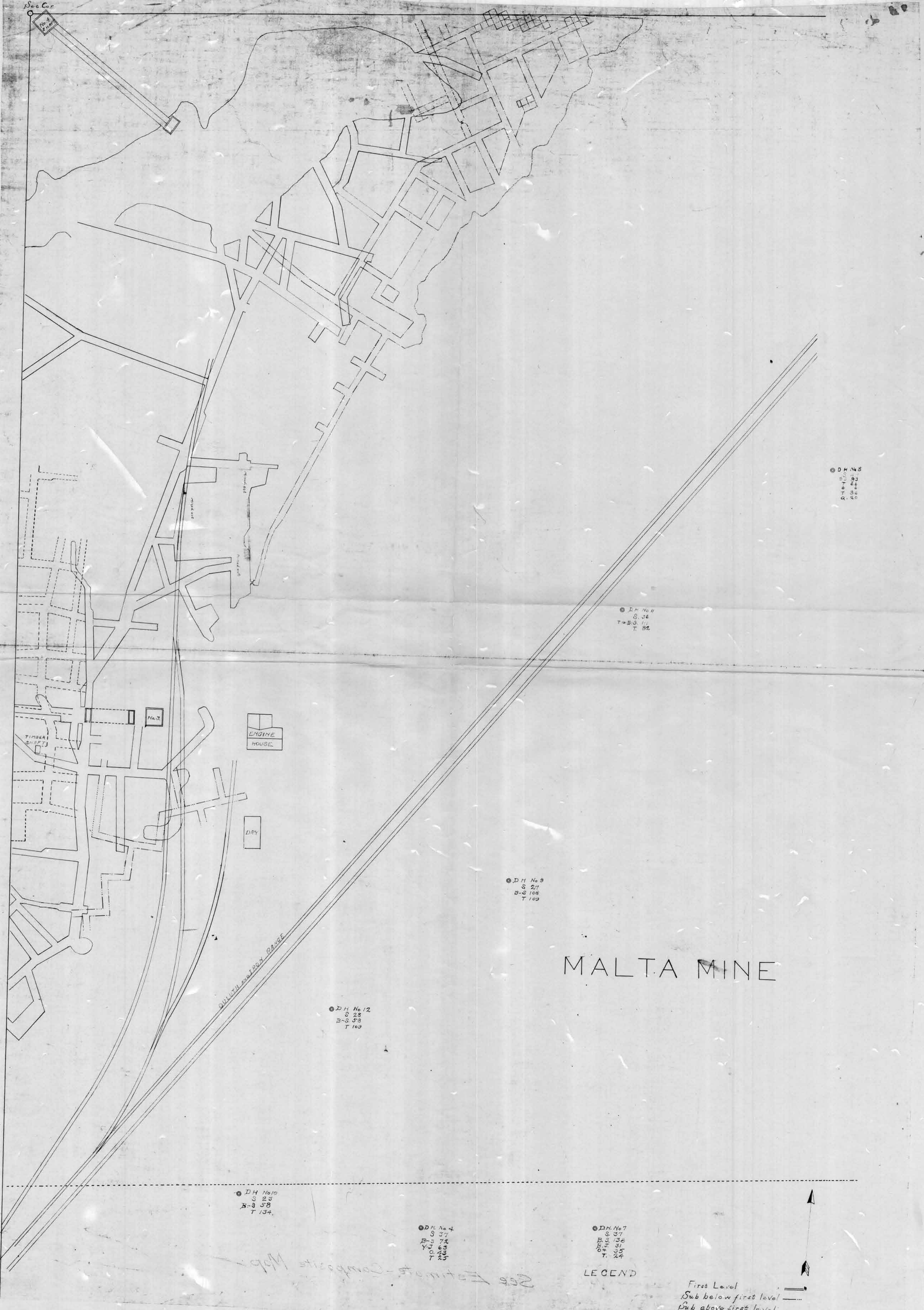

DH No 11
 S 36
 B-S 108
 T 109

DH No 9
 S 27
 B-S 108
 T 109

MALTA MINE

DH No 12
 S 28
 B-S 58
 T 109

DH No 10
 S 23
 B-S 58
 T 134

DH No 4
 S 37
 B-S 72
 YJ 63
 O 45
 T 25

DH No 7
 S 37
 B-S 138
 B-S 91
 O 24

LEGEND

- First Level ————
- Sub below first level - - - -
- Sub above first level
- Sub below 2nd sub -

See Estimate Composite Map 932

Sec. 200' N

300' S

Sparta

100' S

500' S

600' S

700' S

800' S

900' S

1000' S

Malta

MAP of SPARTA and MALTA Underground Workings

Aug 10, 1900

SCALE 1" = 40'
LEVEL LINES

- A SUB - - - - -
- B SUB - - - - -
- C SUB - - - - -
- Bottom Level ~ ~ ~ ~ ~

Note - Traced from a blue print. Received from Sparta Iron Co.

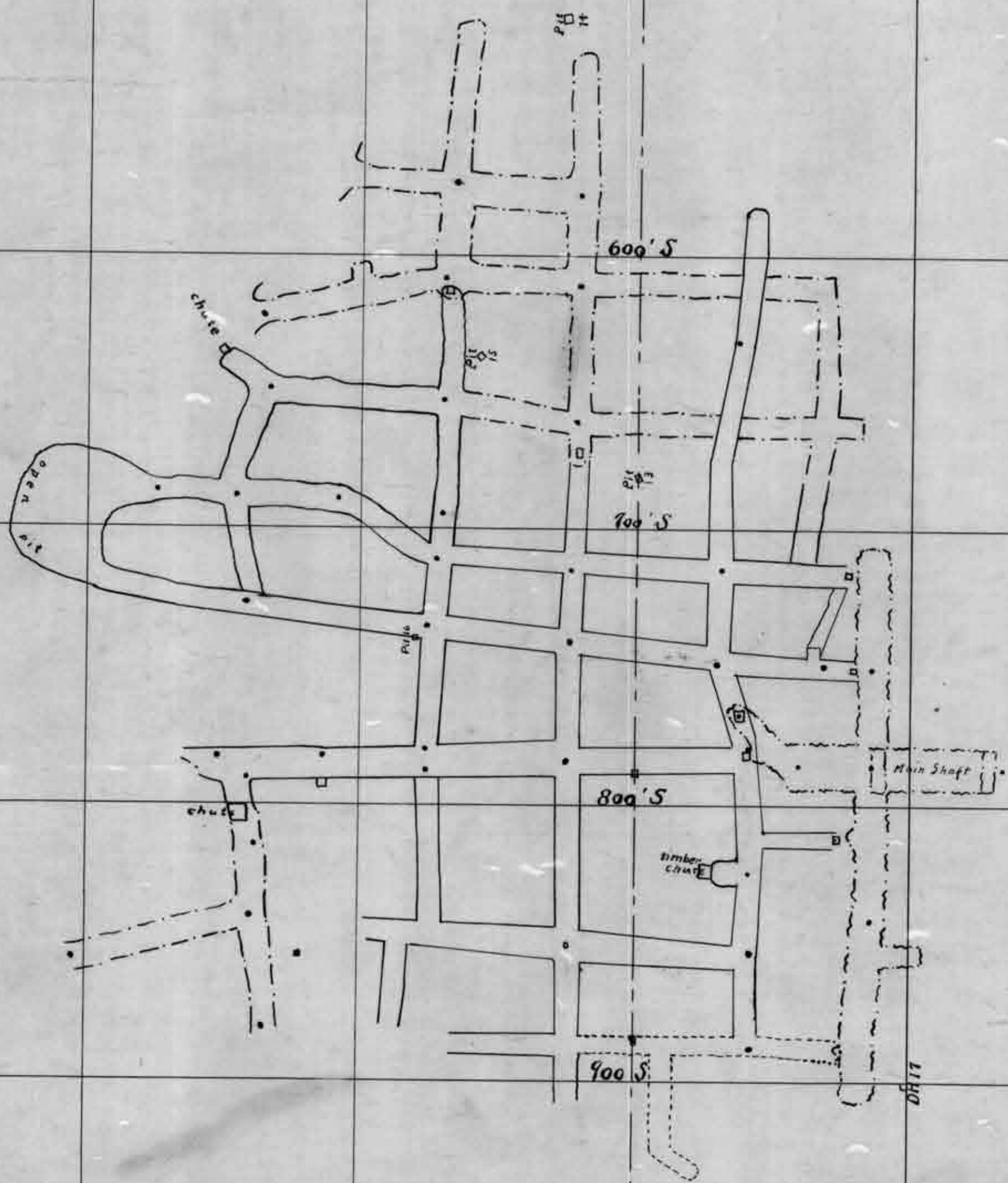
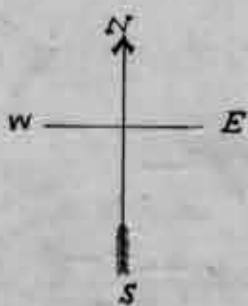

NO. 194 CASE 1 DWR. 40 OPT. 4 FILE 3