

**Overview Map for MMG USA
Exploration Plan, page 1
Date Submitted to DNR: 8/1/2014**

Purpose: The locations of proposed exploration activities by state mineral lessees are shown in a standard format and legend. Map by DNR, Lands and Minerals Division, August 2014.

Lessee: MMG USA Exploration LLC (MMG)

Lessee Contact Person: James Shannon: (720) 881-6965

State Mineral Lease Number: MM-10490

Location on Public Land Survey: T47N-R23W Section 27, Aitkin County

Types of Activity: Ground-based geophysical surveys: magnetic, electromagnetic, and gravity. These types of surveys will involve walking on the land with portable equipment.

Time Period for Activity: Beginning August 2014

New Access Trail or Road: No, there is a pre-existing private road as shown on the map.

Narrative: The exploration plan submitted to the DNR by MMG proposes to complete three types of ground-based geophysical surveys (magnetic, electromagnetic, and gravity) over state minerals lease number MM-10490. The surface at this location is privately held. MMG has been actively working to obtain a Surface Use and Exploration Agreement with the private surface owners.

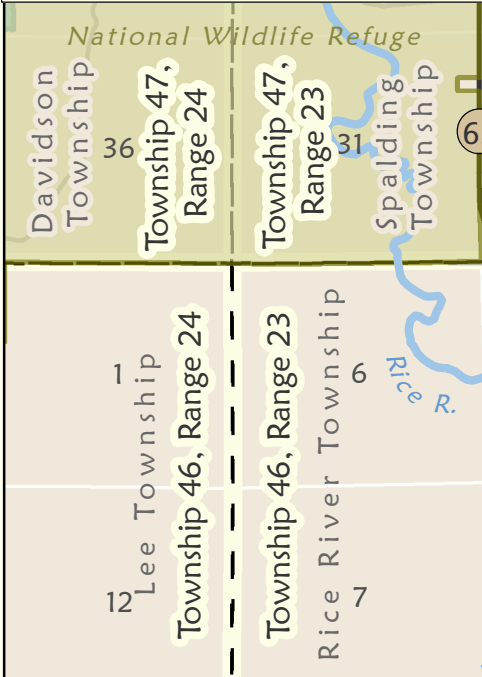
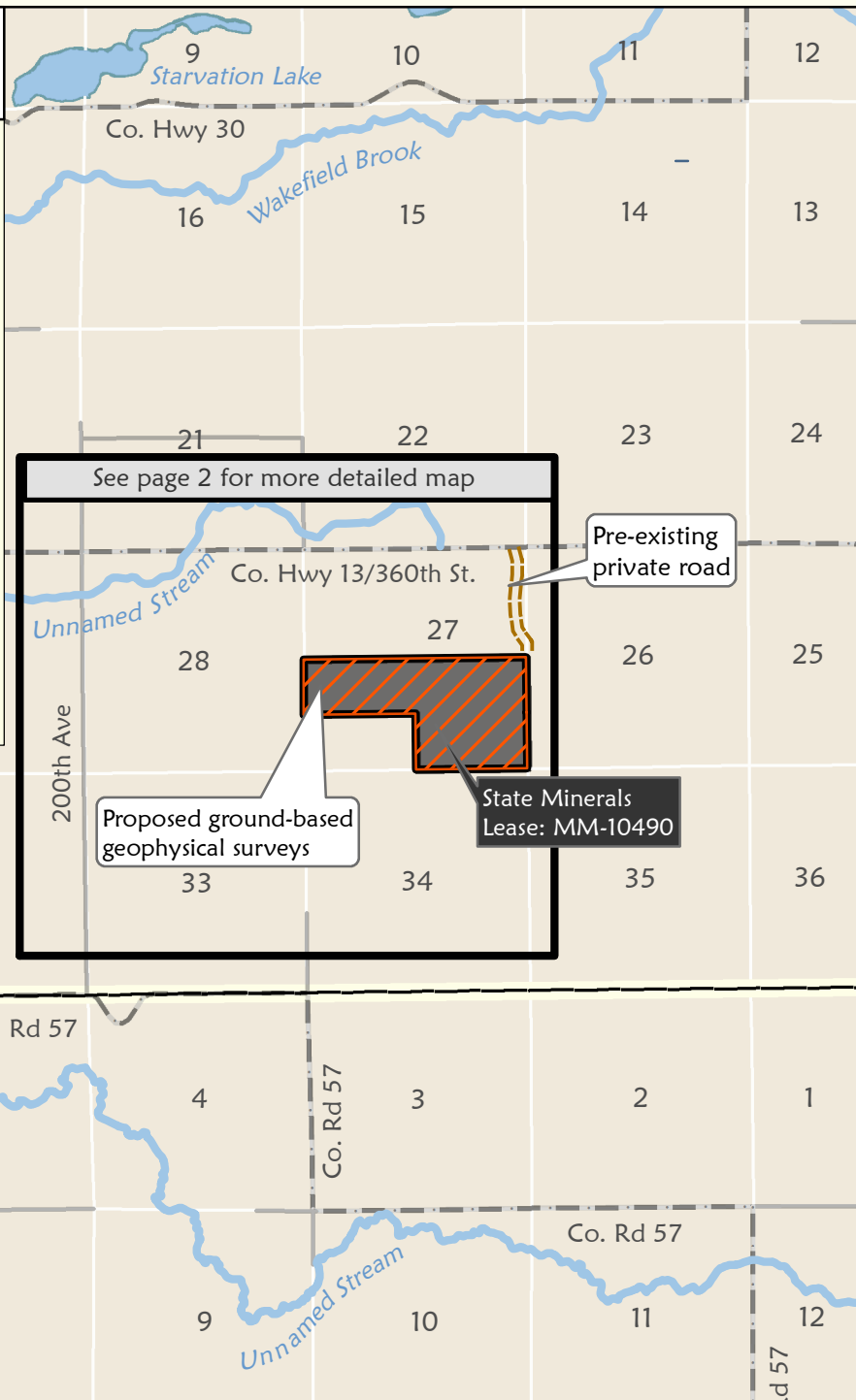

Map Symbols

- Proposed Exploration Activities on State Minerals Lease MM-10490**
- Three types of ground-based geophysical surveys: magnetic, electromagnetic, and gravity
 - Pre-existing private road
- State Leases for Nonferrous Metallic Minerals**
- Active State Mineral Lease for this Exploration Plan: Labeled by Mineral Lease (e.g. MM-10490)
- Exclusionary Features on the map**
- The beds of rivers or streams in DNR's Public Waters Inventory
- Special Features on the map**
- National Wildlife Refuge - Rice Lake
- Natural Heritage Features and Historic or Archeologic Sites are not shown because they are non-public data.*
- Other symbols**
- Township and Range Boundaries
 - Section Boundaries
 - Civil Division Boundaries
 - State Highway
 - County Roads
 - Other Roads
- 0 0.5 1 2 Miles



Overview Map for MMG USA Exploration Plan, page 2
Date Submitted to DNR: 8/1/2014

Purpose: The locations of proposed exploration activities by state mineral lessees are shown in a standard format and legend. Map by DNR, Lands and Minerals Division, August 2014.

Lessee: MMG USA Exploration LLC (MMG)

Lessee Contact Person: James Shannon: (720) 881-6965

State Mineral Lease Number: MM-10490

Location on Public Land Survey: T47N-R23W Section 27, Aitkin County

Types of Activity: Ground-based geophysical surveys: magnetic, electromagnetic, and gravity. These types of surveys will involve walking on the land with portable equipment.

Time Period for Activity: Beginning August 2014

New Access Trail or Road: No, there is a pre-existing private road as shown on the map.



Narrative: The exploration plan submitted to the DNR by MMG proposes to complete three types of ground-based geophysical surveys (magnetic, electromagnetic, and gravity) over state minerals lease number MM-10490. The surface at this location is privately held. MMG has been actively working to obtain a Surface Use and Exploration Agreement with the private surface owners.



Disclaimer for Maps and Data:
 The data in the following map is provided "as is" without warranty or any representation of accuracy, timeliness or completeness. The burden for determining accuracy, completeness, timeliness, merchantability and fitness for or the appropriateness for use rests solely on the requester. The state makes no warranties, express or implied, as to the use of the data. There are no implied warranties of merchantability or fitness for a particular purpose. The requester acknowledges and accepts the limitations of the data, including the fact that the data is dynamic and is in a constant state of maintenance, correction and update. This information is a compilation of data from different sources with varying degrees of accuracy and requires a qualified field survey to verify.

Map Symbols See legend on page 1 for other symbol descriptions.

Proposed Exploration Activities on State Minerals Lease MM-10490

-  Three types of ground-based geophysical surveys: magnetic, electromagnetic, and gravity
-  Pre-existing private road
-  Approximate 40 acre parcels in exploration plan area on state minerals lease

State Leases for Nonferrous Metallic Minerals

-  Active Lease for this Exploration Plan: MMG Labeled by Mineral Lease# (e.g. MM-10490)

Basemap: 2013 DNR True color Air Photo and LIDAR shaded relief.
 See page 1 legend for other map symbol descriptions shown here (special features, roads, political bounds, etc.).

