

LAKE AND STREAM SURVEY
UPPER TRELIPE LAKE

Chippewa National Forest

St. Louis County, Minnesota

Area 432 Acres
Length of Shoreline 4 Miles

Location Sec 36 T14N R27W
Scale 1/6" = 1 Mile

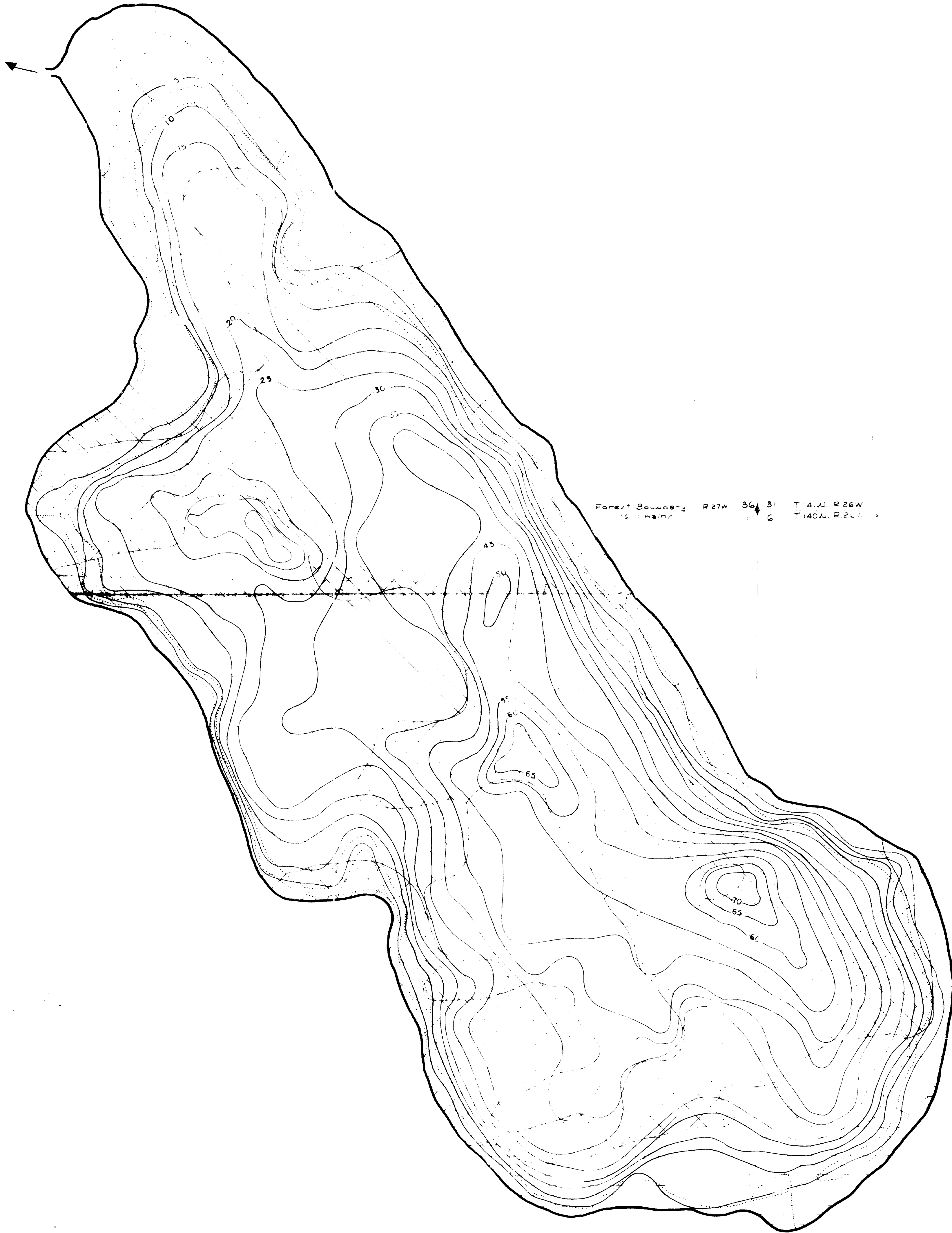

Forest Boundary R27W 36 31 T 4N R26W
6 5 T 14N R 27W

8-62

© COPYRIGHT 1989
STATE OF MINNESOTA
DEPARTMENT OF NATURAL RESOURCES
DIVISION OF FISH AND WILDLIFE