

STATE OF MINNESOTA  
Department of  
Administration



**Minnesota's Bookstore**  
Part of the Department of Administration  
Print Communications Division  
To order reproduced copies of  
Contour Lake Maps call:  
612/297-3000 or our  
Nationwide toll-free number  
1-800-657-3757



LEGEND

- MARSH
- EMERGENT VEGETATION
- BENCH MARK
- CULVERT
- TOWNSHIP LINE
- TOWNSHIP NUMBER **T.31 N.**
- SECTION LINE
- SECTION NUMBER **32**
- PAVED ROAD
- UNITED STATES HIGHWAY
- STATE HIGHWAY
- COUNTY STATE AID HIGHWAY

PLANIMETERED AREA 64.8 ACRES  
LITTORAL AREA 64.8 ACRES (100.0%)  
MEDIAN DEPTH 3.5 FEET  
LENGTH OF SHORELINE 1.4 MILES

LAKE OUTLINE DRAWN FROM 1977 AERIAL BLUELINE PHOTO SHEET NO.120-3.

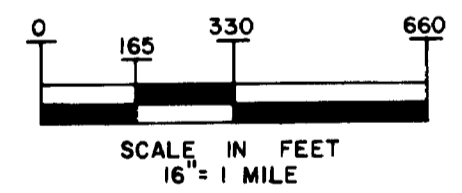

REPRODUCTION OF THIS MAP REQUIRES PROPER CREDITS TO: DIVISION OF FISH AND WILDLIFE, MINNESOTA DEPARTMENT OF NATURAL RESOURCES.

FINANCED WITH AID OF DINGELL-JOHNSON FUNDS

STATE OF MINNESOTA  
DEPARTMENT OF NATURAL RESOURCES

DIVISION OF FISH AND WILDLIFE  
ECOLOGICAL SERVICES SECTION

LADDIE LAKE (2-72)  
ANOKA COUNTY

|                          |                            |                  |
|--------------------------|----------------------------|------------------|
| T. 30, 31 N.             | R. 23, 24 W.               | S. 1, 32         |
| FIELDWORK S.M.E., J.K.H. | DRAWN BY <i>Mark Henry</i> | PROJ. IDENT. NO. |
| DATE 10-30-85            | DATE 12-7-87               | FW-6-S-2,4       |

B.M.1 = TOP OF NORTH END OF CEMENT WATER LEVEL CONTROL STRUCTURE, 30' WEST OF PUBLIC ACCESS ON NORTH END OF LAKE, AT WATER'S EDGE.  
W.S.E. = 1.5' BELOW B.M.1.  
B.M.2 = TOP OF STEEL GRATE COVER ON 16" DIAMETER CEMENT CULVERT, 30' WEST OF PUBLIC ACCESS ON NORTH END OF LAKE, 15' FROM WATER'S EDGE.  
W.S.E. = 1.3' BELOW B.M.2.

© COPYRIGHT 1985  
STATE OF MINNESOTA  
DEPARTMENT OF NATURAL RESOURCES  
DIVISION OF FISH AND WILDLIFE

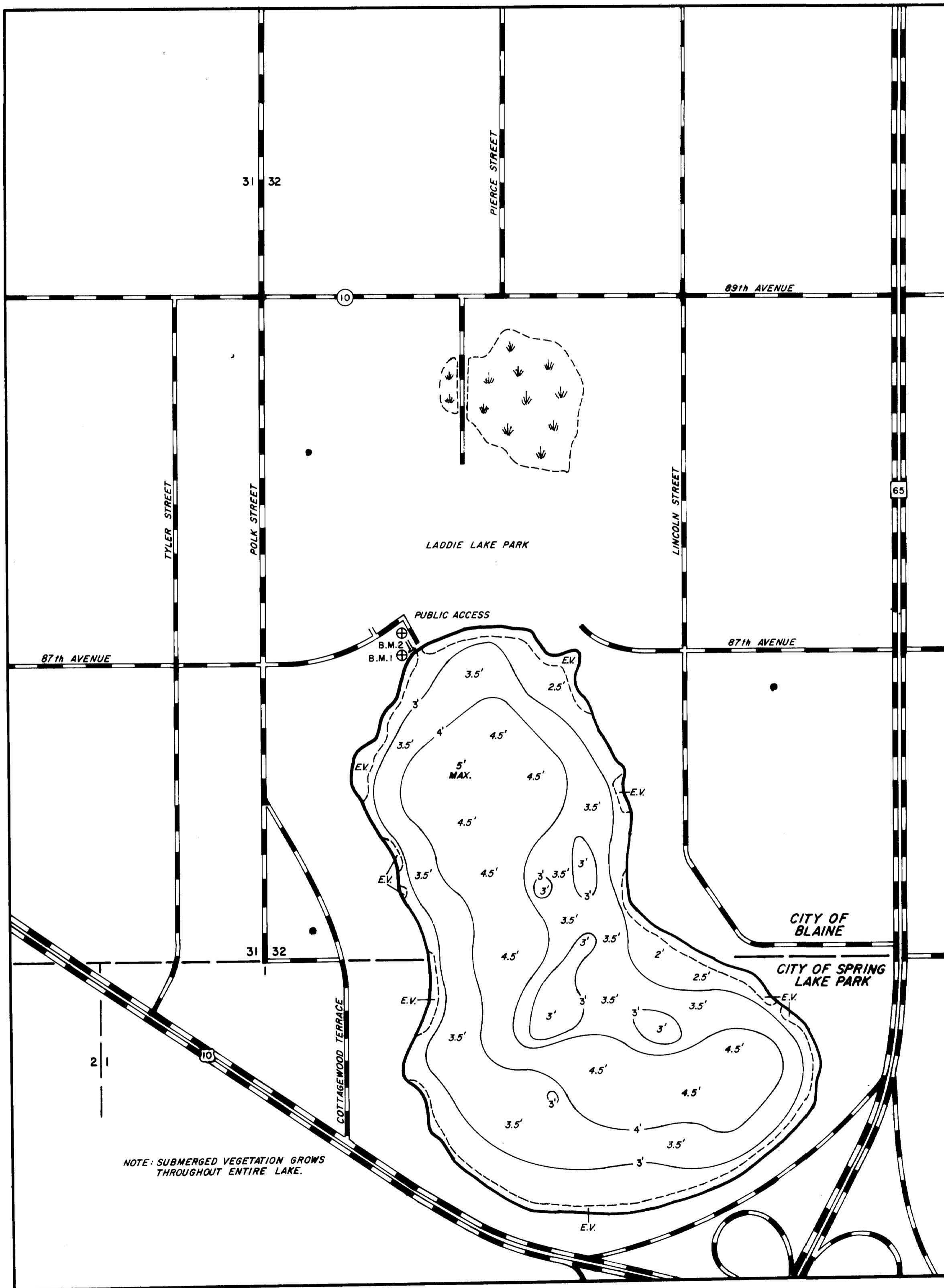

NOTE: SUBMERGED VEGETATION GROWS THROUGHOUT ENTIRE LAKE.

C-2898