

25 30  
R. 26 W.  
R. 25 W.



LEGEND

- MARSH
- BRUSH SWAMP
- OPEN WATER
- FLOATING-LEAF VEGETATION
- SUBMERGED VEGETATION
- WILD RICE
- INTERMITTENT STREAM
- GRAVEL ROAD
- PAVED ROAD
- COUNTY STATE AID HIGHWAY
- SECTION LINE
- SECTION NUMBER 30
- RANGE LINE
- RANGE NUMBER R. 25 W.
- BENCHMARK

PLANIMETERED AREA 97.3 ACRES  
LITTORAL AREA 81.9 ACRES (84 %)  
MEDIAN DEPTH 7.4 FEET  
LENGTH OF SHORELINE 2.7 MILES

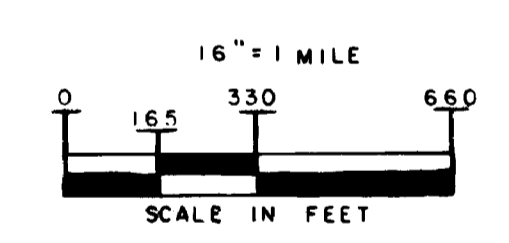

REPRODUCTION OF THIS MAP REQUIRES PROPER CREDITS TO: DIVISION OF FISH AND WILDLIFE, MINNESOTA DEPARTMENT OF NATURAL RESOURCES.

FINANCED WITH AID OF DINGELL-JOHNSON FUNDS

STATE OF MINNESOTA  
DEPARTMENT OF NATURAL RESOURCES  
DIVISION OF FISH AND WILDLIFE  
ECOLOGICAL SERVICES SECTION

BLACK LAKE (86-95)  
WRIGHT COUNTY

T. 121 N.	R. 25, 26 W.	S. 30, 31; 25, 36
FIELDWORK D.J.S., S.D.M.	DRAWN BY <i>[Signature]</i>	PROJ. IDENT. NO.
DATE 7-16-81	DATE 2-15-84	FW-1-R-26, 28

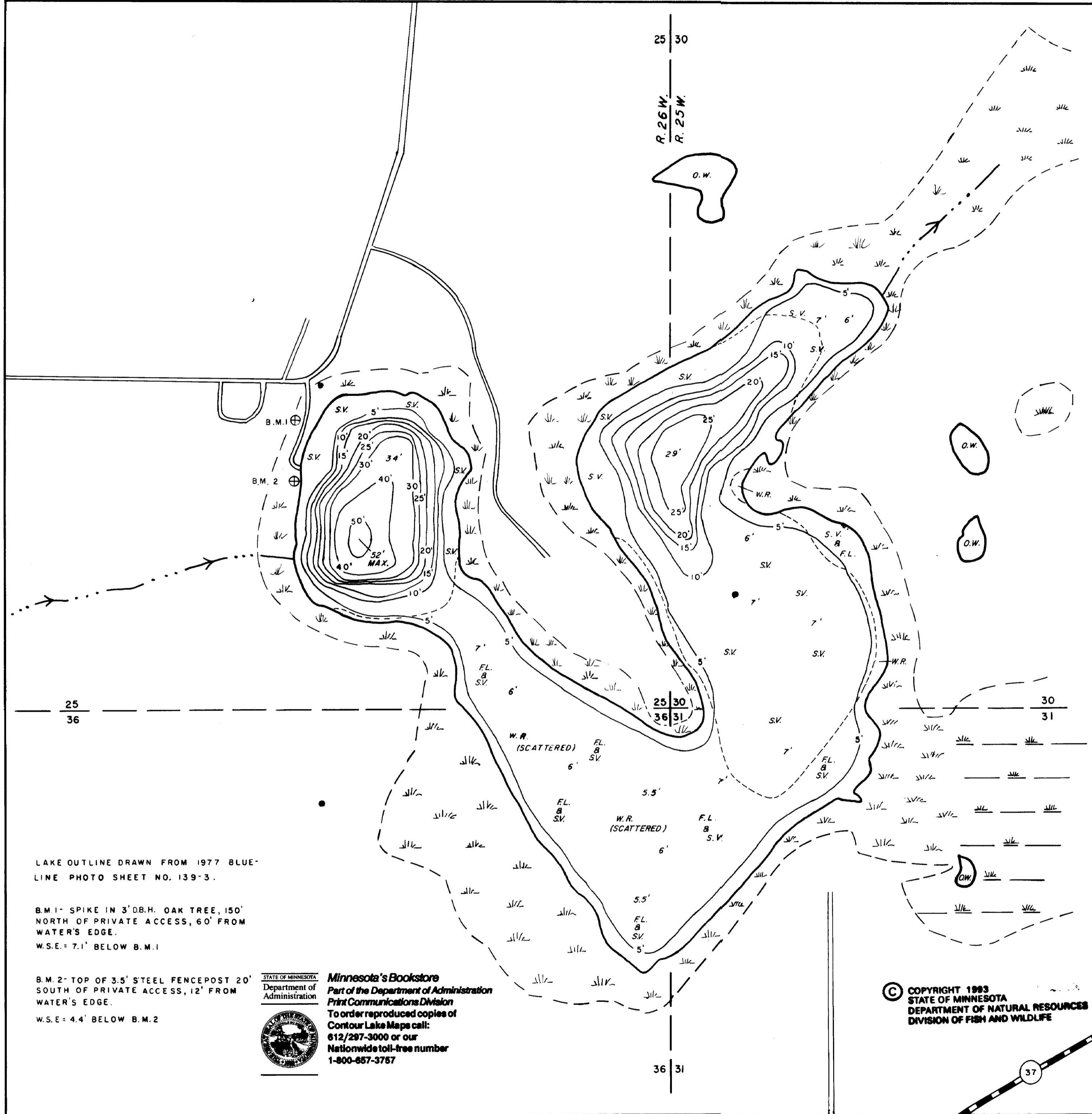

LAKE OUTLINE DRAWN FROM 1977 BLUE-LINE PHOTO SHEET NO. 139-3.

B.M. 1- SPIKE IN 3" DB.H. OAK TREE, 150' NORTH OF PRIVATE ACCESS, 60' FROM WATER'S EDGE.  
W.S.E. = 7.1' BELOW B.M. 1

B.M. 2- TOP OF 3.5' STEEL FENCEPOST 20' SOUTH OF PRIVATE ACCESS, 12' FROM WATER'S EDGE.  
W.S.E. = 4.4' BELOW B.M. 2

STATE OF MINNESOTA  
Department of Administration

**Minnesota's Bookstore**  
Part of the Department of Administration  
Print Communications Division  
To order reproduced copies of Contour Lake Maps call:  
612/297-3000 or our  
Nationwide toll-free number  
1-800-657-3757

© COPYRIGHT 1983  
STATE OF MINNESOTA  
DEPARTMENT OF NATURAL RESOURCES  
DIVISION OF FISH AND WILDLIFE