

LEGEND

BEAVER DAM	
BITUMINOUS ROAD	
GRAVEL ROAD	
UNIMPROVED ROAD	
UNITED STATES HIGHWAY	
SECTION LINE	
SECTION NUMBER	30
MARSH	
INTERMITTENT STREAM	
EMERGENT VEGETATION	
CULVERT	
BENCHMARK (B.M.)	
TRANSMISSION LINE	

PAQUET LAKE

PLANIMETERED AREA-	116.8 ACRES
LITTORAL AREA-	95.8 ACRES
LENGTH OF SHORELINE-	2.6 MILES

B.M.#1- SPIKE IN 18" D.B.H. JACK PINE ON POINT JUST WEST OF PRIVATE ACCESS ON NORTHEAST END OF LAKE.

W.S.E. WAS 6.6' BELOW B.M.#1.

B.M.#2- TOP OF 4'X5'X6' BOULDER ON POINT JUST WEST OF PRIVATE ACCESS ON NORTHEAST END OF LAKE.

W.S.E. WAS 4.4' BELOW B.M.#2.

MUD (ONE) LAKE

PLANIMETERED AREA-	35.5 ACRES
LITTORAL AREA-	35.5 ACRES
LENGTH OF SHORELINE-	1.6 MILES

B.M.#1- TOP OF 5' C.M.C. ON CREEK RUNNING FROM LAKE TO LAKE ON PRIVATE ROAD.

W.S.E. WAS 4.3' BELOW B.M.#1.

FINANCED WITH AID OF DINGELL-JOHNSON FUNDS

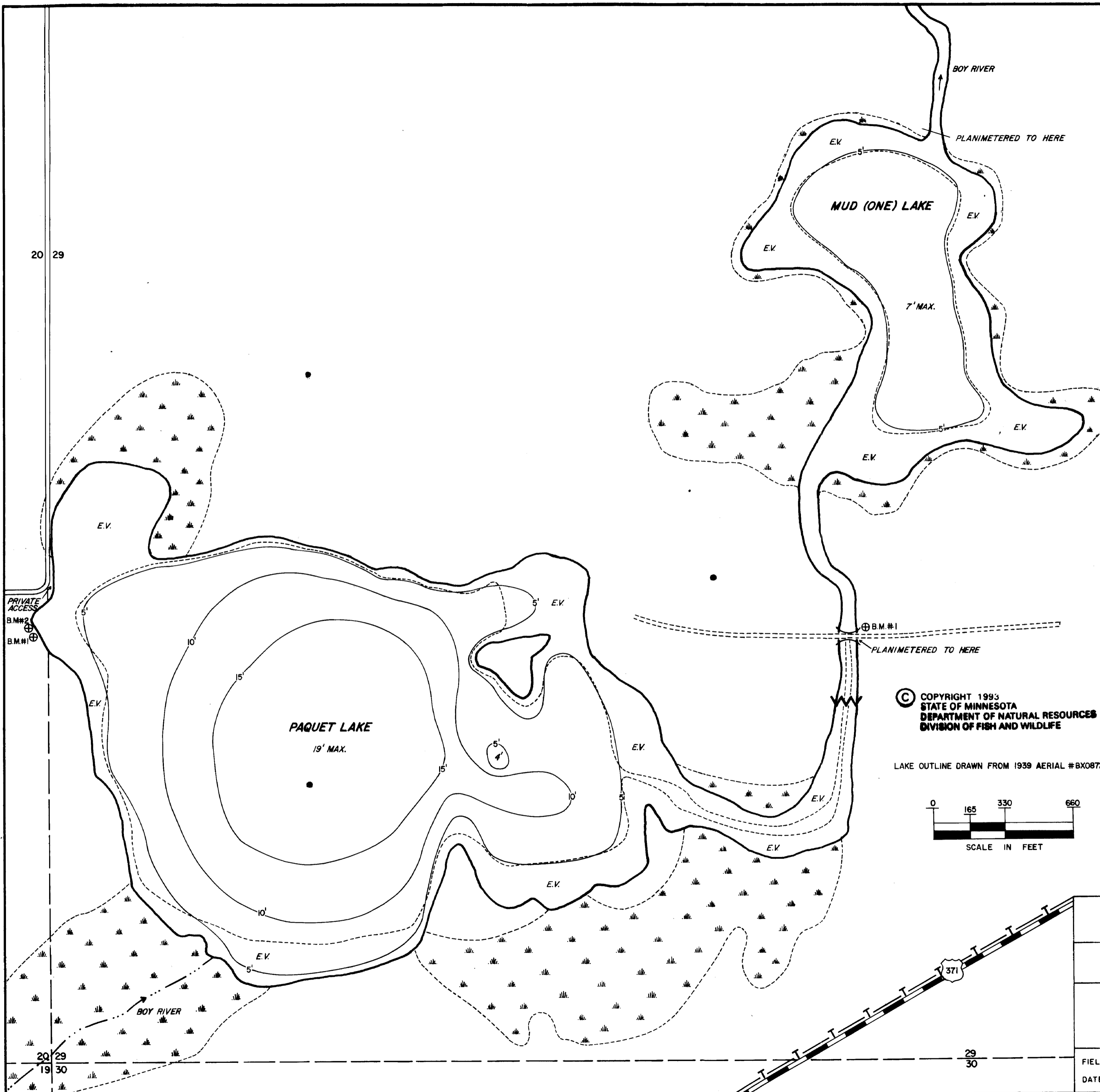

© COPYRIGHT 1993
STATE OF MINNESOTA
DEPARTMENT OF NATURAL RESOURCES
DIVISION OF FISH AND WILDLIFE

LAKE OUTLINE DRAWN FROM 1939 AERIAL #BX0872.

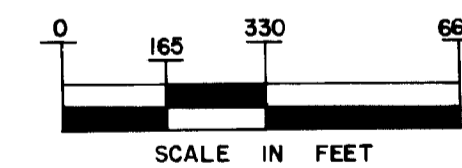

STATE OF MINNESOTA
DEPARTMENT OF NATURAL RESOURCES

DIVISION OF FISH AND WILDLIFE
ECOLOGICAL SERVICES SECTION

**MUD (ONE) LAKE (11-381)
PAQUET LAKE (11-385)**
CASS COUNTY

T. 140 N. R. 30 W. S. 20, 29.

FIELDWORK D.J.S. & R.W.L.	DRAWN BY <i>Ray Segiel</i>	PROJ. IDENT. NO.
DATE 7-22-76	DATE 1-5-79	FW-1-R-21-23.