

LEGEND

- BITUMINOUS ROAD
- UNIMPROVED ROAD
- GRAVEL ROAD
- STATE HIGHWAY
- COUNTY STATE AID HIGHWAY
- NATIONAL W.M.A. BOUNDARY
- MARSH AREA
- OPEN WATER
- PLANIMETERED AREA 195.4 ACRES
- LITTORAL AREA 195.4 ACRES
- LENGTH OF SHORELINE 3.1 MILES
- B.M.#1 TOP OF 2' CONCRETE CULVERT ON SOUTH SIDE OF WAYSIDE PARK ON EAST SIDE OF LAKE
W.S.ELEV. = 1.1' BELOW BENCHMARK
- B.M.#2 SPIKE IN 4-TRUNKED OAK ON NORTH EDGE OF WAYSIDE PARK 10' FROM SHORE ON EAST SIDE OF LAKE
W.S.ELEV. = 3.5' BELOW BENCHMARK

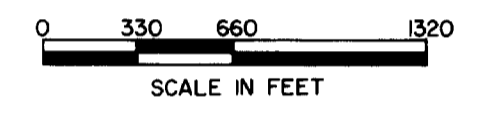

© COPYRIGHT 1993
STATE OF MINNESOTA
DEPARTMENT OF NATURAL RESOURCES
DIVISION OF FISH AND WILDLIFE

STATE OF MINNESOTA
Department of Administration

Minnesota's Bookstore
Part of the Department of Administration
Print Communications Division
To order reproduced copies of
Contour Lake Maps call:
612/297-3000 or our
Nationwide toll-free number
1-800-657-3757

LAKE OUTLINE DRAWN FROM 1965 AERIAL PHOTOS:
NOS. BJJ-2FF-127
BJJ-2FF-152

STATE OF MINNESOTA
DEPARTMENT OF NATURAL RESOURCES

DIVISION OF GAME AND FISH
TECHNICAL SERVICES SECTION

MALMEDAHL LAKE 61-162
POPE COUNTY

T. 125, 126 N. R. 39 W. S. 1, 2, 35, 36

FIELDWORK R.A.B. F.H.K.
DATE 6-17-71

DRAWN BY *R.R. Brandon*
DATE 4-5-72

PROJ. IDENT. NO.
FW-1-R-15

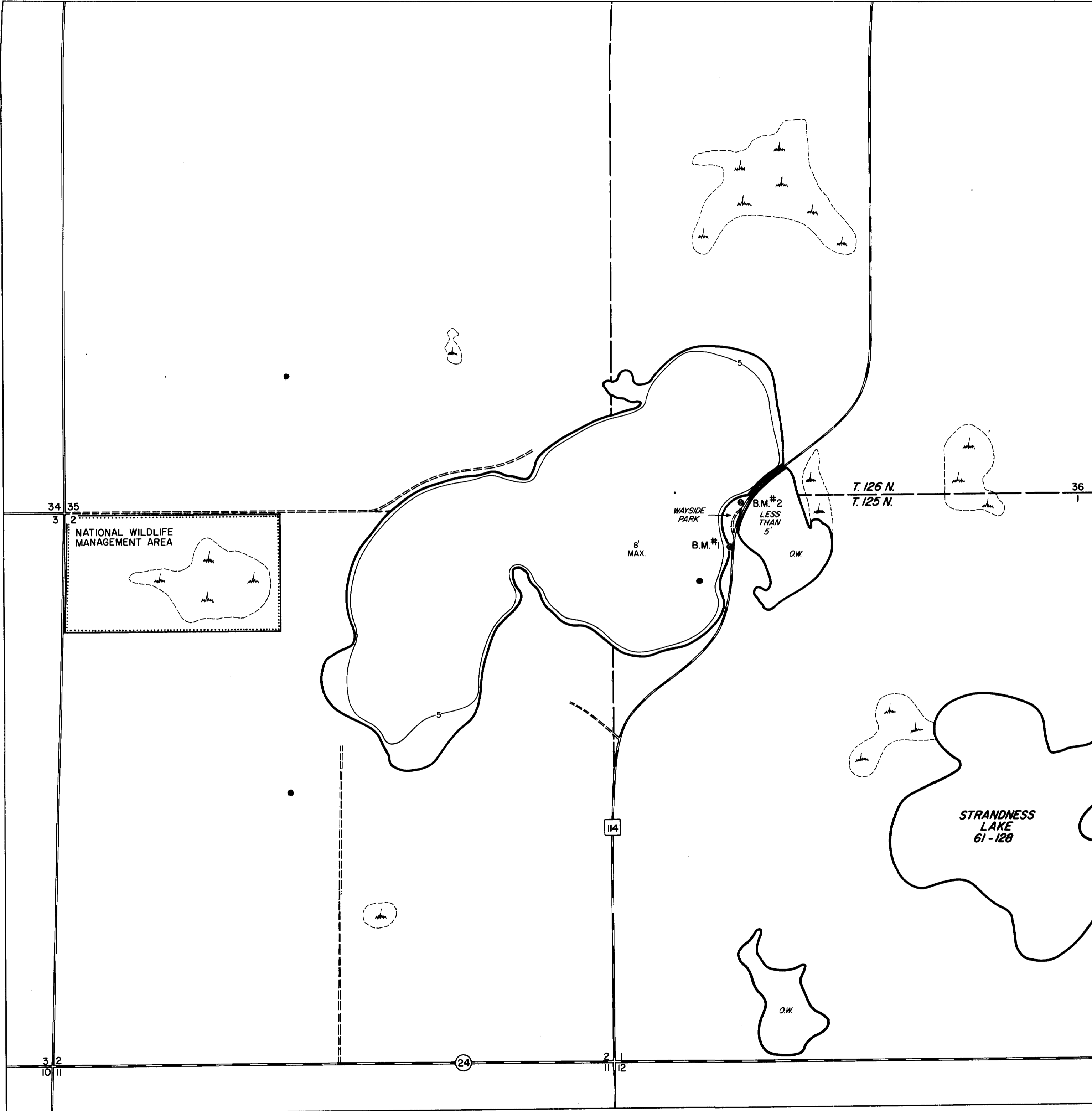

C-2234