

STATE OF MINNESOTA
 Department of
 Administration
 Minnesota's Bookstore
 Part of the Department of Administration
 Print Communications Division
 To order reproduced copies of
 Contour Line Maps call:
 612/297-3000 or our
 Nationwide toll-free number
 1-800-657-3757

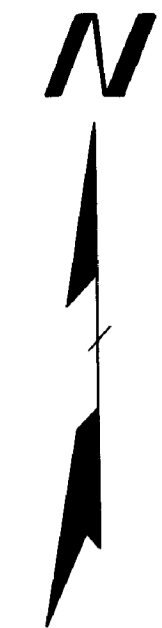

VILLAGE OF WASECA

CHICAGO & NORTH WESTERN RAILWAY

LEGEND

- PAVED ROAD
- BITUMINOUS ROAD
- GRAVEL ROAD
- U.S. HIGHWAY
- STATE AID HIGHWAY
- COUNTY ROAD
- RAILROAD
- VILLAGE LIMITS
- CITY PARK
- TRANSMISSION LINE
- BRIDGE
- CULVERT
- MARSH AREA

PLANIMETERED AREA = 122 ACRES
 LITTORAL AREA = 122 ACRES
 LENGTH OF SHORELINE = 2 MILES
 LENGTH OF ISLAND'S SHORELINE = 0.2 MILE

B.M. # 1 - TOP OF SPIKE IN 15" DBH ELM 15'
 FROM WATER'S EDGE 10' WEST OF BOAT
 RAMP AT ACCESS SITE ON NORTHWEST
 SIDE OF LAKE
 W.S.E. - 3.9' BELOW B.M. # 1
 B.M. # 2 - TOP OF 15" METAL CULVERT AT
 WATER'S EDGE 150' WEST OF ACCESS
 SITE ON NORTHWEST SIDE OF LAKE
 W.S.E. - 1.7' BELOW B.M. # 2

OUTLINE DRAWN FROM 1964 AERIAL
 PHOTOS - WE-2EE-64

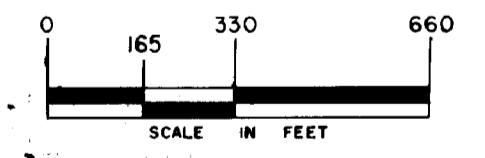

© COPYRIGHT 1993
 STATE OF MINNESOTA
 DEPARTMENT OF NATURAL RESOURCES

STATE OF MINNESOTA DEPARTMENT OF NATURAL RESOURCES		
DIVISION OF GAME AND FISH TECHNICAL SERVICES SECTION		
LOON LAKE 81-15 WASECA COUNTY		
T. 107 N. R. 22 W. S. 7, 18		
FIELDWORK RLM & CMH	DRAWN BY <i>RLM</i>	PROJ. IDENT. NO.
DATE 10/13/71	DATE 2/2/72	FW-1-R-16

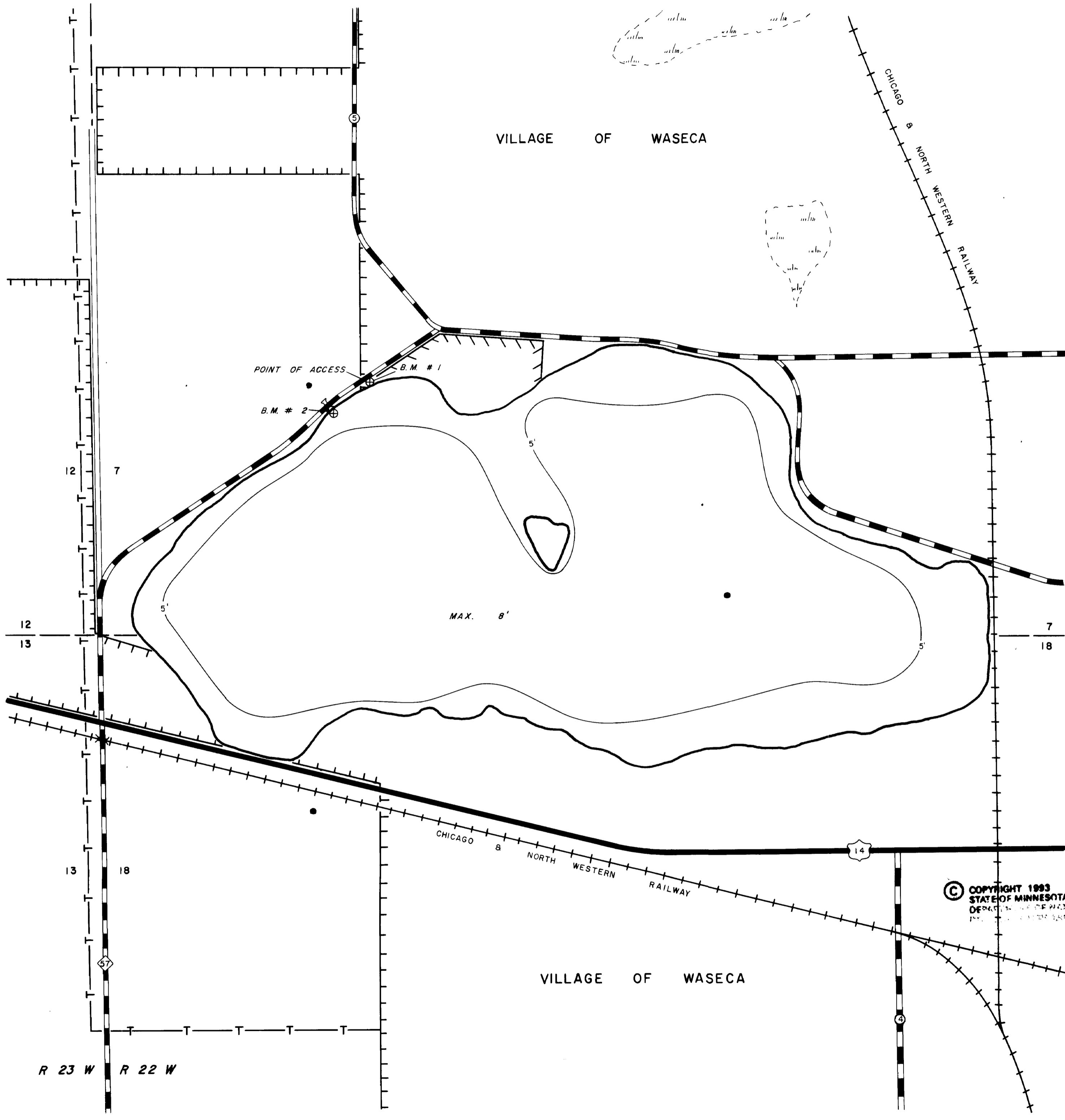

R 23 W R 22 W

VILLAGE OF WASECA