



LEGEND

- BITUMINOUS ROAD
- ▬ GRAVEL ROAD
- ③ COUNTY STATE AID HIGHWAY
- ⋯ INTERMITTENT STREAM
- ▬ MARSH AREA

PLANIMETERED AREA = 83.1 ACRES
 LITTORAL AREA = 48.6 ACRES
 LENGTH OF SHORELINE = 2.3 MILES

B.M. #1 = TOP OF NORTHWEST END OF
 18" C.M.C. UNDER DRIVE TO
 PUBLIC ACCESS AT NORTHEAST
 END OF LAKE.
 W.S. ELEV. = 1.4' BELOW B.M. #1

B.M. #2 = HIGH POINT OF 7' X 5' X 3'
 BOULDER, 10' FROM WATER'S
 EDGE ON EAST SIDE OF LAKE.
 W.S. ELEV. = 6.0' BELOW B.M. #2

OUTLINE DRAWN FROM 1957 AERIAL
 PHOTO DA-2T-78



© COPYRIGHT 1966
 STATE OF MINNESOTA
 DEPARTMENT OF NATURAL RESOURCES
 DIVISION OF FISH AND WILDLIFE

STATE OF MINNESOTA
 DEPARTMENT OF CONSERVATION

DIVISION OF GAME AND FISH
 RESEARCH AND PLANNING SECTION

ANDERSON LAKE 56-716
 OTTER TAIL COUNTY

T. 134-135 N. R. 42 W. S. 5, 32

| | | | | |
|-----------|----------|----------|----------|------------------|
| FIELDWORK | E. V. H. | DRAWN BY | D. B. D. | PROJ. IDENT. NO. |
| DATE | 7-13-66 | DATE | 2-2-67 | FW-18-II |

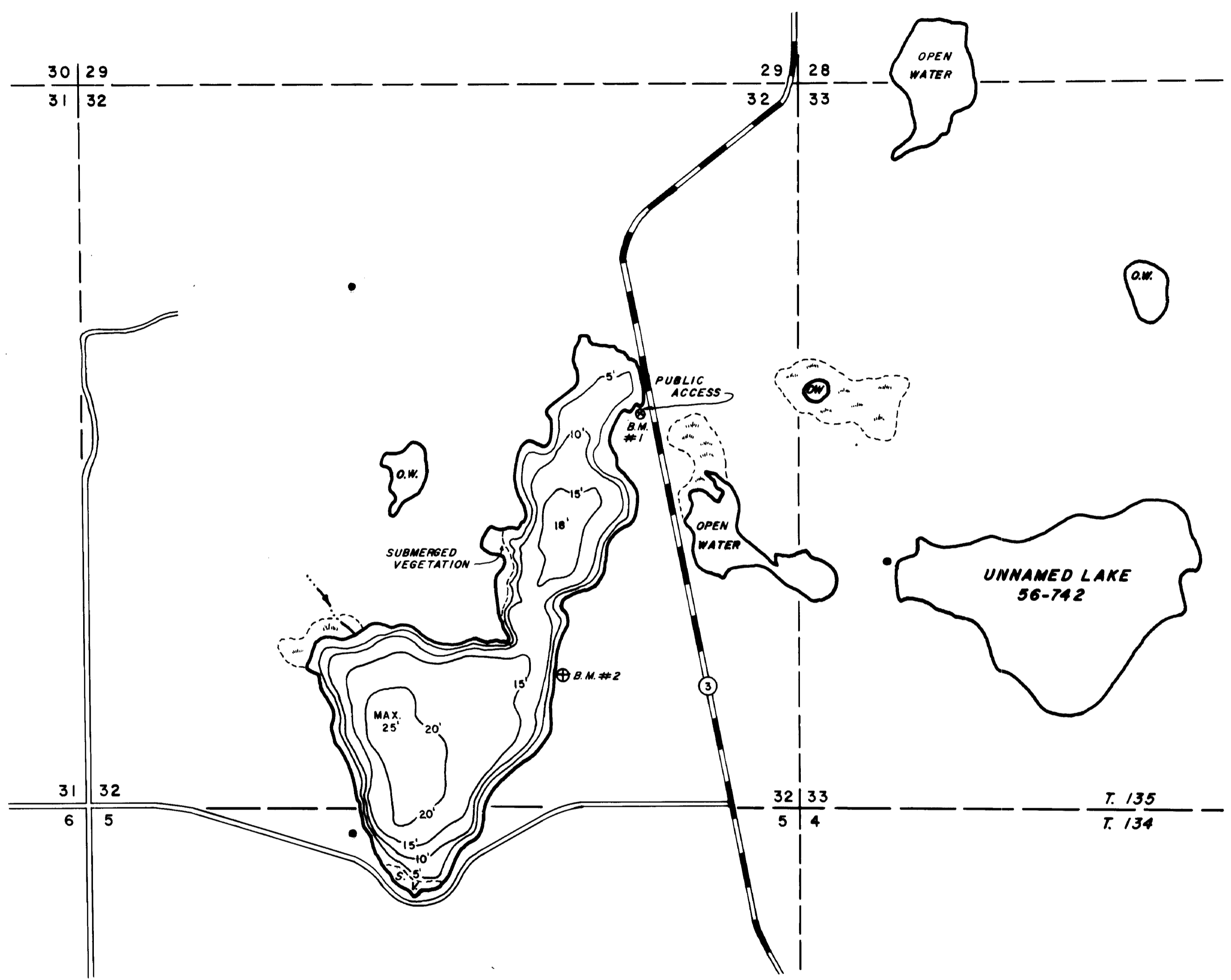

STATE OF MINNESOTA
 Department of
 Administration

Minnesota's Bookstore
 Part of the Department of Administration
 Print Communications Division
 To order reproduced copies of
 Contour Lake Maps call:
 612/297-3000 or our
 Nationwide toll-free number
 1-800-657-3757

