



LEGEND

- GRAVEL ROAD
- UNIMPROVED ROAD
- MARSH AREA

DART LAKE 3-474
 PLANIMETERED AREA = 30.5 ACRES
 LITTORAL AREA = 30.5 ACRES
 LENGTH OF SHORELINE = 0.8 MILE
 B.M. # 1 = TOP OF 5'X7'X7' BOULDER 30' FROM WATER'S EDGE ON NORTH CENTRAL SIDE OF LAKE.
 W. S. ELEV. = 11.6' BELOW B.M. 8-17-65 D.C.J.
 B.M. # 2 = TOP OF 3'X3'X6' BOULDER 30' FROM WATER'S EDGE ON EAST SIDE OF LAKE.
 W. S. ELEV. = 11.8' BELOW B.M.

SPEAR LAKE 3-485
 PLANIMETERED AREA = 67.6 ACRES
 LITTORAL AREA = 60.0 ACRES
 LENGTH OF SHORELINE = 1.9 MILES
 B.M. # 1 = TOP OF 2'X3' BOULDER AT BASE OF 20" DBH ELM ON WATER'S EDGE ON NORTH SIDE OF LAKE.
 W. S. ELEV. = 3.1' BELOW B.M. 9-2-65 J.A.W.
 B.M. # 2 = TOP OF 3'X4' BOULDER AMONG PILE OF ROCKS ON NORTH SIDE OF LAKE.
 W. S. ELEV. = 2.7' BELOW B.M.

PEARL LAKE 3-486
 PLANIMETERED AREA = 236.8 ACRES
 LITTORAL AREA = 168.2 ACRES
 LENGTH OF SHORELINE = 3.7 MILES
 B.M. # 1 = TOP OF FLAT 3'X5'X5' BOULDER 2' FROM WATER'S EDGE ON NORTH SIDE OF LAKE.
 W. S. ELEV. = 7.9' BELOW B.M. 8-18-65 D.C.J.
 B.M. # 2 = TOP OF POINTED 4'X6'X7' GRANITE BOULDER 20' FROM WATER'S EDGE ON NORTHWEST SIDE OF LAKE.
 W. S. ELEV. = 7.4' BELOW B.M.

OUTLINE DRAWN FROM 1958 AERIAL PHOTOS, BXO-IV-65, 66, 141, 142.

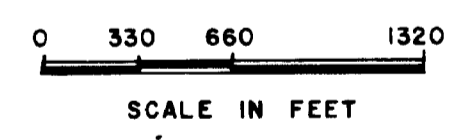

© COPYRIGHT 1983
 STATE OF MINNESOTA
 DEPARTMENT OF NATURAL RESOURCES
 DIVISION OF GAME AND WILDLIFE

STATE OF MINNESOTA
 DEPARTMENT OF CONSERVATION

DIVISION OF GAME AND FISH
 RESEARCH AND PLANNING SECTION

DART, SPEAR, PEARL LAKES
 BECKER COUNTY

T. 138 N. R. 41-42 W. S. VARIOUS

FIELDWORK D.C.J., J.A.W. DATE 8-17, 18-65 9-2-65	DRAWN BY R.A.C. DATE 12-15-66	PROJ. INVT. NO. FW-1-B-11
--	----------------------------------	------------------------------

DART LAKE 3-473

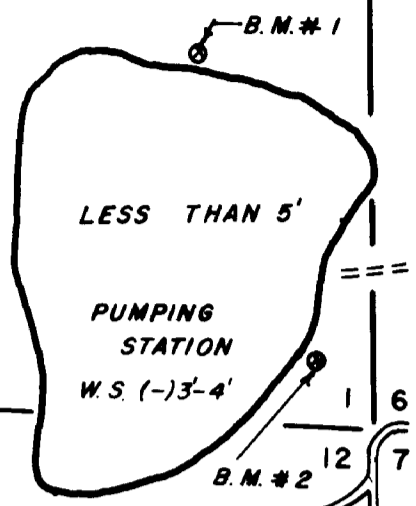

LITTLE PEARL LAKE 3-487
 COVERED WITH SCATTERED VEGETATION

PEARL LAKE 3-486

SPEAR LAKE 3-485

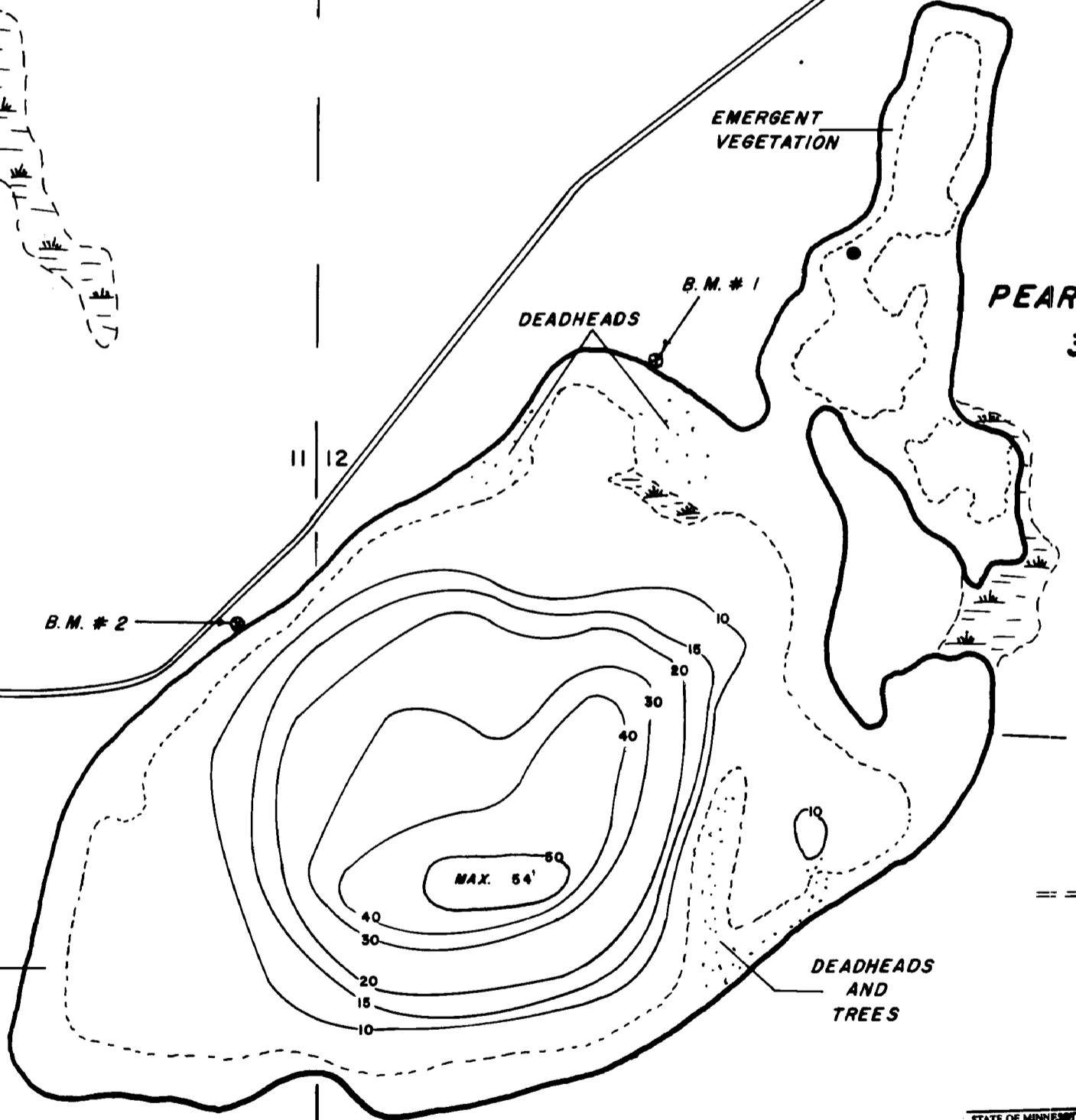
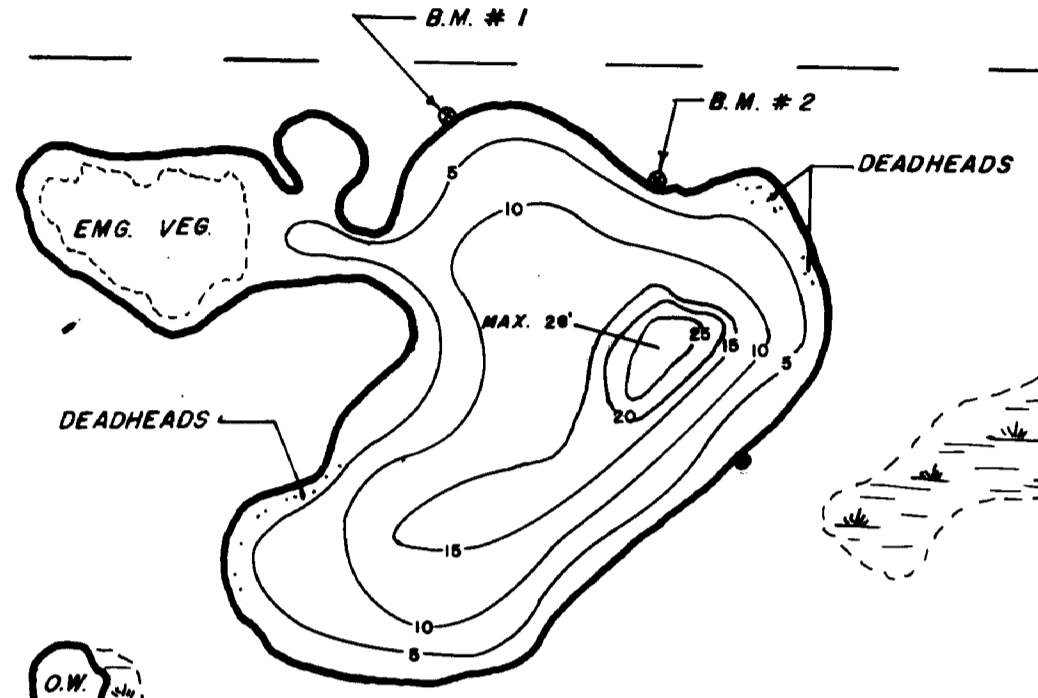

Minnesota's Bookstore
 Part of the Department of Administration
 Print Communications Division
 To order reproduced copies of
 Contour Lake Maps call:
 612/297-3000 or our
 Nationwide toll-free number
 1-800-657-3757

