

N

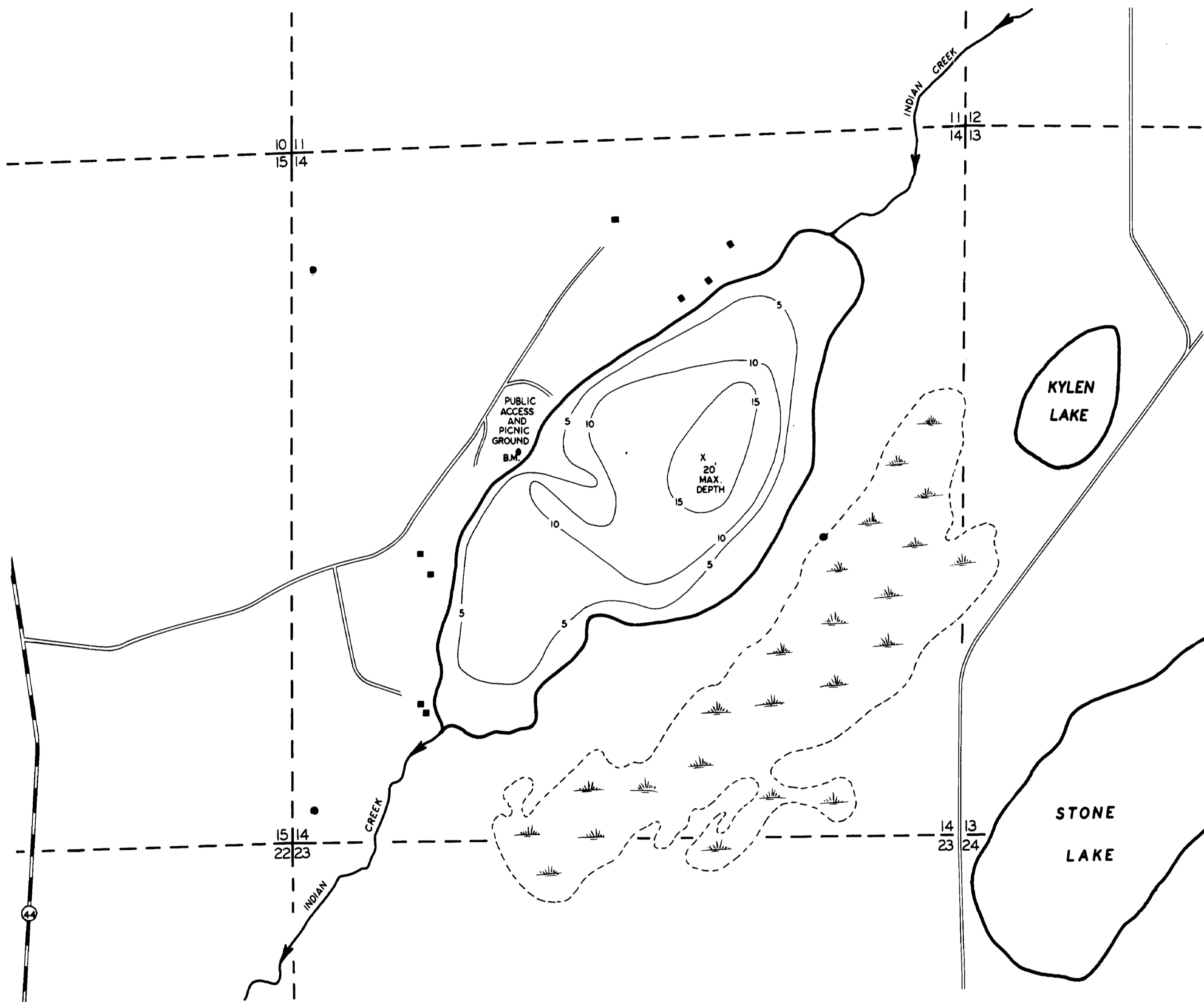

LEGEND

- COUNTY STATE AID HIGHWAY
- BITUMINOUS ROADWAY
- GRAVEL ROAD
- MARSH

PLANIMETERED AREA = 137 ACRES
 LITTORAL AREA = 127 ACRES

B.M. = TOP OF GREEN STEEL STAKE AT BASE OF
 12" D. B.H. WHITE BIRCH ON W. SIDE OF LAKE AT
 PICNIC GROUNDS, 30' FROM WATER'S EDGE NEAR
 BOAT LANDING.
 W. S. ELEV. = 5.7' BELOW B.M.

OUTLINE DRAWN FROM 1948 FOREST SERVICE
 TIMBER SURVEY MAP.

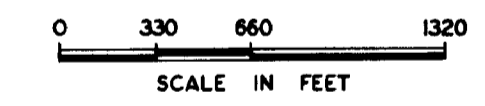

© COPYRIGHT 1993
 STATE OF MINNESOTA
 DEPARTMENT OF NATURAL RESOURCES
 DIVISION OF FISH AND WILDLIFE

STATE OF MINNESOTA
 Department of
 Administration
Minnesota's Bookstore
Part of the Department of Administration
Print Communications Division
 To order reproduced copies of
 Contour Lake Maps call:
 612/297-3000 or our
 Nationwide toll-free number
 1-800-657-3757



© State of Minnesota 1964

STATE OF MINNESOTA DEPARTMENT OF CONSERVATION		
DIVISION OF GAME AND FISH RESEARCH AND PLANNING SECTION		
SALO LAKE 69-36 ST. LOUIS COUNTY		
T. 56 N. R. 12 W. S. 14		
FIELDWORK	D. A. L.	PROJ. IDENT. NO.
DATE	9-23-63	F.W.-1-R-8
DRAWN BY	D. A. L.	
DATE	2-13-64	

© State of Minnesota 1964

C-1470