

R-9
U.S. Department of Agriculture
Forest Service
LAKE AND STREAM SURVEY
PFEIFFER LAKE
Superior National Forest
Minnesota

APRIL 1983
STATE OF MINNESOTA
DEPARTMENT OF NATURAL RESOURCES
DIVISION OF FISH AND WILDLIFE

Location Sec. 23, T61N R17W
Scale 8"=1 Mile

Area 54.3 Acres
Length of Shoreline 1.4 Miles

THE INFORMATION FURNISHED BY THE MINNESOTA
DEPARTMENT OF NATURAL RESOURCES IS FOR
GENERAL INFORMATION ONLY. NO RESPONSIBILITY IS ASSUMED FOR
THE ACCURACY OF THE DATA SHOWN OR FOR
ANY DAMAGES OR LOSSES MADE BY OWNERS IF
THEY ARE USED FOR PURPOSES OTHER THAN
THOSE FOR WHICH THE DATA WAS
PRODUCED. PLEASE CREDIT MAPS TO:
STATE OF MINNESOTA
DEPARTMENT OF NATURAL RESOURCES
DIVISION OF FISH AND WILDLIFE

N

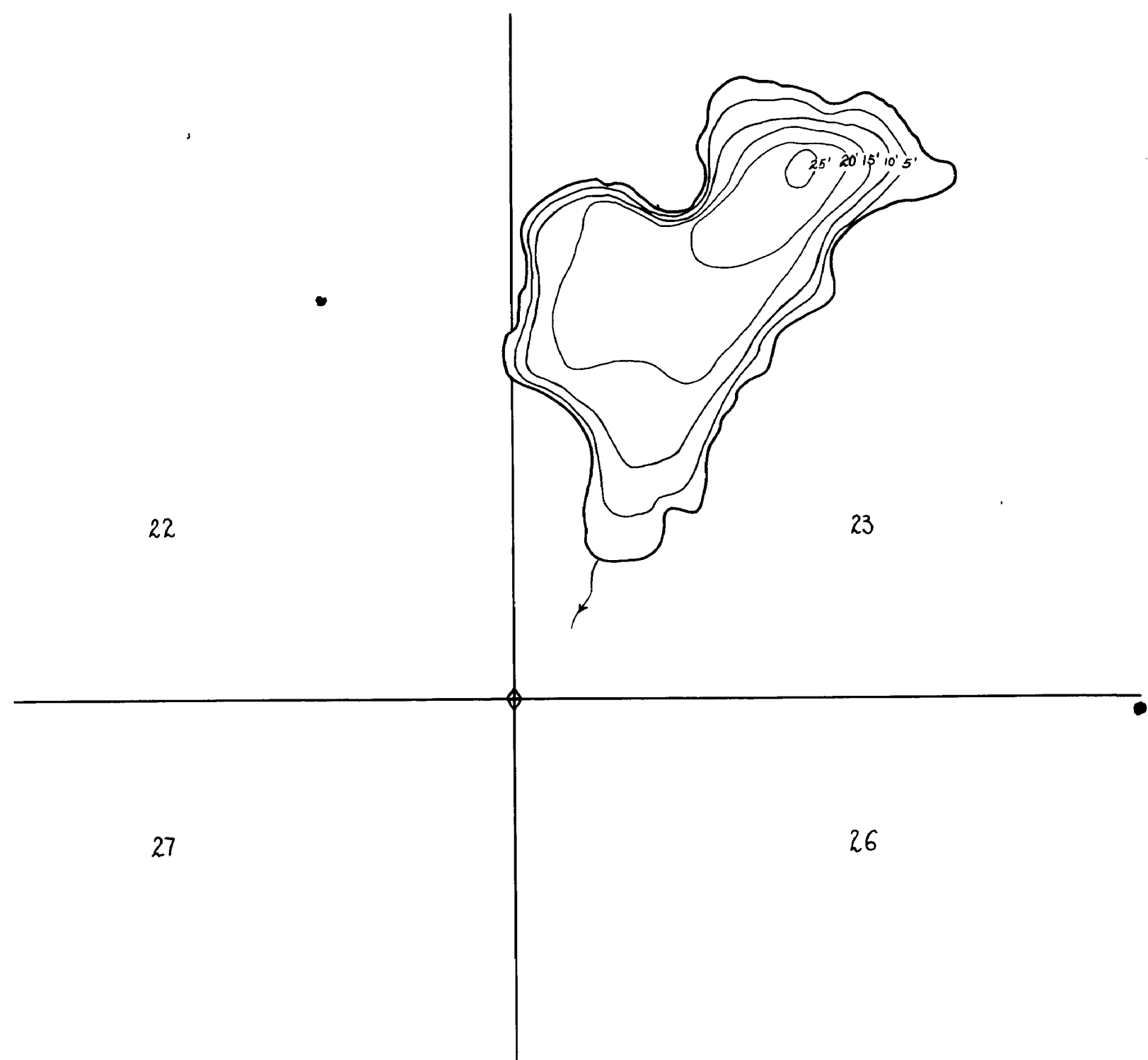

Contour Map
• Contour Interval 5'

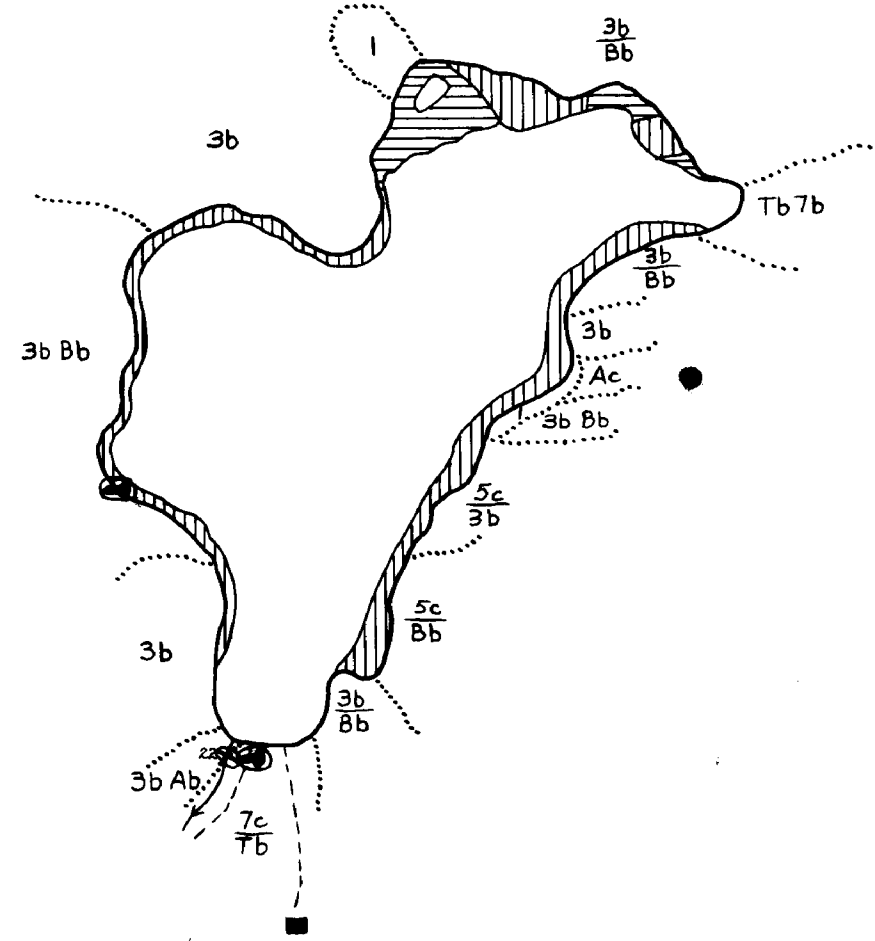

Cover Type and
Lake Bottom Soil Type Map

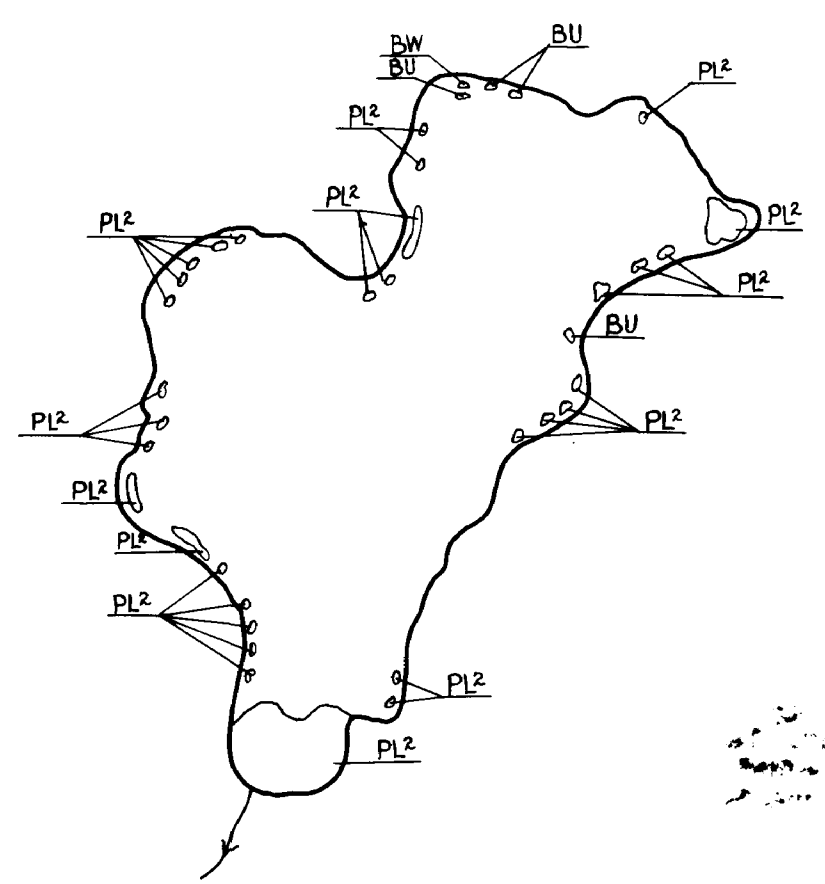

Aquatic Vegetation Map

Pfeiffer Lake

810