

Minnesota State E.C.M.  
 Lake Survey  
 Kabehona Lake  
 Scale 1:600 March 3, 1937  
 Camp 5-134 Surveyed by Rex R. Lawson  
 Mapped by Don Wright  
 Area = 2700 Acres  
 Hubbard Co.

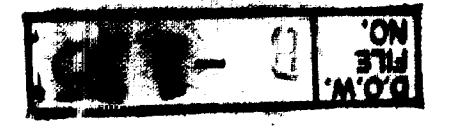

STATE OF MINNESOTA  
 DEPARTMENT OF NATURAL RESOURCES  
 DIVISION OF FISH AND WILDLIFE  
 COPYRIGHT 1937

Outside of Sand - Inside is Clay

REPRODUCED FROM ORIGINAL SURVEY MAP  
 THIS MAP IS NOT TO BE USED FOR  
 ANY OTHER PURPOSES WITHOUT  
 THE WRITTEN PERMISSION OF THE  
 STATE OF MINNESOTA

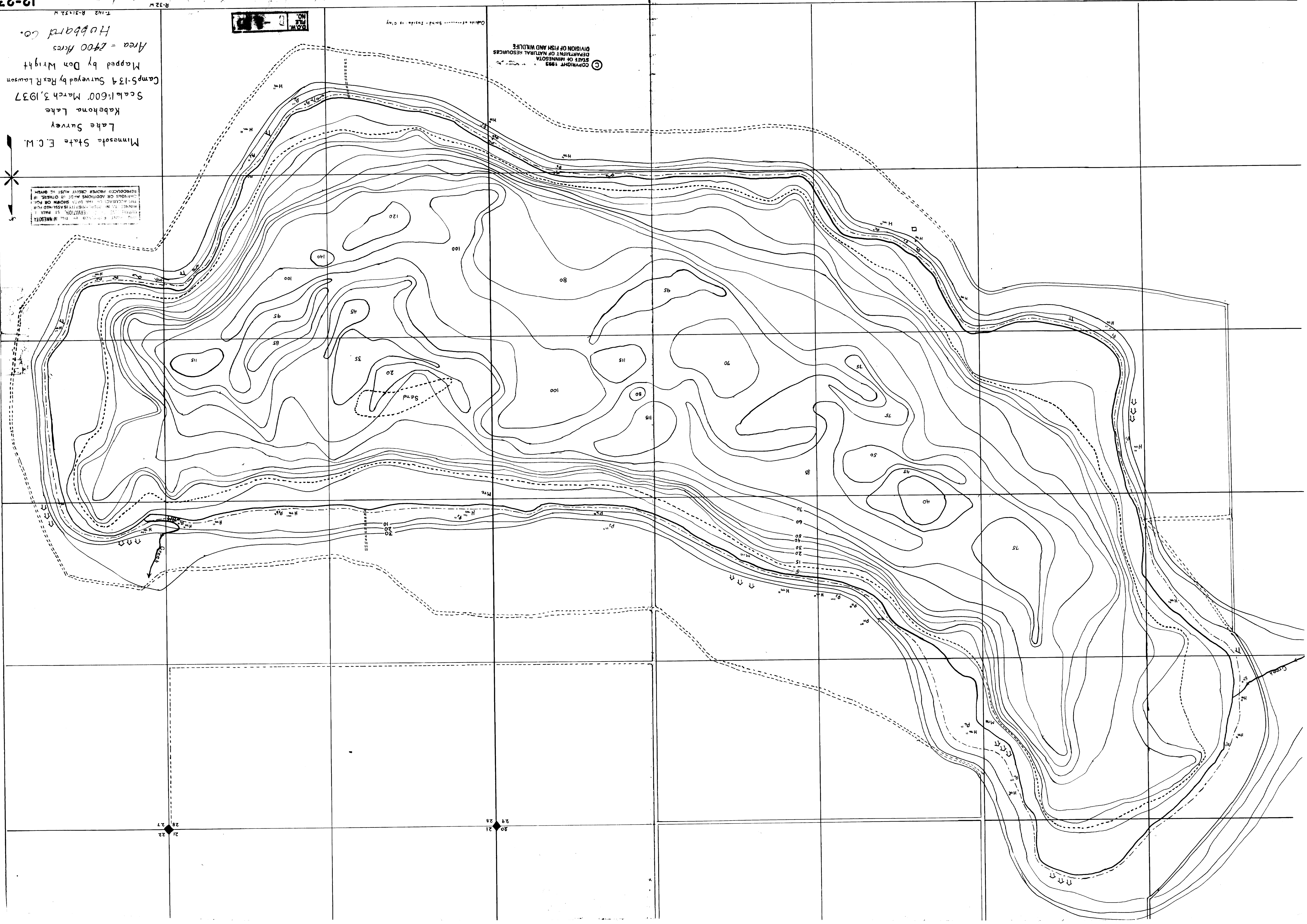

22  
28  
27

21  
29  
28