

STATE OF MINNESOTA
 Department of Administration
 Minnesota's Bookstore
 Part of the Department of Administration
 Print Communications Division
 To order reproduced copies of
 Contour Lake Maps call:
 612/297-3000 or our
 Nationwide toll-free number
 1-800-857-3757

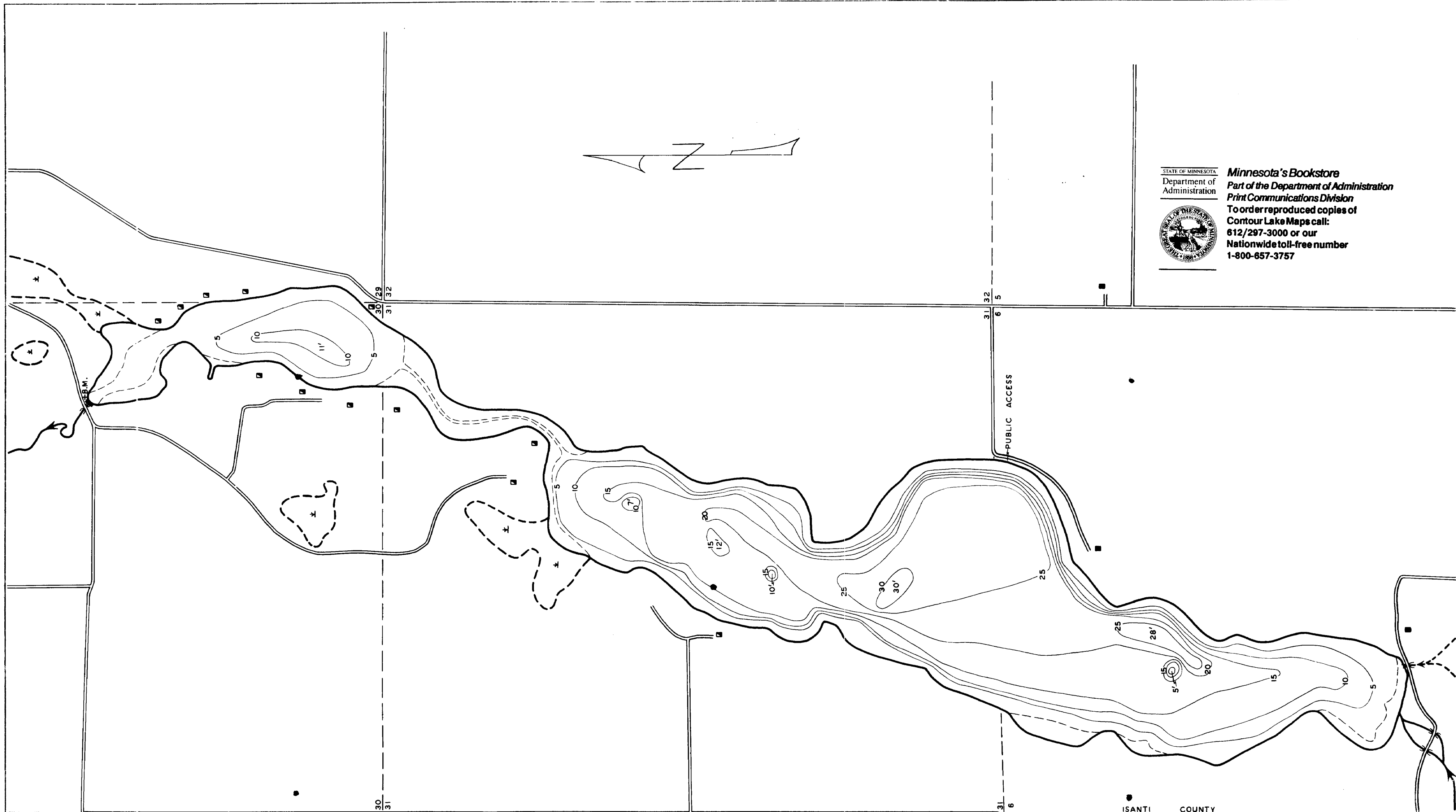

ISANTI COUNTY
 SHERBURNE COUNTY

© COPYRIGHT 1993
 STATE OF MINNESOTA
 DEPARTMENT OF NATURAL RESOURCES
 DIVISION OF FISH AND WILDLIFE

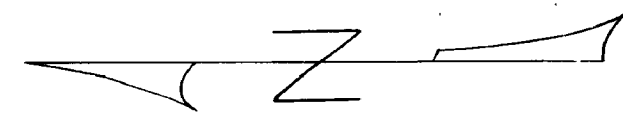

THIS MAP PUBLISHED BY THE MINNESOTA
 DEPARTMENT OF CONSERVATION, DIVISION OF
 FISH AND WILDLIFE, IS A REPRODUCTION OF
 A MAP PUBLISHED BY THE MINNESOTA
 DEPARTMENT OF CONSERVATION, DIVISION OF
 FISH AND WILDLIFE, IN 1964. THE
 REPRODUCTION OF THIS MAP IS FOR
 INFORMATIONAL PURPOSES ONLY. THE
 ORIGINAL MAP IS THE AUTHORITY FOR
 ANY DISCREPANCIES. IF REPRODUCED
 PROPER CREDIT MUST BE GIVEN.

B.M. = TOP LAKESIDE CORNER OF E. CONCRETE ABUTEMENT ON
 DAM N. END OF LAKE.
 V.S. = B.M. - 1.85'
 AREA = 309 ACRES. (PLANIMETERED)

STATE OF MINNESOTA DEPARTMENT OF CONSERVATION		
DIVISION OF GAME AND FISH RESEARCH AND PLANNING SECTION		
BLUE LAKE 30-107 ISANTI COUNTY		
TWP. 34-35 N.	R. 25 W.	SEC. 6, 29-31
FIELDWORK D. G. L.	DRAWN BY D. G. L.	PROJ. IDENT. NO.
DATE 9-19-58	DATE 3-30-59	FW-4R-3

State of Minnesota 1964

103
 OUTLINE TRACES FROM 1953 AERIAL PHOTO.