

© COPYRIGHT 1993  
STATE OF MINNESOTA  
DEPARTMENT OF NATURAL RESOURCES  
DIVISION OF FISH AND WILDLIFE

R-9  
U.S. Department of Agriculture  
Forest Service  
LAKE AND STREAM SURVEY  
DAMON LAKE - WEBSTER LAKE  
Chippewa National Forest  
Minnesota

Damon Lake Area 53.5 Acres  
Webster Lake Area 47.6 Acres  
Damon Lake Length of Shoreline 1.15 Miles  
Webster Lake Length of Shoreline 1.06 Miles

Scale: 8 Inches = 1 Mile

BELTRAMI & ITASCA COUNTIES

Damon Lake 31-944  
Location: Sec. 30, T.148N.R.29W.  
Sec. 25, T.148N.R.30W.

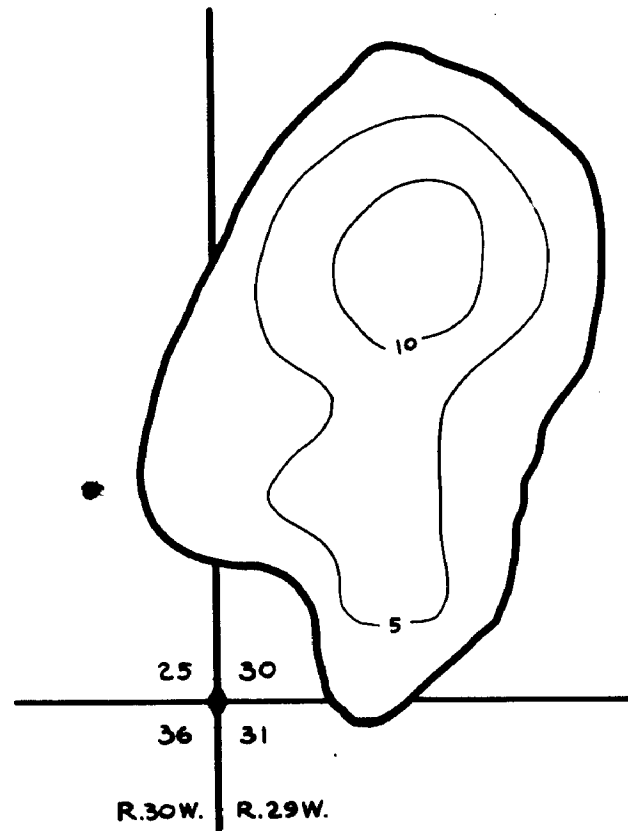

Contour Map  
Contour Interval = 5'

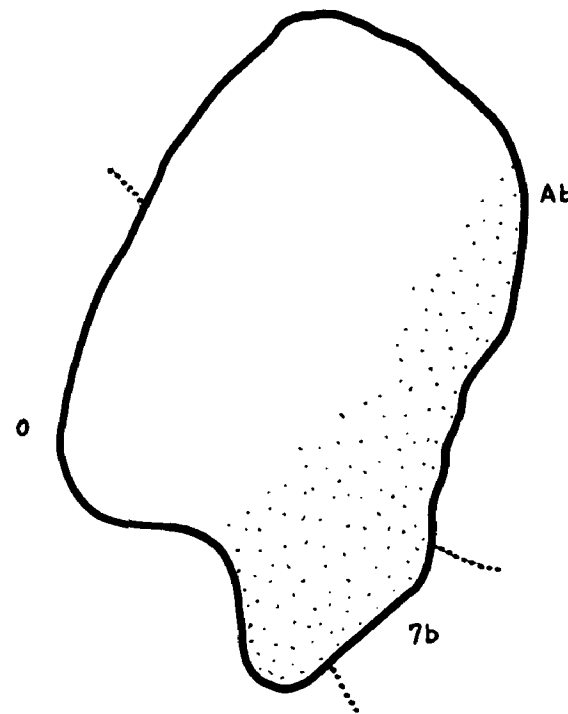

Cover Type And  
Lake Bottom Soil Type Map

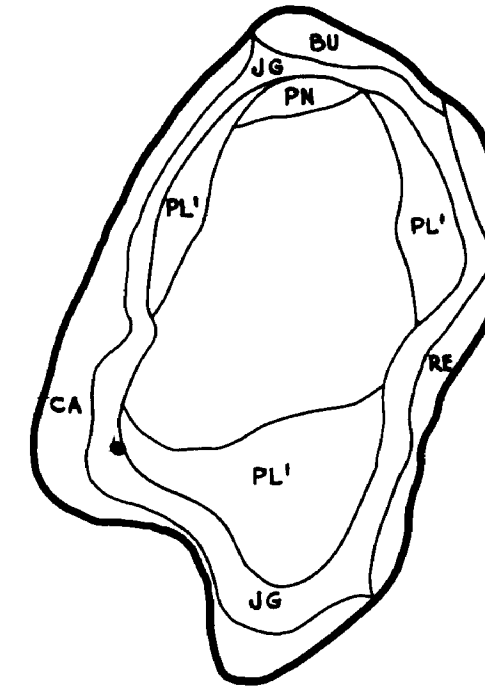

Aquatic Vegetation Map

Webster Lake 4-22  
Location: Sec. 29 & 32, T.148N.R.30W.

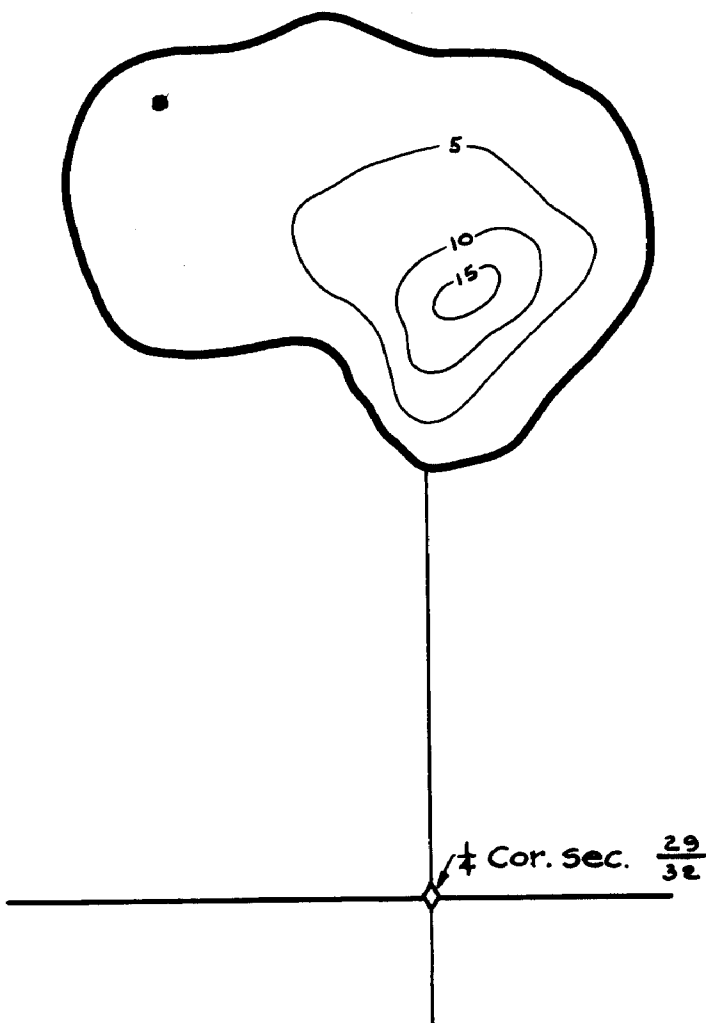

Contour Map  
Contour Interval = 5'

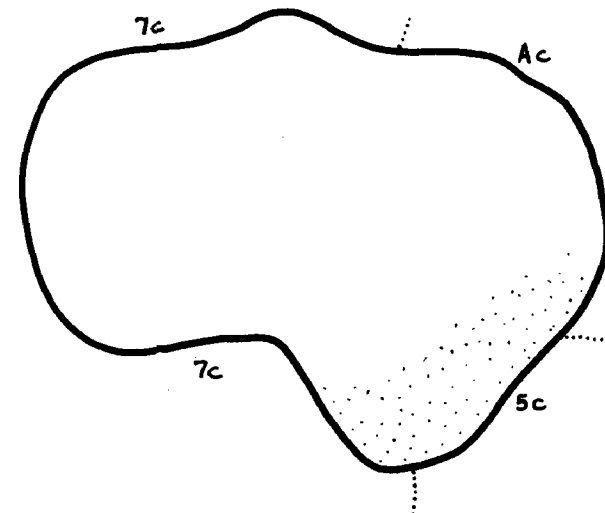

Cover Type And  
Lake Bottom Soil Type Map

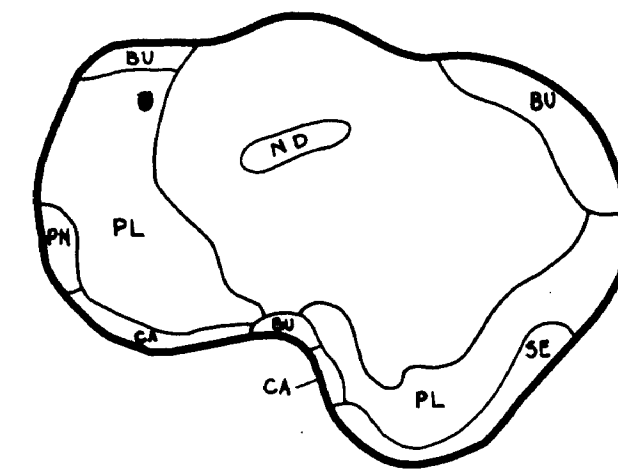

Aquatic Vegetation Map

© State of Minnesota 1964

STATE OF MINNESOTA  
Department of  
Administration

Minnesota's Bookstore  
Part of the Department of Administration  
Print Communications Division  
To order reproduced copies of  
Contour Lake Maps call:  
612/297-3000 or our  
Nationwide toll-free number  
1-800-687-3767



© State of Minnesota

168