

C-0528

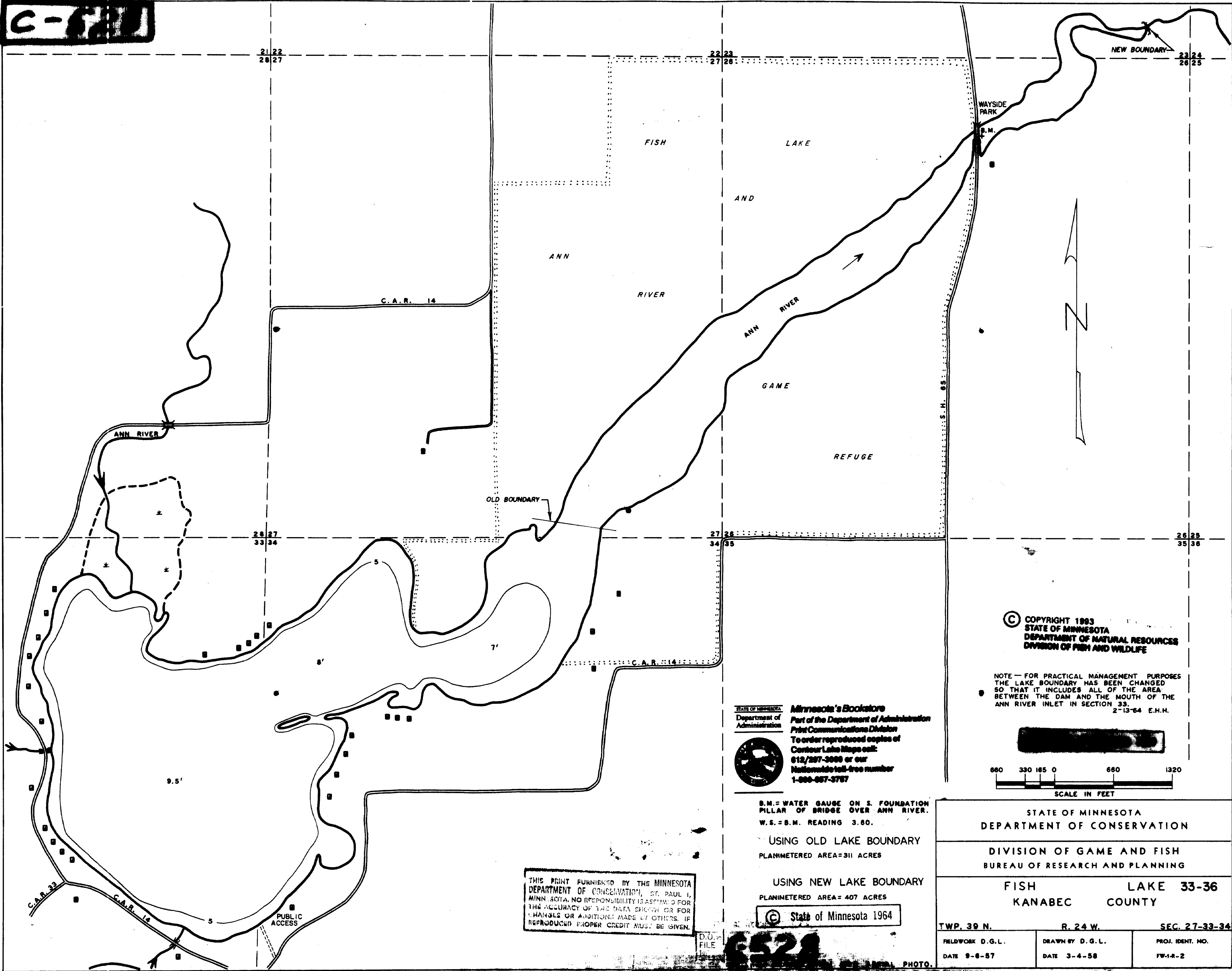

© COPYRIGHT 1993
 STATE OF MINNESOTA
 DEPARTMENT OF NATURAL RESOURCES
 DIVISION OF FISH AND WILDLIFE

NOTE - FOR PRACTICAL MANAGEMENT PURPOSES
 THE LAKE BOUNDARY HAS BEEN CHANGED
 SO THAT IT INCLUDES ALL OF THE AREA
 BETWEEN THE DAM AND THE MOUTH OF THE
 ANN RIVER INLET IN SECTION 33.
 2-13-64 E.H.H.

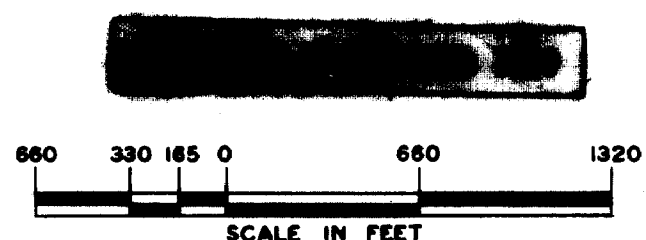

STATE OF MINNESOTA
 Department of Administration
Minnesota's Bookstore
 Part of the Department of Administration
 Print Communications Division
 To order reproduced copies of
 Contour Lake Maps call:
 612/297-3000 or our
 Nationwide toll-free number
 1-800-657-3787

B.M. = WATER GAUGE ON S. FOUNDATION
 PILLAR OF BRIDGE OVER ANN RIVER.
 W.S. = B.M. READING 3.60.

USING OLD LAKE BOUNDARY
 PLANIMETERED AREA = 311 ACRES

USING NEW LAKE BOUNDARY
 PLANIMETERED AREA = 407 ACRES

© State of Minnesota 1964

THIS PRINT FURNISHED BY THE MINNESOTA
 DEPARTMENT OF CONSERVATION, ST. PAUL 1,
 MINN. 55454. NO RESPONSIBILITY IS ASSUMED FOR
 THE ACCURACY OF THE DATA SHOWN OR FOR
 CHANGES OR ADDITIONS MADE BY OTHERS. IF
 REPRODUCED PROPER CREDIT MUST BE GIVEN.

STATE OF MINNESOTA DEPARTMENT OF CONSERVATION		
DIVISION OF GAME AND FISH BUREAU OF RESEARCH AND PLANNING		
FISH LAKE 33-36 KANABEC COUNTY		
TWP. 39 N.	R. 24 W.	SEC. 27-33-34
FIELDWORK D.G.L. DATE 9-6-57	DRAWN BY D.G.L. DATE 3-4-58	PROJ. IDENT. NO. FW-1-R-2

D.O. FILE
 6528
 PHOTO.

C-0528