

CHUB LAKE - RICE LAKE NUSHKA LAKE Chippewa National Forest Minnesota

DEPARTMENT OF CONSERVATION, ST. PAUL, MINN.
MINNESOTA. NO RESPONSIBILITY IS ASSUMED FOR
THE ACCURACY OF THE DATA SHOWN OR FOR
CHANGES OR ADDITIONS MADE BY OTHERS. IF
REPRODUCED PROPER CREDIT MUST BE GIVEN

Chub Lake 11-11
Location Sec. 25 T.144N. R.27W.
Scale 8 inches = 1 Mile
Area 60 Acres
Length of Shoreline 1.3 Miles

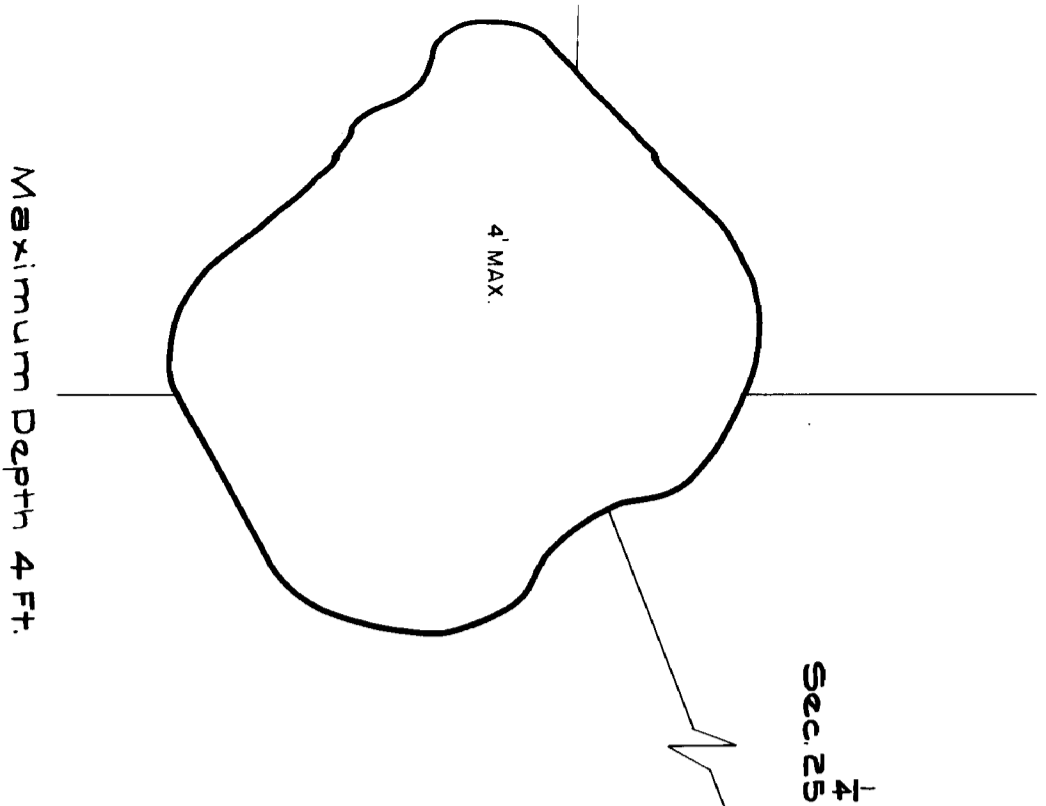

Maximum Depth 4 Ft.

Nushka Lake 11-138
Location Secs. 33, 34 T.145N. R.27W.
Scale 4 inches = 1 Mile
Area 195 Acres
Length of Shoreline 2.5 Miles

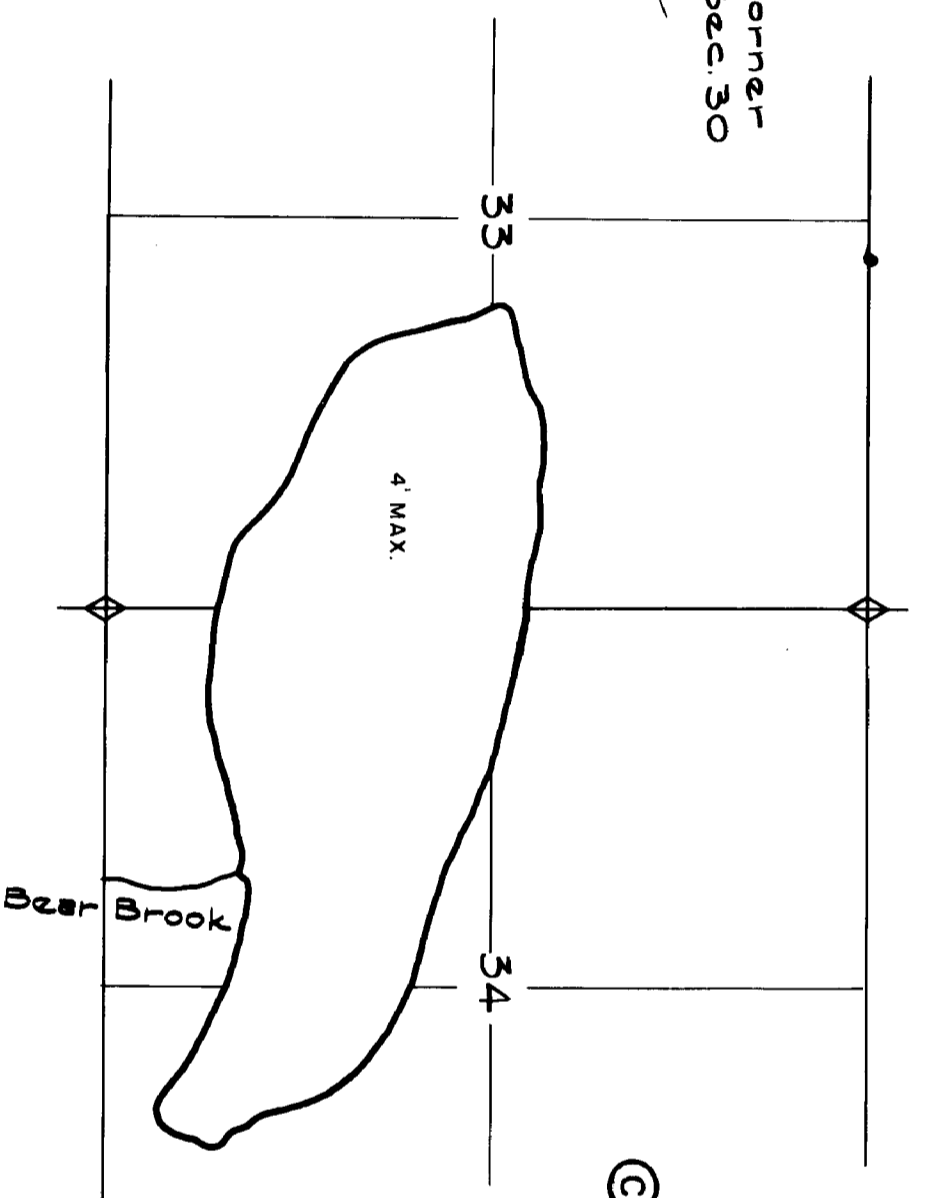

Contour Maps

Rice Lake 11-137
Location Secs. 26, 27, 34, 35 T.145N. R.27W.
Scale 8 inches = 1 Mile
Area 53 Acres
Length of Shoreline 1.3 Miles

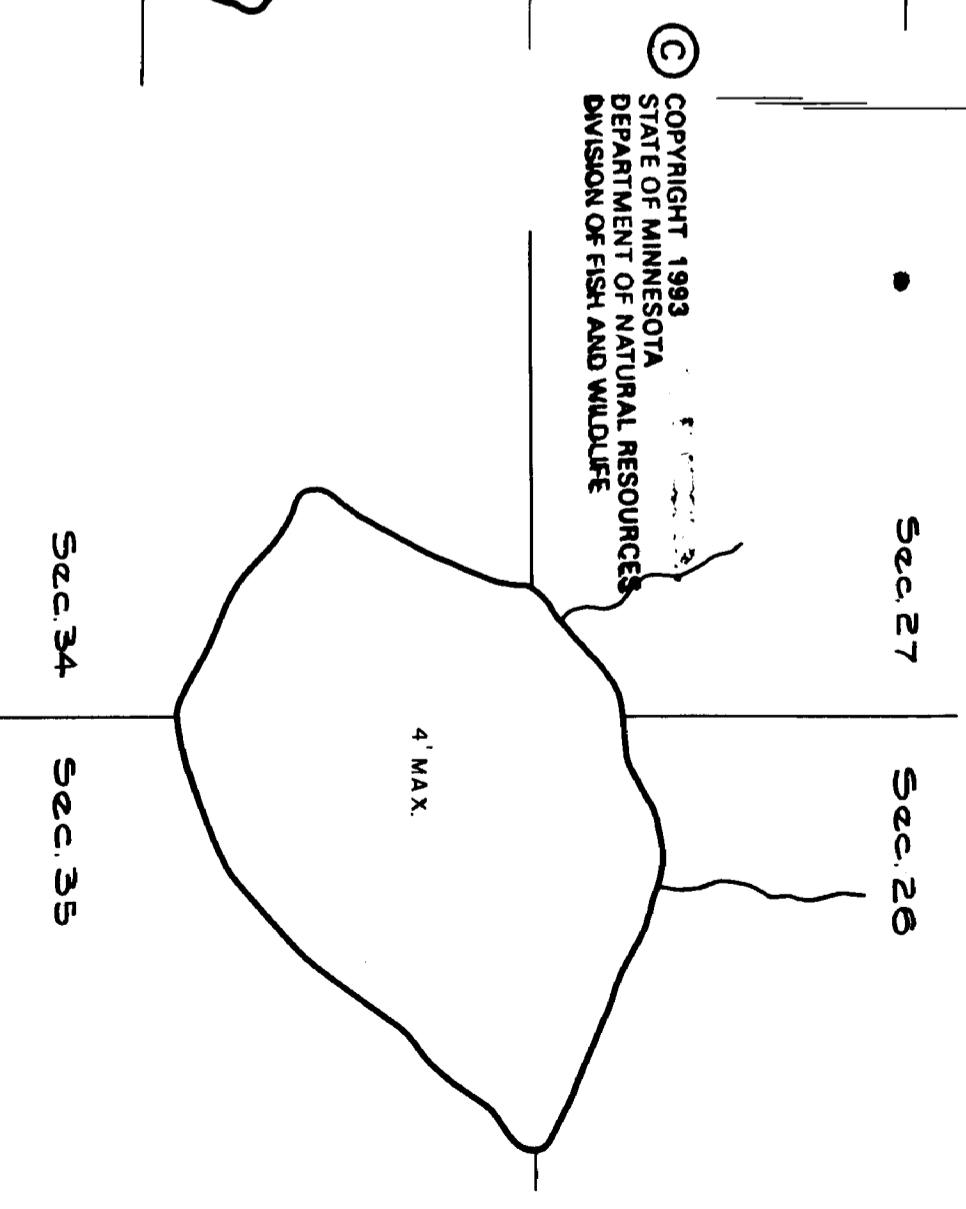

© COPYRIGHT 1993
STATE OF MINNESOTA
DEPARTMENT OF NATURAL RESOURCES
DIVISION OF FISH AND WILDLIFE

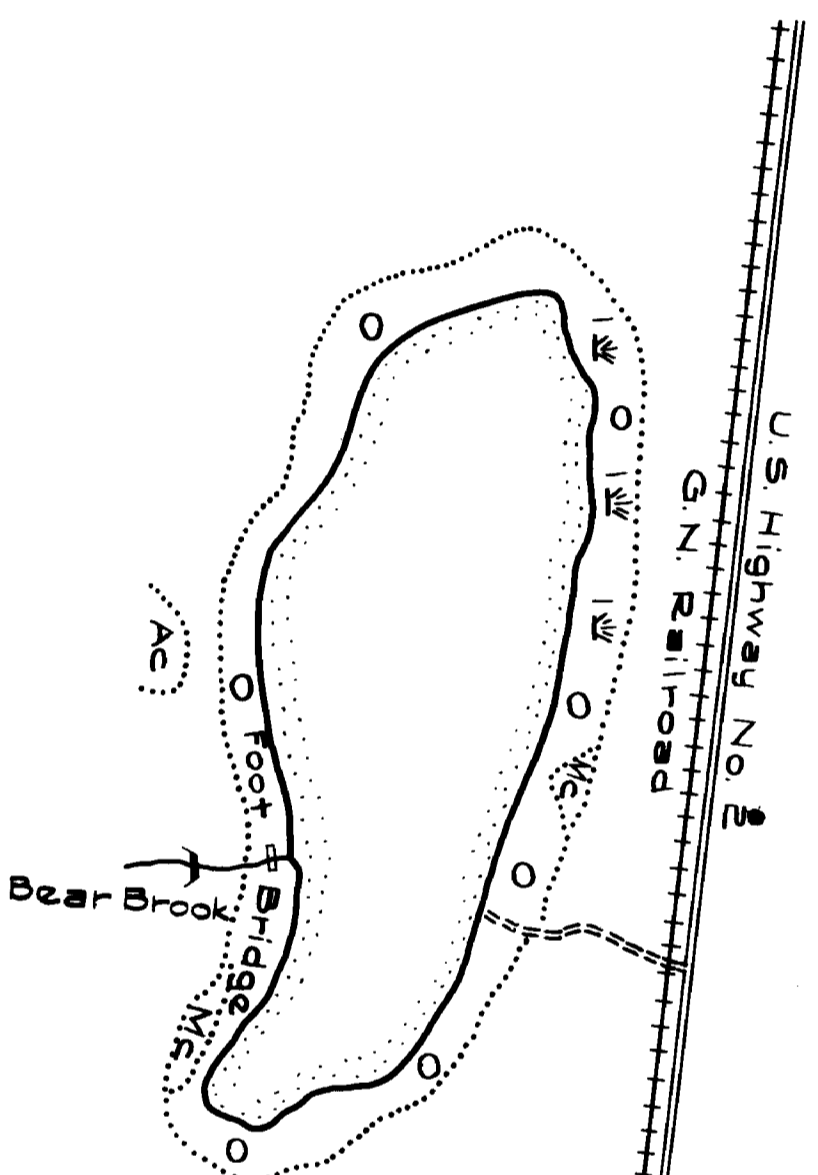
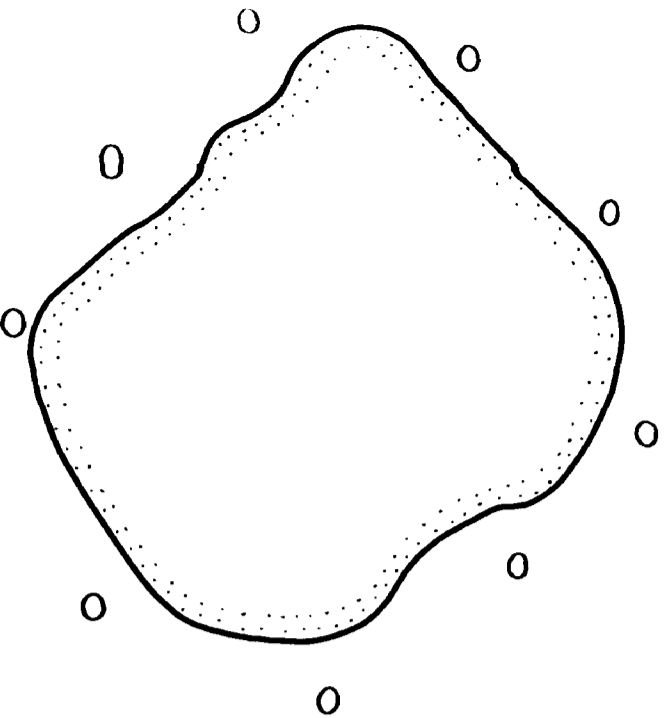

Cover Type And
Lake Bottom Soil Type Maps

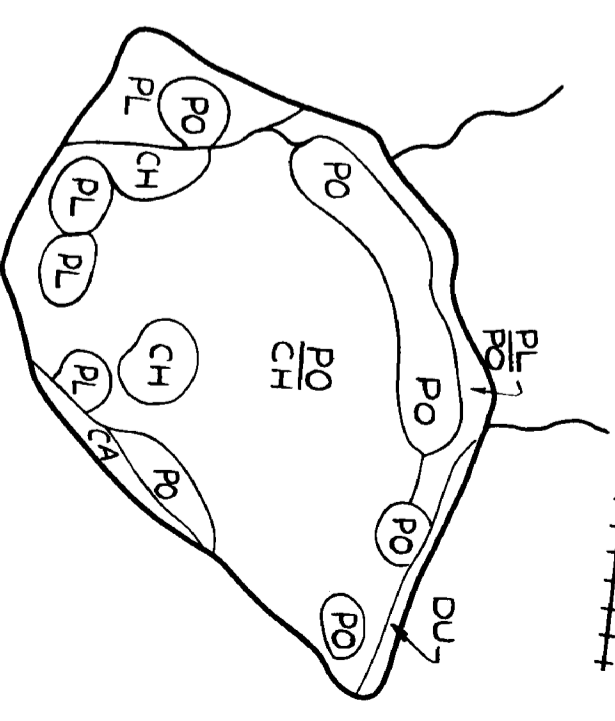
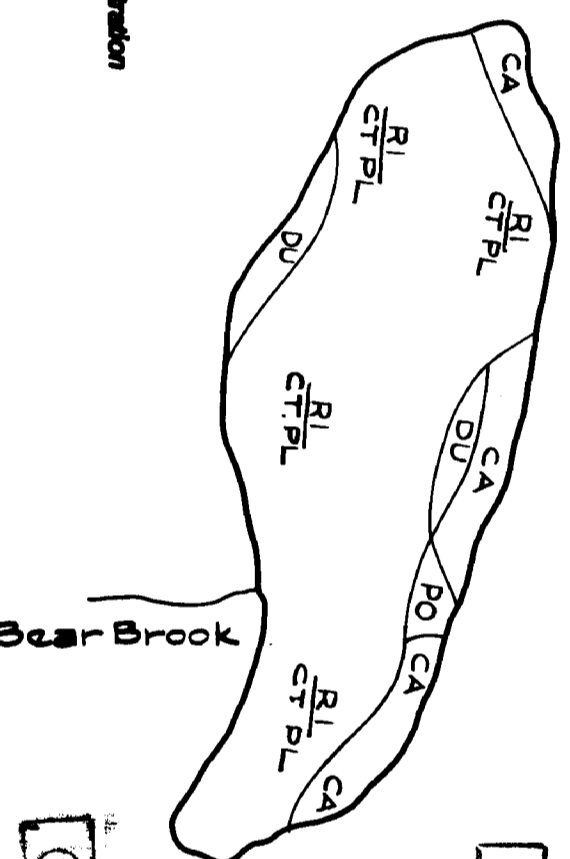
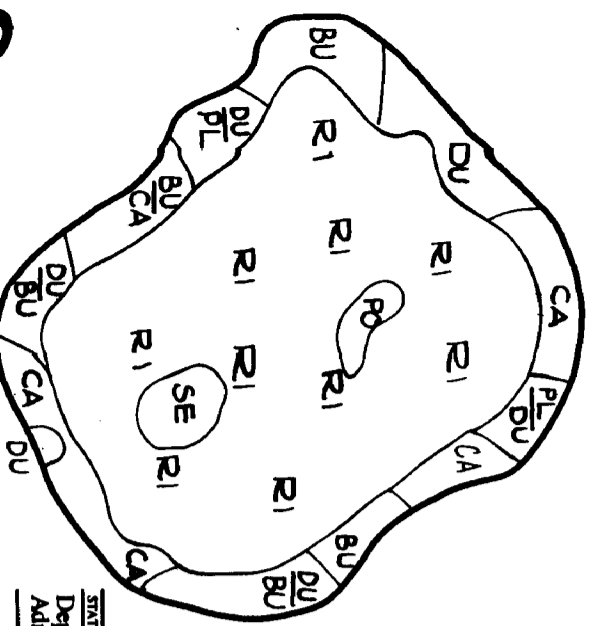
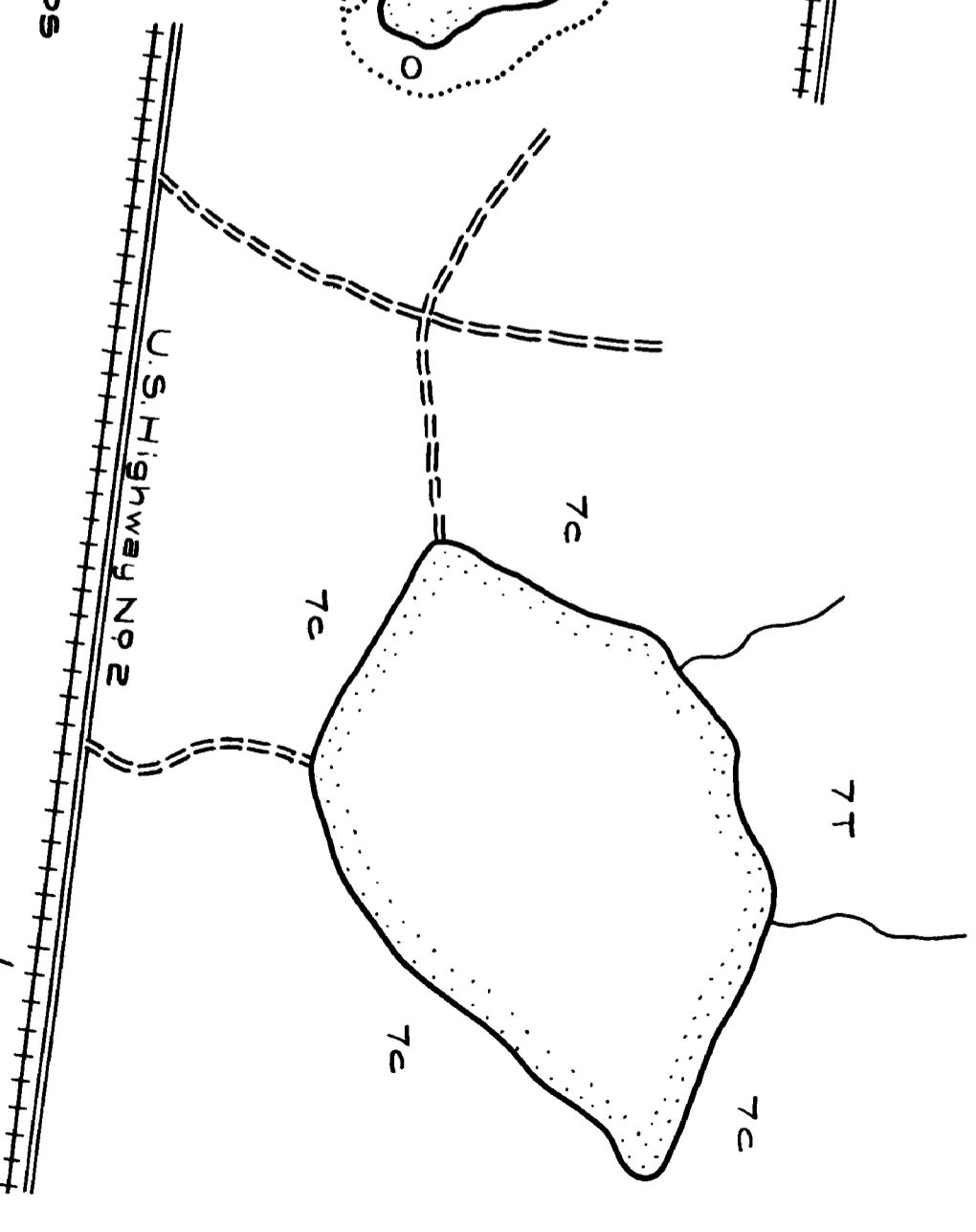

© State of Minnesota 1964



MINNESOTA'S BOOKSTORE
Part of the Department of Administration
Print Communications Division
To order reproduced copies of
Contour Lake Maps call:
612/297-3000 or our
Nationside toll-free number
1-800-657-3757