

STATE OF MINNESOTA
 DIVISION OF GAME & FISH
 FISHERIES RESEARCH UNIT
GRANT LAKE 4-217
 T. 146 N. R. 34 W. S. 4
 BELTRAMI CO.
 FIELD WORK: 5-27-47 DRAWN BY: JHA

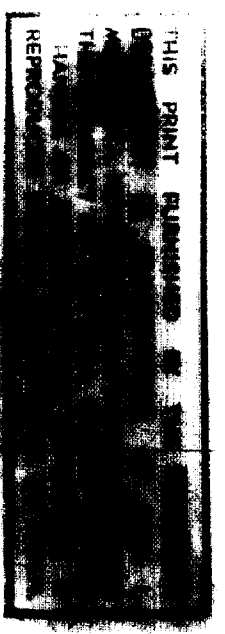

B.M. ELEV. 10121.0 C.C. DATUM-1937
 READING TAKEN FROM TOP OF
 CONCRETE BASE OF WATER
 PUMP, 6.21' ABOVE WATER LEVEL.

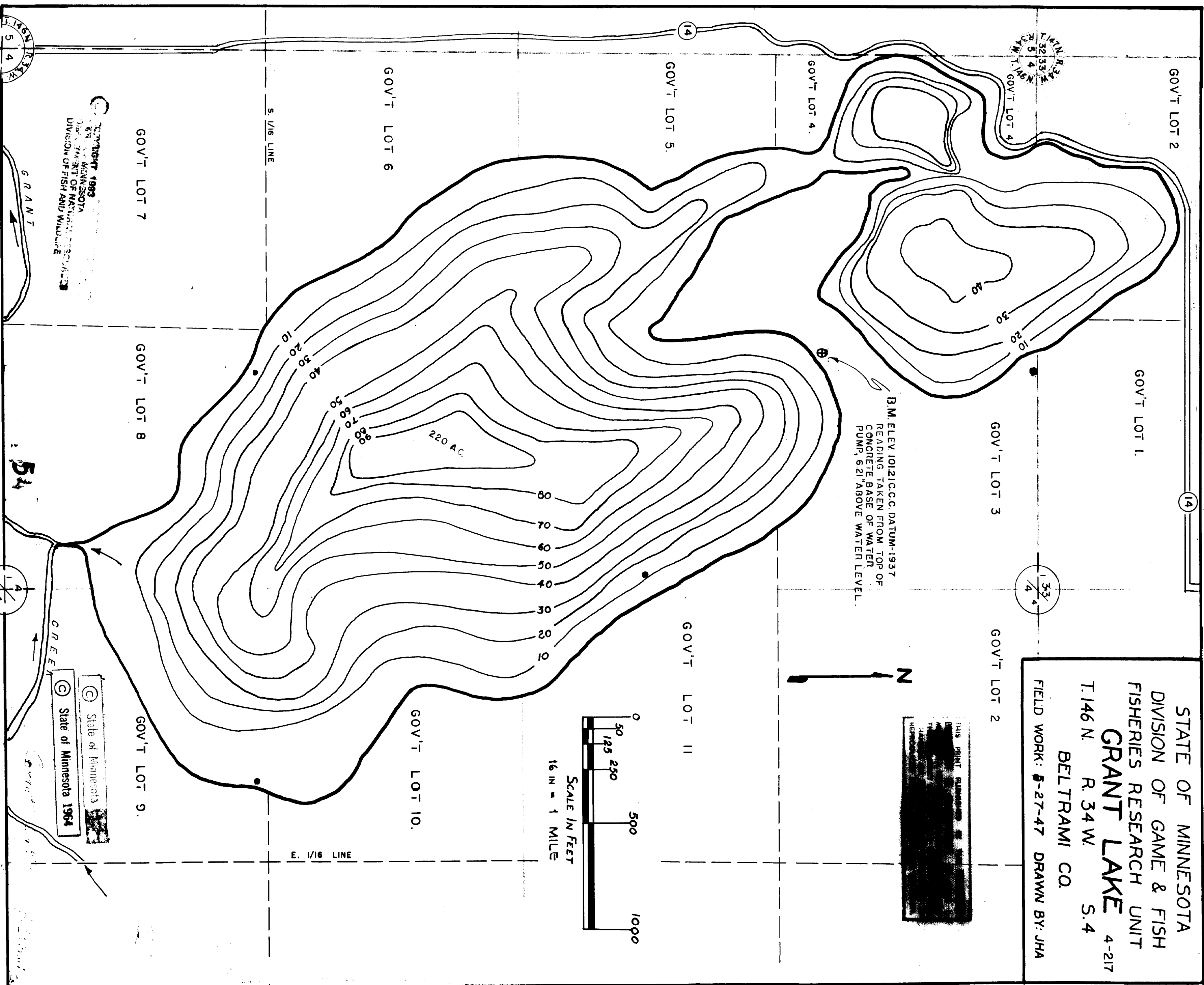
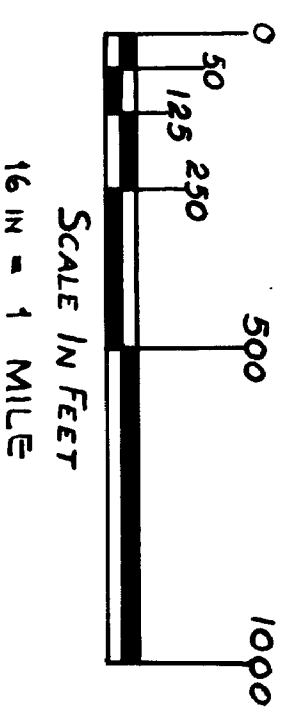

STATE OF MINNESOTA
 DIVISION OF GAME & FISH
 DIVISION OF FISH AND WILDLIFE

State of Minnesota
 State of Minnesota 1964

12-72