

**LEGEND**

- UNIMPROVED ROAD
- GRAVEL ROAD
- BITUMINOUS ROAD
- VILLAGE LIMITS
- FEDERAL WATERFOWL PRODUCTION AREA
- MARSH AREA
- WOODED OR SHRUB SWAMP
- OPEN WATER AREA
- COUNTY STATE AID HIGHWAY
- STATE HIGHWAY
- COUNTY ROAD

PLANIMETERED AREA 1,484 ACRES  
LITTORAL AREA 1,460 ACRES  
SHORELINE LENGTH 16.6 MILES

B.M. 1: SPIKE IN TWIN COTTONWOOD 25' FROM WATER'S EDGE ON SOUTHWEST SIDE OF NORTHEAST SECTION OF LAKE  
W.S. ELEV.: 4.6' BELOW B.M. 1

B.M. 2: SPIKE IN 40" D.B.H. COTTONWOOD 20' FROM WATER'S EDGE ON MIDDLE OF EAST SIDE OF NORTHEAST SECTION OF LAKE  
W.S. ELEV.: 7.9' BELOW B.M. 2

OUTLINE DRAWN FROM 1963 AERIAL PHOTO.  
NO'S.: DA-1DD-280,282,284  
DA-2DD-43,46

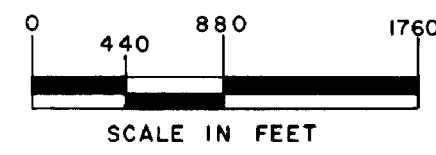

STATE OF MINNESOTA  
Department of Administration  
**Minnesota's Bookstore**  
Part of the Department of Administration  
Print Communications Division  
To order reproduced copies of  
Contour Lake Maps call:  
612/297-5000 or our  
Nationwide toll-free number  
1-800-857-3767

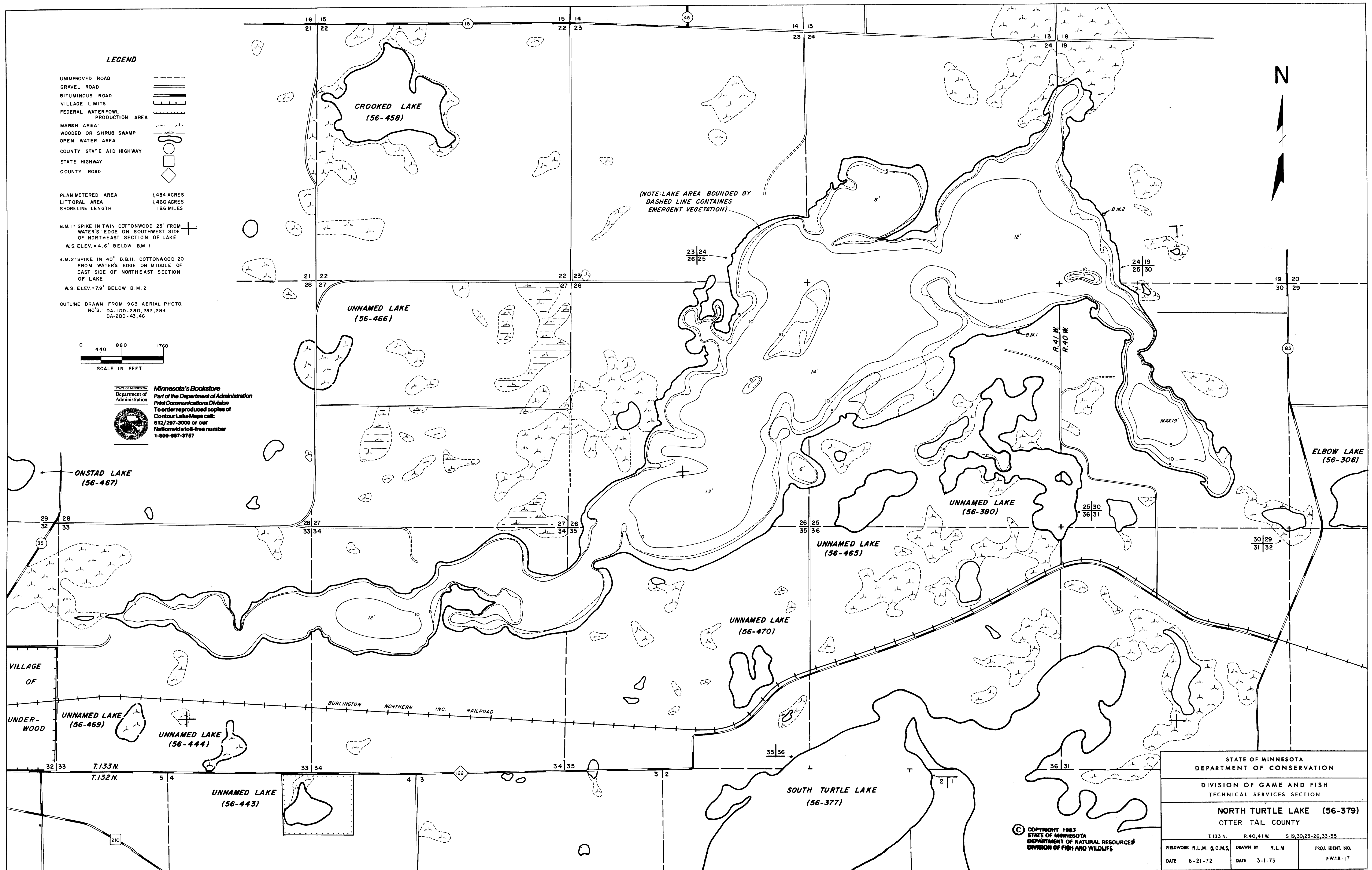

STATE OF MINNESOTA DEPARTMENT OF CONSERVATION		
DIVISION OF GAME AND FISH TECHNICAL SERVICES SECTION		
NORTH TURTLE LAKE (56-379) OTTER TAIL COUNTY		
T. 133 N. R. 40, 41 W. S. 19, 30, 23, 26, 33-35		
FIELDWORK R.L.M. G.G.M.S.	DRAWN BY R.L.M.	PROJ. IDENT. NO.
DATE 6-21-72	DATE 3-1-73	FW1R-17

© COPYRIGHT 1983  
STATE OF MINNESOTA  
DEPARTMENT OF NATURAL RESOURCES  
DIVISION OF FISH AND WILDLIFE