

SYBIL LAKE

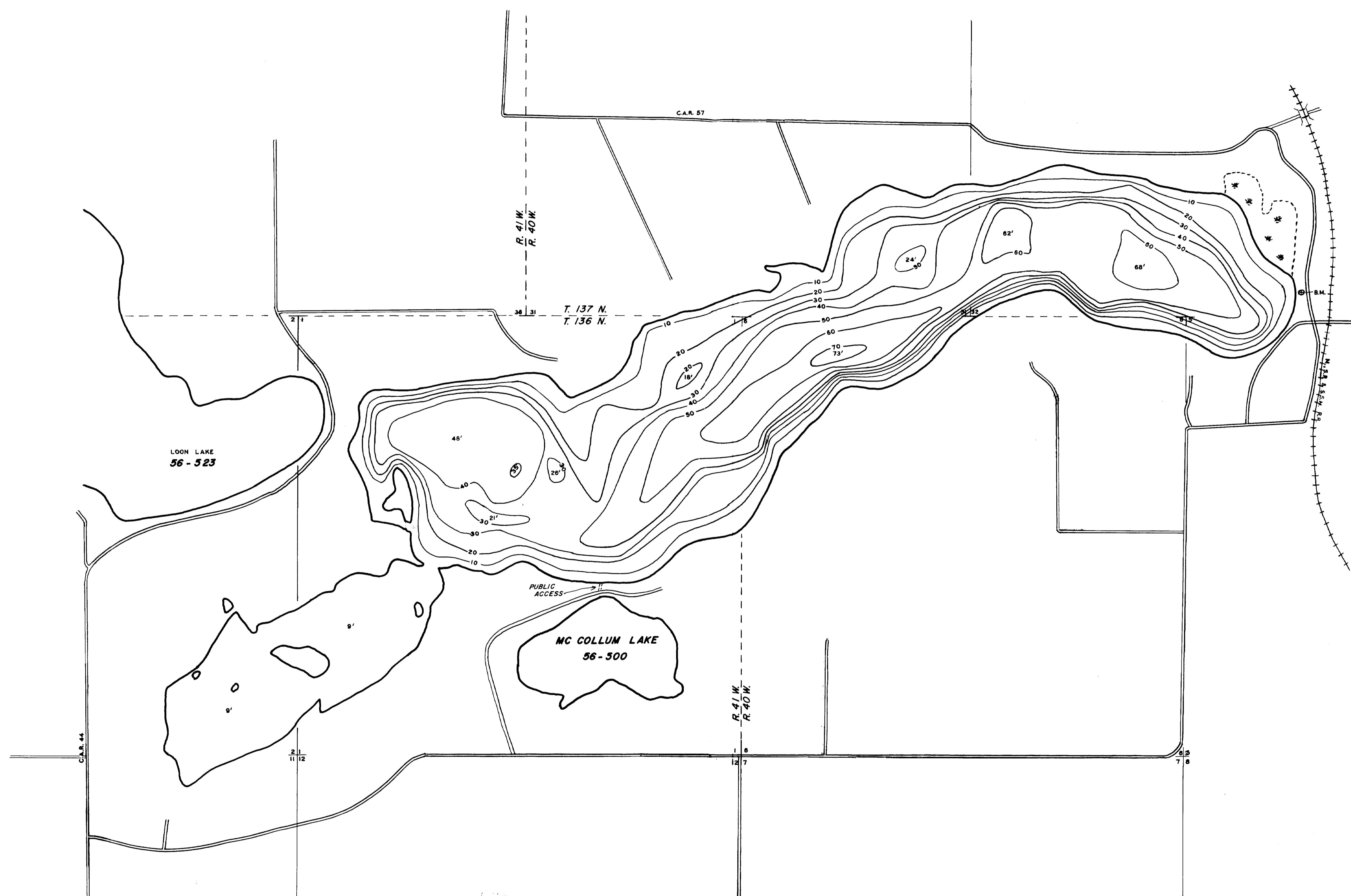

B.M. - STEEL FENCE POST AT BASE 16" BURR OAK 40' EAST OF RHODES SHADY LAKE RESORT BOAT DOCK.
W.L. - B.M. - 61'

© COPYRIGHT 1953
STATE OF MINNESOTA
DIVISION OF NATURAL RESOURCES
DIVISION OF FISH AND WILDLIFE

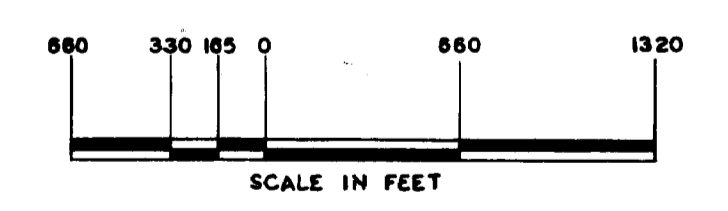

MEANDERED AREA 575 ACRES

STATE OF MINNESOTA DEPARTMENT OF CONSERVATION		
DIVISION OF GAME AND FISH BUREAU OF FISHERIES FISH RESEARCH UNIT		
SYBIL LAKE 56-387		
OTTERTAIL COUNTY		
TWP. 136-137 N.	R. 40-41 W.	SEC. 1-2-5-6-31-32
FIELDWORK DATE	H.K. 9-27-55	DRAWN BY H.K. DATE 12-29-55
		PROJ. IDENT. NO. D.J. 7-11-R

REVISED 1-11-68 D.B.D.

THIS PRINT FURNISHED BY THE MINNESOTA DEPARTMENT OF CONSERVATION, ST. PAUL, MINNESOTA. NO RESPONSIBILITY ASSUMED FOR THE ACCURACY OF THE DATA SHOWN OR FOR CHANGES OR ADDITIONS MADE BY OTHERS. IF REPRODUCED PROPER CREDIT MUST BE GIVEN.

D.O.W. FILE NO. 8-2022

OUTLINE TRACED FROM 1953 U.S.A. PHOTO

B-0232 9-147